

6E 8010.d

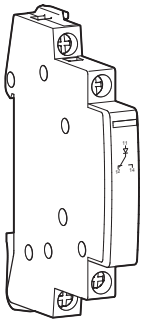

EPN050

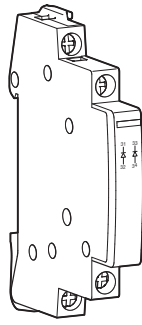
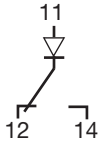

EPN052

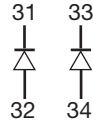

- (FR) Notice d'instructions
- (GB) User instructions
- (DE) Bedienungsanleitung
- (IT) Istruzioni d'impiego
- (ES) Instrucciones de uso
- (PT) Instruções
- (NL) Gebruiksaanwijzing
- (SE) Bruksanvisning
- (DK) Brugeruejledning
- (NO) Bruksanvisning

- (FR) Commande centralisée
- (GB) Centralized control
- (DE) Zentral Ein Aus
- (IT) Comando centralizzato
- (ES) Mando centralizado
- (PT) Comando centralizado
- (NL) Centrale bediening
- (SE) Fjärrstyrning
- (DK) Centraliseret control
- (NO) Gruppestyring

- Auxiliaire pour commande centralisées multiniveaux
- Auxiliary for multi leveled centralised control
- Zubehör für mehrstufen zentralsteuerung
- Ausiliario per comando centralizzato multilivello
- Auxiliar para mando centralizado multinevel
- Auxiliar para comando centralizado multinivel
- Hulp voor centrale bediening multiniveau
- Tillbehör för multicentral styring
- Hjaelpekontakt for multi-centralstyring
- Tilleggsblokk for sentralisert gruppestyring

EPN050		
Un	110... 230 V~	
T °C	-5 / +40 °C	
EPN052		
Un	110... 230 V~	
T °C	-5 / +40 °C	
max.	6 mm ²	10 mm ²

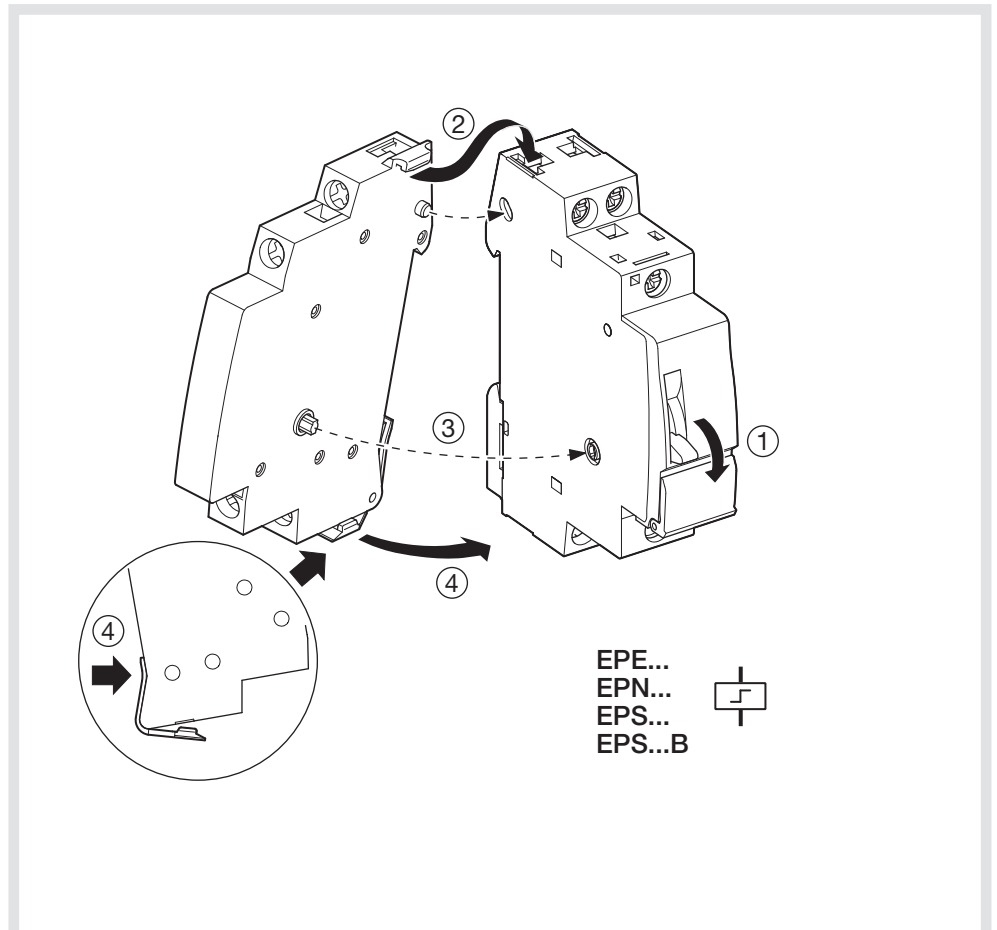

EPE...
EPN...
EPS...
EPS...B

- Ⓡ Associations télérupteur + auxiliaires
- Ⓢ Latching relay connected with auxiliaries
- Ⓓ Kombination Fernschalter und Zubehör
- Ⓡ Combinazioni tra relé passo-passo e ausiliari
- Ⓔ Asociaciones telerruptores y auxiliares

- Ⓟ Associação telerruptores e auxiliares
- Ⓝ Impulsrelais voorzien van hulpcontact
- Ⓢ Impulsrelä med tillbehör
- Ⓓ Kiprelae monteret med en hjaelpekontakt
- Ⓝ Impulsrele med tilleggsblokker

EPN050 + EPN051 + EPN053 +	EPN051 + EPN050 + EPN052 + EPN050 + EPN051 + EPN053 + EPN051 + EPN051 +	EPN052 + EPN051 + EPN050 +

