









ANCILLARIES



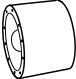



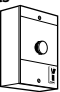

AXUS AXIAL FANS

Ancillary	Code (mm)	AX25 250	AX31 315	AX35 350	AX40 400	AX45 450	AX50 500	AX56 560	AX63 630	AX71 710	AX80 800	AX90 900	AX100 1000	AX112 1120	AX125 1250
	<b>Description</b>														
<b>Mounting Brackets</b> 	Mounting brackets supplied as pair. manufactured from heavy gauge steel.	CMB25	CMB31	CMB35	CMB40	CMB45	CMB50	CMB56	CMB63	CMB71	CMB80	CMB90	CMB100	CMB112	CMB125
<b>Matching Flange</b> 	Flange supplied as single. Manufactured from galvanised steel.	CMF25	CMF31	CMF35	CMF40	CMF45	CMF50	CMF56	CMF63	CMF71	CMF80	CMF90	CMF100	CMF112	CMF125
<b>Flexible Connector</b> 	Circular without flange. Flexible duct material is flameproof and heat resistant up to 132°C. The material is airtight and waterproof.	CFC25	CFC31	CFC35	CFC40	CFC45	CFC50	CFC56	CFC63	CFC71	CFC80	CMC90	CMC100	CMC112	CMC125
<b>Anti-vibration Mounts</b> 	Resilient rubber, for fan only.														
		<b>For further details on AV Mounts please contact Nuair</b>													
<b>Acoustic Jacket</b> 	Acoustic material laminated with 25mm foam. Complete with straps/buckles for security.														
		<b>For further details on Acoustic Jackets please contact Nuair</b>													
<b>Attenuator</b> 	Standard, Long, podded & long podded options.	CA25S CA25L CA25P CA25LP	CA31S CA31L CA31P CA31LP	CA35S CA35L CA35P CA35LP	CA40S CA40L CA40P CA40LP	CA45S CA45L CA45P CA45LP	CA50S CA50L CA50P CA50LP	CA56S CA56L CA56P CA56LP	CA63S CA63L CA63P CA63LP	CA71S CA71L CA71P CA71LP	CA80S CA80L CA80P CA80LP	CA90S CA90L CA90P CA90LP	CA100S CA100L CA100P CA100LP	CA112S CA112L CA112P CA112LP	CA125S CA125L CA125P CA125LP
<b>Guard</b> 	Manufactured in heavy gauge galvanised steel with acid zinc plated steel mesh.	CDG25	CDG31	CDG35	CDG40	CDG45	CDG50	CDG56	CDG63	CDG71	CDG80	CDG90	CDG100	CDG112	CDG125
<b>Inlet Cone</b> 	manufactured in heavy gauge galvanised steel with a single bolted flange.	CIC25	CIC31	CIC35	CIC40	CIC45	CIC50	CIC56	CIC63	CIC71	CIC80	CIC90	CIC100	CIC112	CIC125
<b>Backdraft Damper</b> 	Gravity operated damper manufactured from heavy gauge galvanised steel with pair of bolted flanges.	CBD25	CBD31	CBD35	CBD40	CBD45	CBD50	CBD56	CBD63	CBD71	CBD80	CBD90	CBD100	CBD112	CBD125
<b>Controls</b> 	Choice of Inverter, electronic or transformer speed controls available.														
		<b>For further details on Controls please contact Nuair</b>													

See page 310 for ancillaries

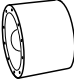
ANCILLARIES

BIFURCATED AXIAL FANS

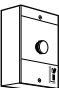
Ancillary	Code (mm)	AXB31 315	AXB35 350	AXB40 400	AXB45 450	AXB50 500	AXB56 560	AXB63 630	AXB71 710	AXB80 800	AXB90 900	AXB100 1000
Description												
<b>Mounting Brackets</b> 	Mounting brackets supplied as pair. manufactured from heavy gauge steel.	CMB31	CMB35	CMB40	CMB45	CMB50	CMB56	CMB63	CMB71	CMB80	CMB90	CMB100
<b>Matching Flange</b> 	Flange supplied as single. Manufactured from galvanised steel.	CMF31	CMF35	CMF40	CMF45	CMF50	CMF56	CMF63	CMF71	CMF80	CMF90	CMF100
<b>Flexible Connector</b> 	Circular without flange. Flexible duct material is flameproof and heat resistant up to 132°C. The material is airtight and waterproof.	CFC31	CFC35	CFC40	CFC45	CFC50	CFC56	CFC63	CFC71	CFC80	CFC90	CFC100
<b>Anti-vibration Mounts</b> 	Resilient rubber, for fan only.	For further details on AV Mounts please contact Nuairé										
<b>Attenuator</b> 	Standard, Long, podded & long podded options. CA31LP CA35LP CA40LP CA45LP	CA31S CA31L CA31P CA35LP	CA35S CA35L CA35P CA40LP	CA40S CA40L CA40P CA45LP	CA45S CA45L CA45P CA50LP	CA50S CA50L CA50P CA56LP	CA56S CA56L CA56P CA63LP	CA63S CA63L CA63P CA71LP	CA71S CA71L CA71P CA80LP	CA80S CA80L CA80P CA90LP	CA90S CA90L CA90P CA100LP	CA100S CA100L CA100P
<b>Guard</b> 	Manufactured in heavy gauge galvanised steel with acid zinc plated steel mesh.	CDG31	CDG35	CDG40	CDG45	CDG50	CDG56	CDG63	CDG71	CDG80	CDG90	CDG100
<b>Inlet Cone</b> 	manufactured in heavy gauge galvanised steel with a single bolted flange.	CIC31	CIC35	CIC40	CIC45	CIC50	CIC56	CIC63	CIC71	CIC80	CIC90	CIC100
<b>Backdraft Damper</b> 	Gravity operated damper manufactured from heavy gauge galvanised steel with pair of bolted flanges.	CBD31	CBD35	CBD40	CBD45	CBD50	CBD56	CBD63	CBD71	CBD80	CBD90	CBD100
<b>Controls</b> 	Choice of Inverter.	For further details on Controls please contact Nuairé										

See page 310 for ancillaries

ANCILLARIES FOR AXIAL FANS - DETAILS

**Mounting Brackets**

The AXUS mounting brackets are manufactured from heavy gauge galvanised steel and are supplied in pairs. (See table 1 for dimensions).

**Typical Code: CMB100** (100 = fan diameter in cm).

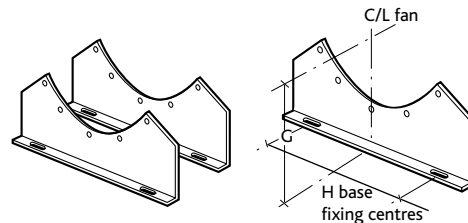

**Matching Flange (Single)**

Manufactured from galvanised steel matching flanges are supplied individually. (See table 1 for dimensions and weights).

**Typical code: CMF100** (100 = fan diameter in cm).

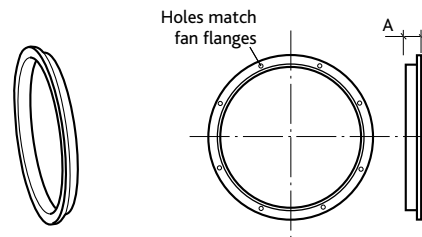

**Flexible Connector (Single)**

Circular without flanges. Flexible duct material is flameproof and resistant to heat up to 132°C/400°C, chemicals, ozone, oil and grease. The material is airtight, waterproof and tested to BS476 Part 7.

(See table 1 for dimensions and weights).

(Supplied complete with fixing straps).

**Typical Code: CFC100** (100 = fan diameter in cm) - 132°C.

CFCH100 (100 = fan diameter in cm) - 400°C.

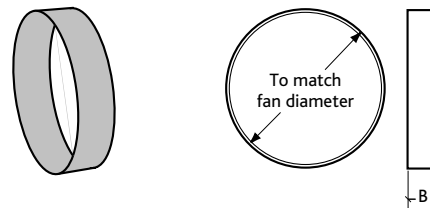

**Guard (Single)**

Manufactured from heavy gauge galvanised steel and acid zinc plated steel mesh.

(See table 1 for dimensions and weights). Standard Accessory Losses (k).

Flat type • Finger guard 0.4.

**Typical Code: CGD100** (100 = fan diameter in cm)

Pressure Drop (Pa) = 0.6 x k x Velocity (m/s).

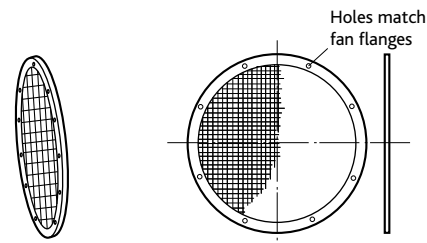

**Inlet Cone (Single)**

Manufactured in heavy gauge galvanised steel with a single bolted flange.

(See table 1 for dimensions and weights).

Standard Accessory Losses (k).

Low loss • inlet cone 0.38.

**Typical Code: CIC100** (100 = fan diameter in cm)

Pressure Drop (Pa) = 0.6 x k x Velocity (m/s).

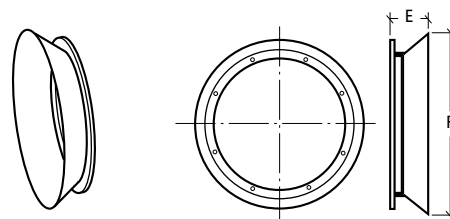

**Backdraught Damper (Single)**

Gravity operated backdraught damper, manufactured from heavy gauge galvanised steel with a pair of bolted flanges.

(See table 1 for dimensions and weights).

Standard Accessory Losses (k) (Air stream operated) 0.4

**Typical Code: CBD100** (100 = fan diameter in cm) - 132°C

(For horizontal mounting only).

Pressure Drop (Pa) = 0.6 x k x Velocity (m/s).

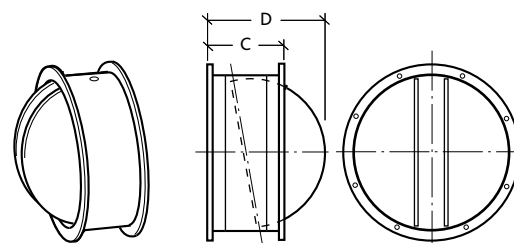

ANCILLARIES FOR AXIAL FANS - DETAILS CONT.

TABLE 1 DIMENSIONS (mm) & WEIGHTS

Fan Ø	A	B	C	D	E	F	G	H	Inlet Guard Weight Kg	B/draught cone Weight Kg	Damper Weight Kg
250mm	65	150	350	350	85	355	170	150	0.4	1.5	6
310mm	65	150	350	350	85	405	210	220	0.5	2	7.5
350mm	65	150	350	350	90	460	240	250	1	2	9
400mm	65	150	350	350	90	520	270	290	1.5	3	11
450mm	65	150	350	350	90	580	300	330	1.7	4	14
500mm	65	150	350	350	100	650	340	380	2.3	5	16.5
560mm	65	150	350	360	100	700	370	420	2.8	6	20
630mm	65	150	350	400	130	830	430	500	3.2	9	22.5
710mm	65	150	350	440	170	920	470	540	3.7	11	27.5
800mm	65	150	350	470	200	1050	540	590	4	13	35
900mm	65	150	350	520	220	1180	600	670	7	20	55
1000mm	65	150	350	580	230	1300	670	770	7	23	66.5
1120mm	65	150	350	920	260	1450	750	870	8	32	80
1250mm	65	150	350	985	300	1600	830	920	8	40	88

Anti Vibration Mountings

Supplied as a set of 4. To select match isolated assembly weight to max Supporting weight shown on right.

Typical code: NAV1 - Resilient Rubber NAV49 - Spring type.

DIMENSIONS (mm) & WEIGHTS

Code	Type	B	C	Max Supporting Weight Kg
NAV1	Rubber	30	50	20.0
NAV2	Rubber	40	75	80.0
NAV3	Rubber	40	75	180.0
NAV4	Rubber	40	75	260.0
NAV5	Rubber	40	75	130.0
NAV6	Rubber	50	100	320.0
NAV49	Spring	77	76	400.0
NAV50	Spring	77	76	480.0
NAV51	Spring	77	76	520.0
NAV52	Spring	87	127	600.0
NAV53	Spring	87	127	700.0
NAV54	Spring	87	127	800.0
NAV55	Spring	87	127	950.0
NAV56	Spring	87	127	1110.0
NAV57	Spring	87	127	1270.0
NAV58	Spring	87	127	1430.0

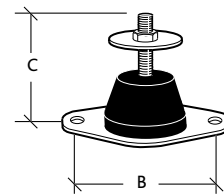

NAV1-5  
Resilient Rubber

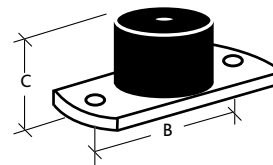

NAV6  
Resilient Rubber

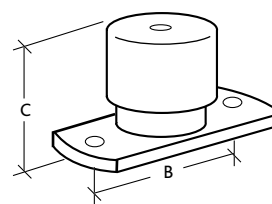

NAV49-58  
Spring