

## Capacities

**Note.** Capacities shown are based on discharge at saturation temperature. When discharging sub-cooled condensate the air vent provides extra capacity. Under start up conditions the thermostatic air vent will be open, and will provide additional condensate capacity to the main valve assembly. On 4.5 bar units this will provide a minimum of 50% increased capacity above the hot condensate figures shown. On 10 and 14 bar units this will be a minimum increase of 100% on the published capacity.

## Available certification

This product is available with material certification to EN 10204 2.2 as standard.

## How to specify

½" Spirax Sarco FT14 — 4.5 (R-L) Steam Trap with screwed BSP connections (right to left) and integral air vent. Maintainable in line. Modification of flow orientation can be changed on site.

## Installation

The trap must be fitted with the float arm in a horizontal plane so that it rises and falls vertically. Therefore the arrow on nameplate must point downwards.

Traps can be supplied with vertical connections with the flow from top inlet to bottom or horizontal connections with the flow right to left or left to right. **Unless specified, a right to left flow will be supplied. (R-L)**

The connection orientation can be changed on site by undoing the four cover bolts and moving the cover to the preferred flow orientation. A new cover gasket must always be fitted.

The FT 14-C is supplied with the steam lock release (SLR) set in the bleed position. **The unit should be screwed clockwise to close.**

## Spare parts

The spare parts available are shown in heavy outline. Parts drawn in broken line are not supplied as spares.

### AVAILABLE SPARE

Main Valve Assembly with Float	5,6,8,7 (2 off),12,3,14, 16 (1" only)
Air Vent Assembly	9,3
Steam Lock Release and Air Vent Assembly	10,11,6,9,3
Cover Gasket (Pkt of 3)	3

## How to Order

Always order spares by using the description given in the column headed Available Spare and stating the size and type of trap.

Example: 1 — Main valve Assembly for ½" Spirax Sarco FT 14 Steam Trap. Pressure range 4.5, 10 or 14 bar.

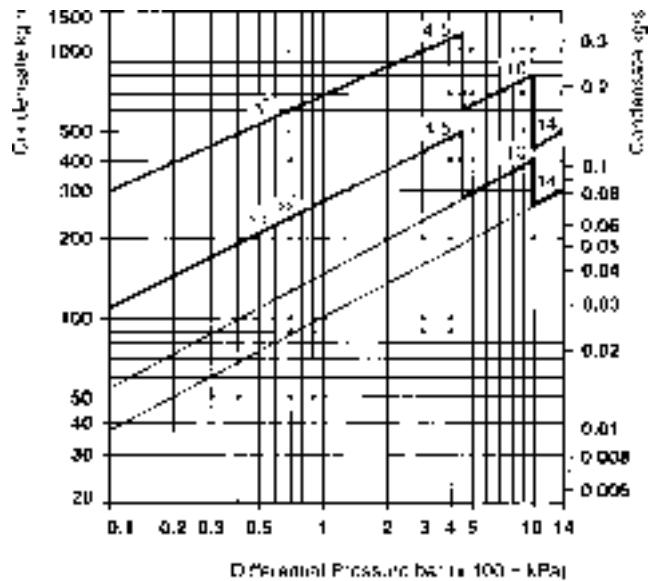
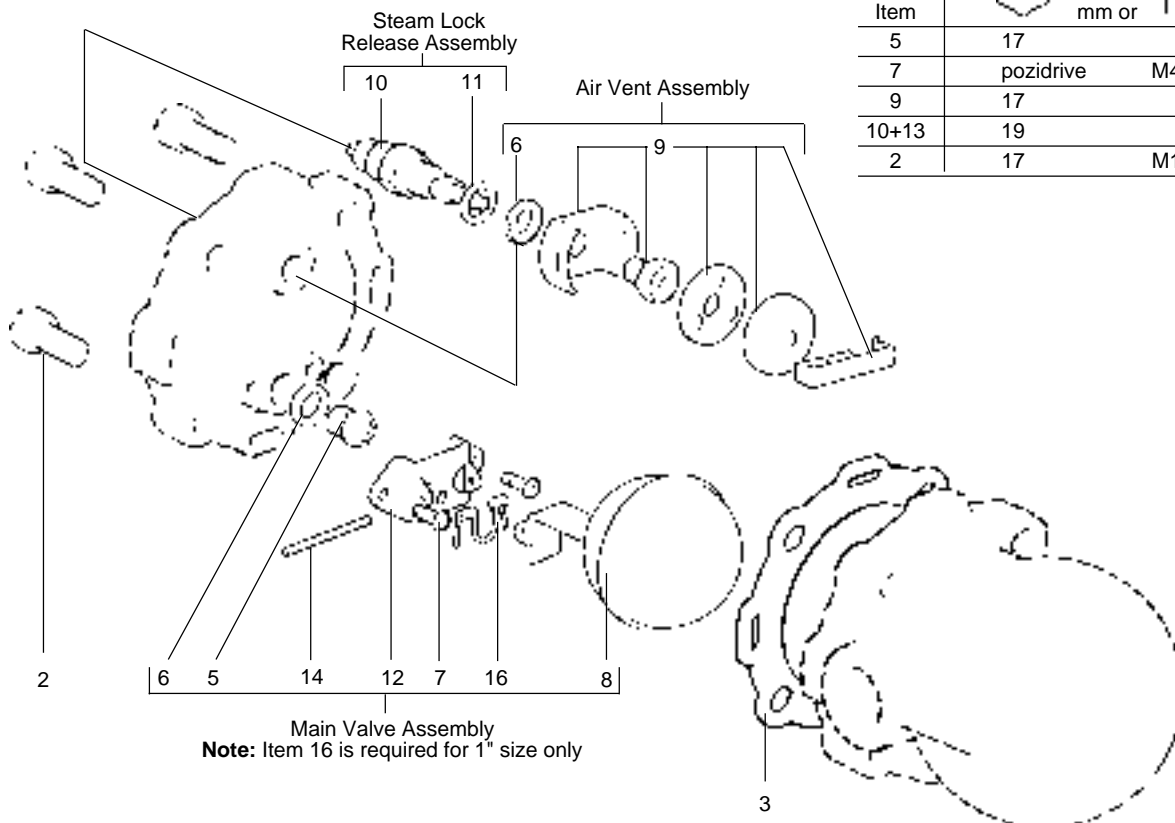

## Maintenance

**Before undertaking any maintenance on the trap it must be isolated from both the supply and return lines and any pressure allowed to safely normalise to atmosphere. The trap assembly should then be allowed to cool. When reassembling it is advisable to make sure that all joint faces are clean.**

### How to Fit Main Valve Assembly

Undo cover bolts and lift off cover. Remove complete float assembly by undoing the two screws. Remove main valve seat and replace with a new one supplied with new gasket. A valve spring (Item 16) is fitted to 1" traps only. Fit complete new float assembly by tightening the assembly set screws. Refit cover using new gasket.

### How to Fit Air Vent Assembly

Remove spring clip, capsule and spacer plate. Unscrew seat. Fit new gasket, new seat and frame. Assemble spacer plate, fit capsule and clip. Align complete air vent horizontally so that the frame clears the cover.

### Recommended tightening torques

Item	Hex Bolt	mm or	Hex Nut	Nm
5	17			50-55
7	pozidrive		M4x6	2.5-3
9	17			50-55
10+13	19			35-40
2	17		M10x30	40-45