

Nr. 6110

ISO reducer fitting with external thread

with external thread EN 10226-1, special dimensions



Standards

ISO-socket:

- For PE-pipes according to EN 12201 and DIN 8074 | to PN 16; up to 30° C medium temperature, also for vacuum (with support liner)
- restraint acc. to DIN 8076 T1/T3
- with special clamp for PVC pipes acc. to EN 1452-2
- External thread EN 10226-1

Construction features

ISO-socket:

- The function of the ISO pipe fitting is clear and simple: the O-ring made of highly elastic elastomer seals even when depressurized due to its pretension on the pipe.
- As the water pressure and pipe tension increase, the sealing and grip rings are compressed further into the conical chamber, thus increasing the sealing and gripping effect
- The gripping and sealing functions only act on the outer diameter of the pipe; therefore only one fitting is required for all pressure ratings up to PN 16
- The joint is flexible; the fitting can be turned on the pipe and disassembled on demand without affecting the grip or seal. The installation of the fitting is quick and simple.

All ISO pipe fittings can also be supplied for PVC pipes with a specialised grip ring at extra cost.

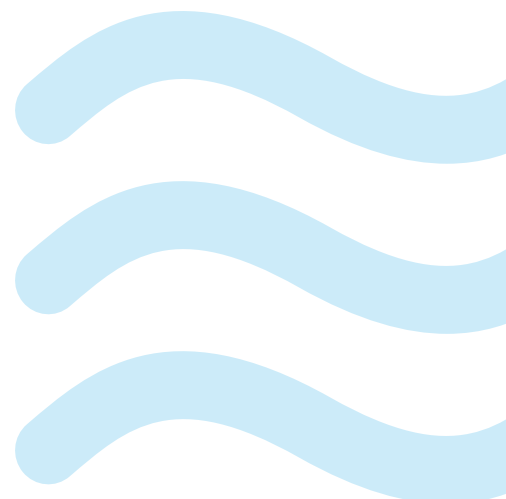

Nr. 6110

ISO reducer fitting with external thread

with external thread EN 10226-1, special dimensions

Materials

Body	<ul style="list-style-type: none"> • Ductile iron: EN-GJS-400-15 according to EN 1563 • Epoxy powder coated inside and outside: According to DIN 3476-1 in due consideration of the RAL-GZ 662 quality and testing requirements: <ul style="list-style-type: none"> - coating thickness: min. 250 μm - zero porosity: min. 3000 V spark test - adhesion: min. 16 N/mm²
Grip ring	POM (Polyoxymethylene)
O-ring gasket	Elastomer

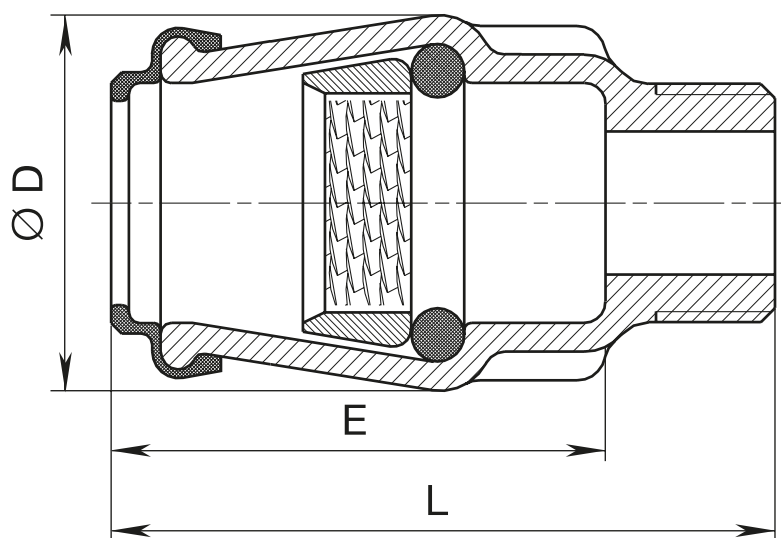

DN	PN	Weight	L	E	Ød	Ø pipe	Thread	
D 25-1"	PN16	0.28	83,5	58,5	50	25	1"	
D 32-1 1/4"	PN16	0.39	96	70	53	32	1 1/4"	
		0.68	112		62		2"	
		0.56	96		53		1 1/2"	
D 40-1"	PN16	0.65	112	84	65	40	1"	
		0.64					112	1 1/2"
		0.72					113	2"
D 50-1 1/4"	PN16	0.9	130	101	76	50	1 1/4"	

Nr. 6110

ISO reducer fitting with external thread

with external thread EN 10226-1, special dimensions

DN	PN	Weight	L	E	Ød	Ø pipe	Thread
		0.95					2"
D 63-1 1/2"	PN16	1.45	148	114	93	63	1 1/2"
		1.51					1 1/4"
D 75-2"	PN16	2.35	152	109	111	75	2"

All illustrations, technical data, dimensions (in mm) and weights (all weights specified in kg) are non-binding. Subject to changes and printing errors