

Philips EFix TCS260

Installation instructions

Instructions de montage
Installation instructions
Montageanweisung
Montagevoorschrift

Istruzioni di montaggio
Instrucciones de montaje
Montážní návod
Montážny návod

Szerelési útmutató
Instrukcja montażu

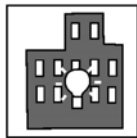

IP20



~220V
~240V

850°C

CE

TCS260

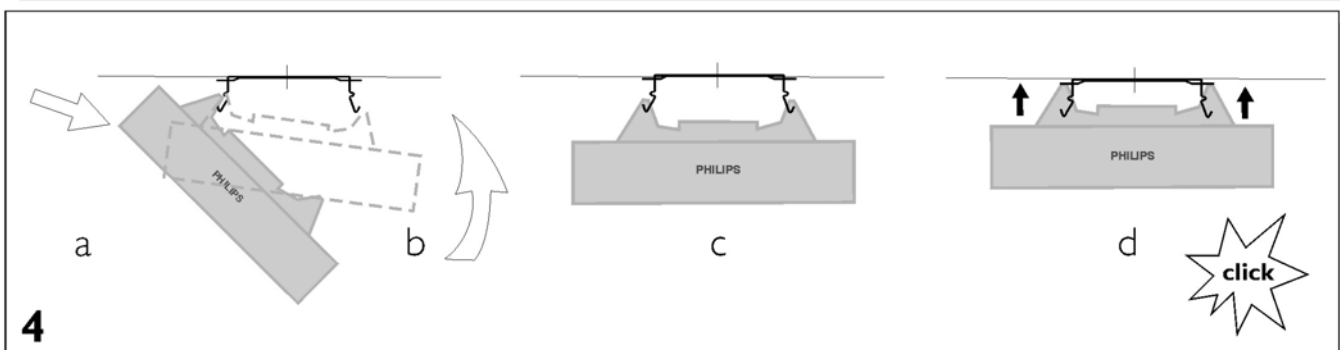
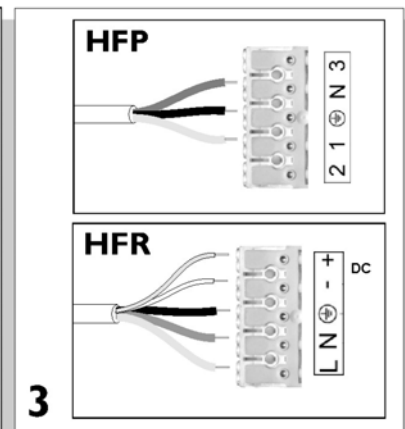
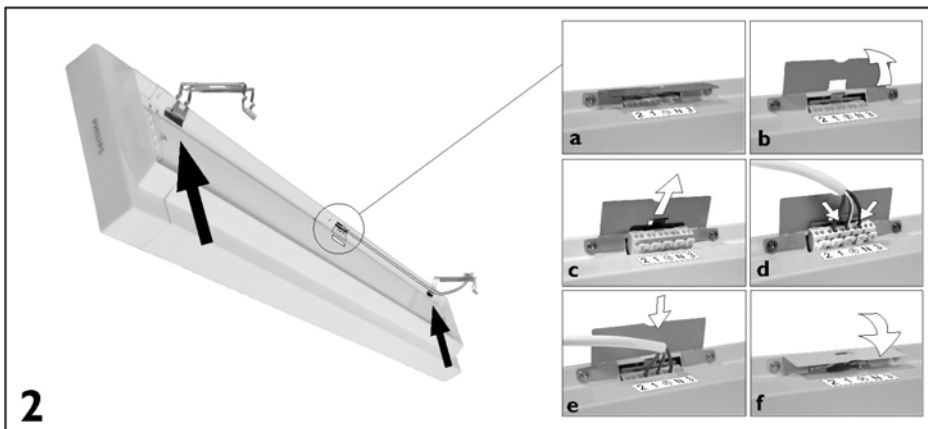
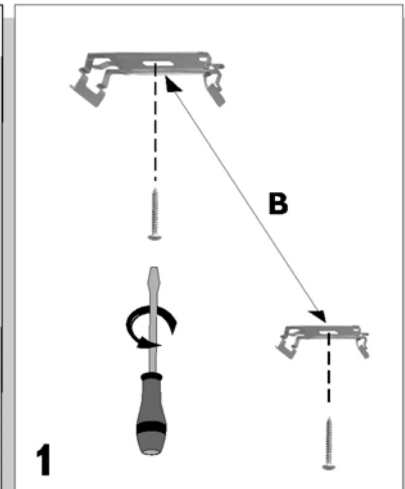
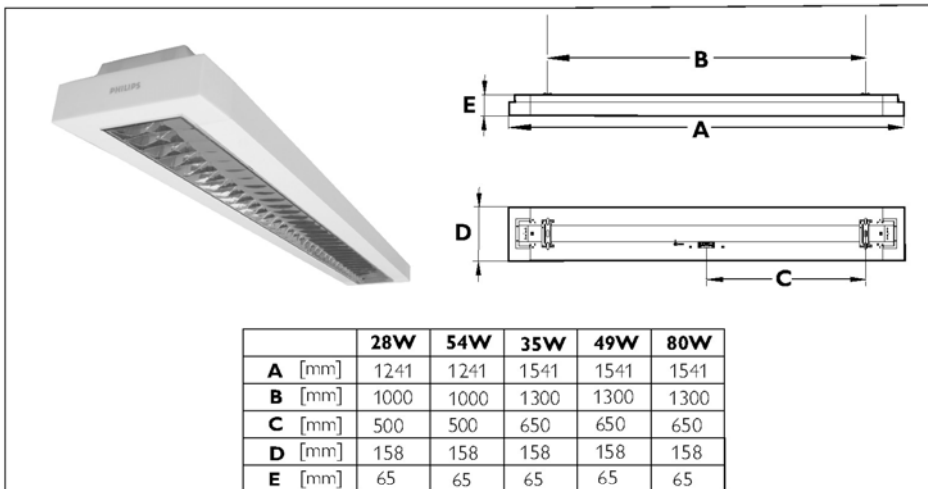

TCS260 + ZPS260 SME

B

max 1500 [mm]

	28W	54W	35W	49W	80W
B [mm]	1000	1000	1300	1300	1300

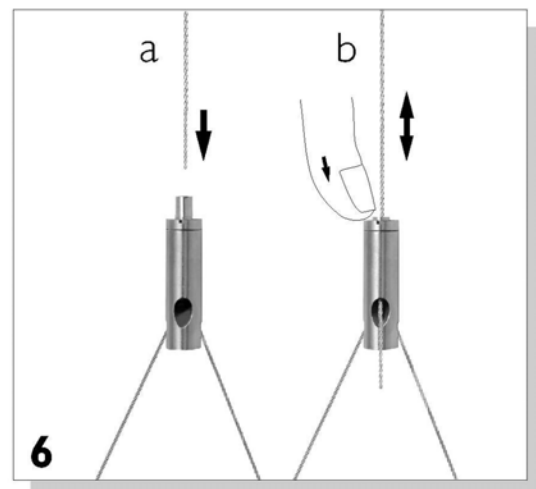
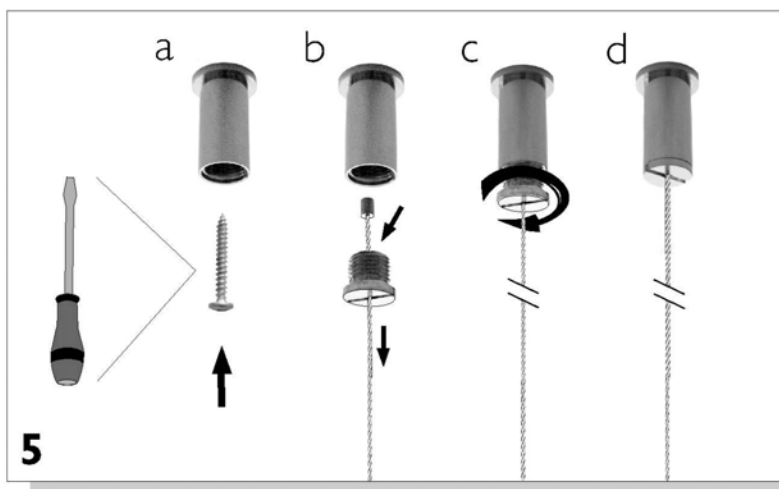
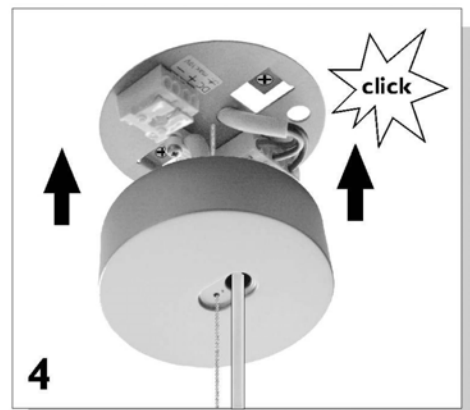
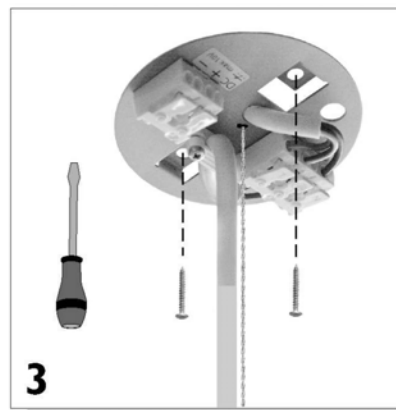
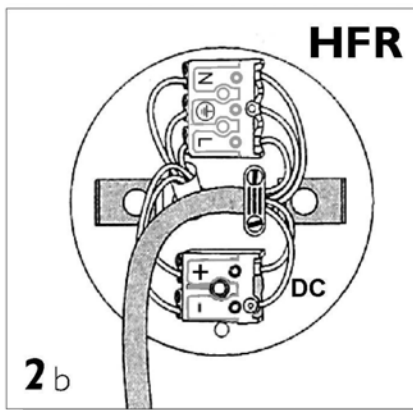
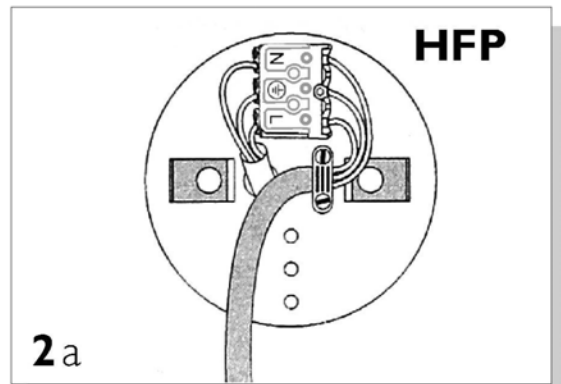
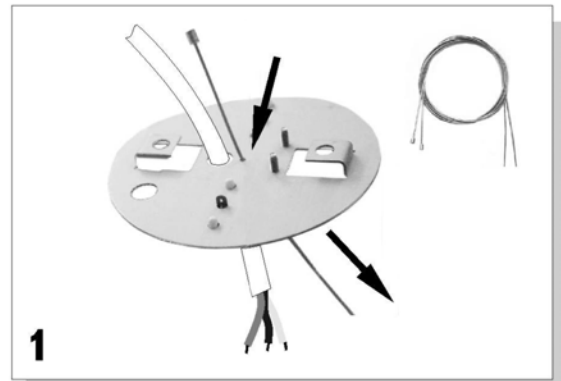



7

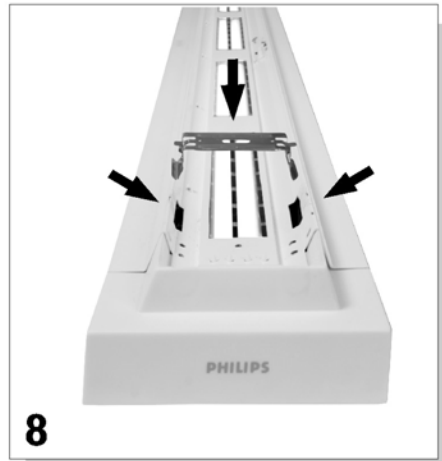
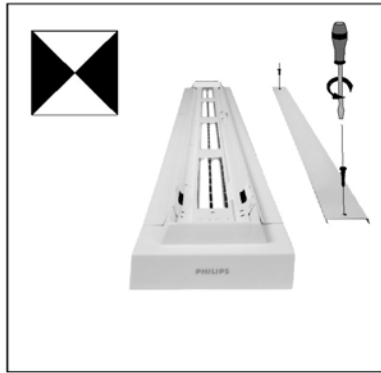

8

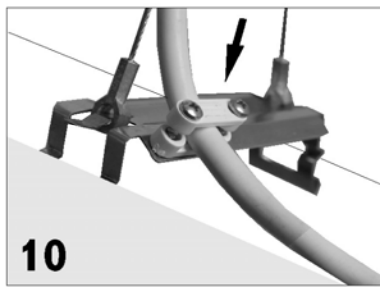
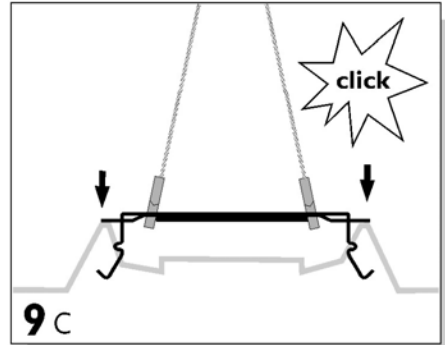
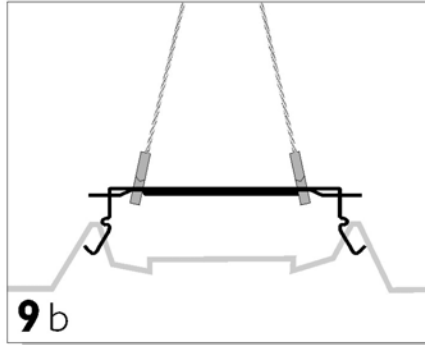
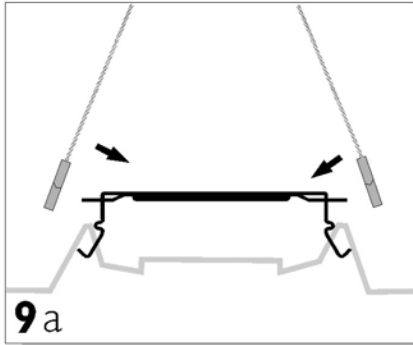

10

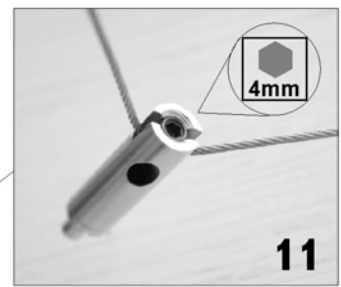

11



12

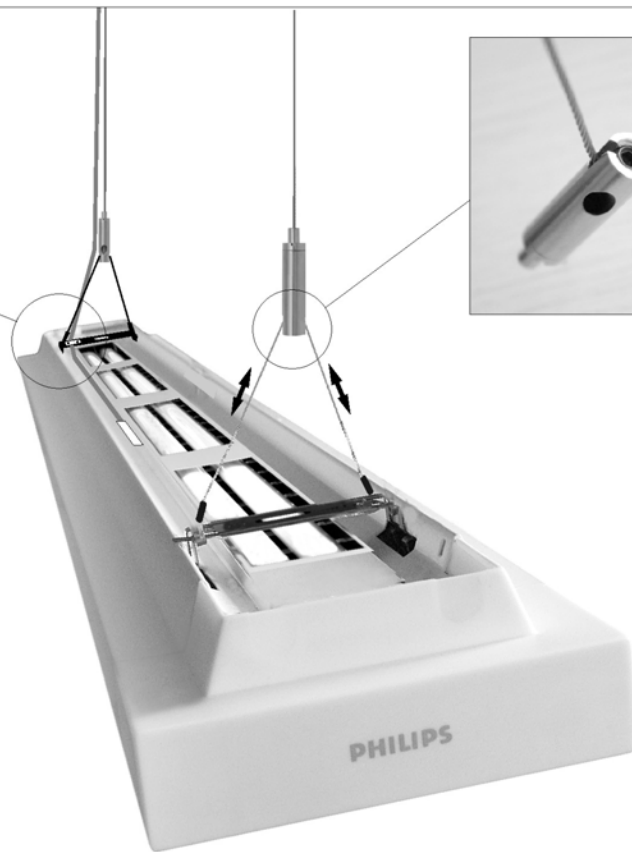

TCS260

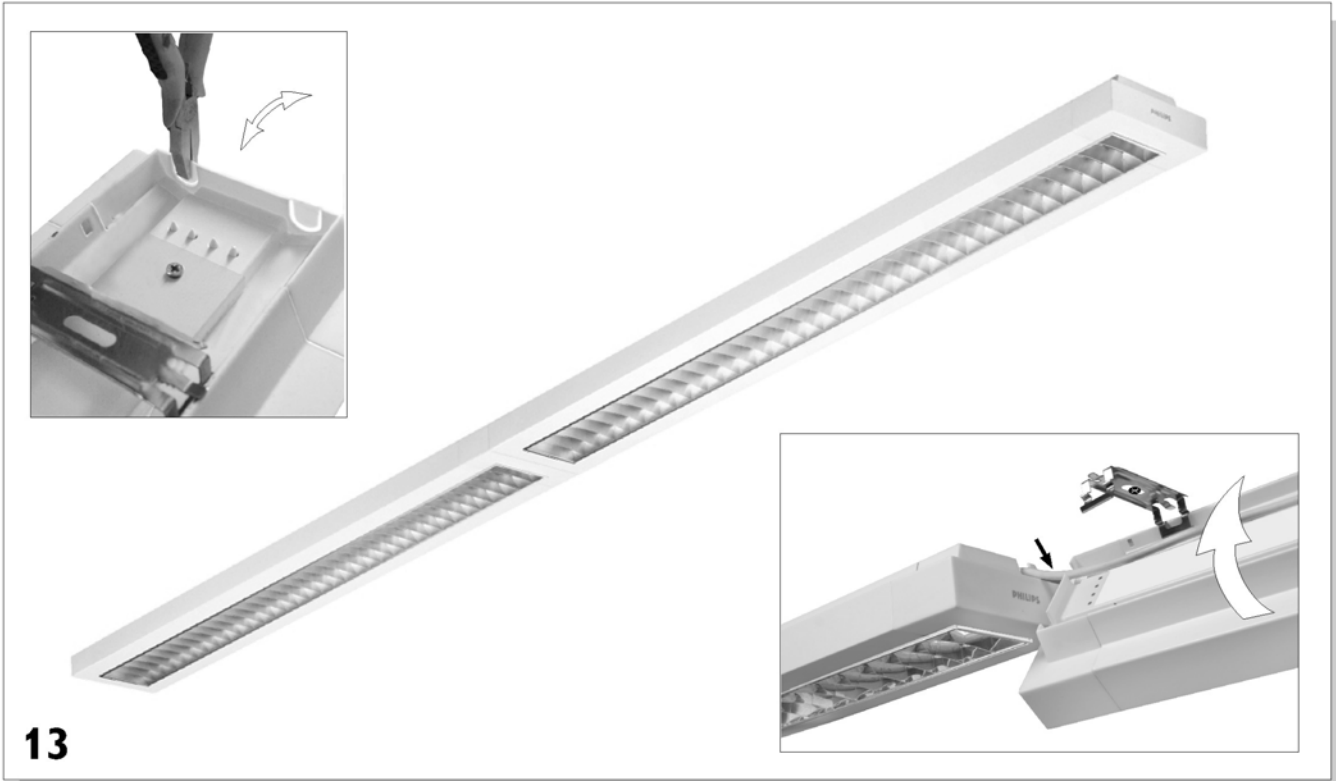

service

C6/D6/M6/M2

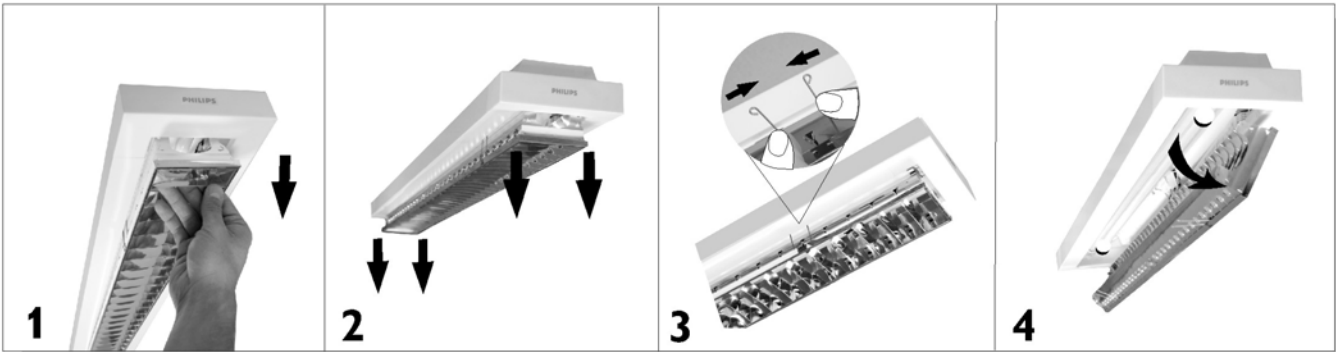

A



PHILIPS