

Talbot Pushfit fittings

Technical data

Working pressure: 16 bar

Test pressure: 24 bar

The pressures stated above apply with water temperatures up to 20°C

Temperature: Up to 40°

Material Specification

Description	Material
Bodies	
Plastic Fittings	Acetal/Polypropylene
Gunmetal Fittings	Cast Gunmetal
Brass Fittings	DZR Brass
Aluminium Fittings	Cast Aluminium
Components	
Grip Ring	Acetal
'O' Ring	EPDM BS EN 681
Liner	Polypropylene/Acetal
Reinforcing Ring	Stainless Steel Grade 304

Atlantic Plastics

Brackla Industrial Estate

Bridgend, Wales CF31 2AX

United Kingdom

PHONE +44 (0)845 077 9797

FAX +44 (0)845 077 9798

E-MAIL enquiries@atplas.co.uk

INTERNET www.atplas.co.uk



Talbot Pushfit

Installation Guide for Talbot Pushfit fittings

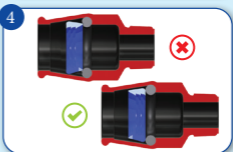
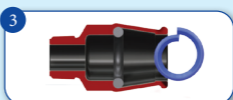
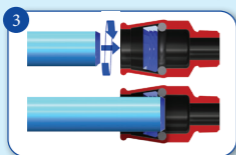
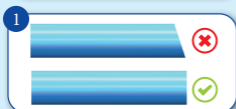

1. Ensure pipe is cut at 90°
2. Insert the Liner into the pipe
3. Push the pipe fully into the fitting with a slight twist Ensure that the pipe passes two points of resistance.
4. Pipe should be fully seated

All fittings should be witness marked with the depth if insertion to ensure correct installation.

The O-rings come pre lubricated however if extra lubrication is required please use an approved potable water lubricant.

1. Slide the extractor tools home and withdraw the pipe.
2. Extract the grip ring with a screwdriver. Do not re-use the grip ring. Extract and inspect the 'O' ring. Replace it if damaged.
3. Insert a new grip ring forming a figure '6' and pressing it in.
4. Ensure that the grip ring is inserted the correct way round.