



**GP series**

**GP 12400 12V 40AH**



**Valve Regulated Lead Acid Battery**

Maintenance-Free Sealed Lead Acid Battery.  
Absorbent Glass Mat (AGM) technology for efficient gas recombination of up to 99%.

**Design for Standby Power Applications**

<p><b>【Design Life】</b> Up to 5 Years in Standby Service at 25°C Eurobat (20°C) : 3-5 years, Standard Commercial</p> <p><b>【Operating Temperature Range】</b> Nominal Operating Temperature : 25°C (77°F) Discharge : -15°C ~ 50°C (5°F~122°F) Charge: -15°C ~ 40°C (5°F~104°F) Storage: -15°C ~ 40°C (5°F~104°F)</p>	<p><b>【Float Charging Voltage】</b> 13.5 ~ 13.8 VDC/Unit at 25°C (77°F)</p> <p><b>【Equalization Charging Voltage】</b> 14.4 ~ 15.0 VDC/Unit at 25°C (77°F)</p> <p><b>【Self Discharge】</b> Less than 10% after 90 days, can be stored up to 6 months at 25°C (77°F); Fully recharging is required before usage, and charged sooner if stored at higher temperature than 25°C (77°F).</p>
--	---

Specification		Design according with IEC 61056-1/2: 2012	
Nominal Voltage	12V (6 cells per unit)		
Nominal Capacity	40 Ah @20hr-rate to 1.75V per cell @25°C (77°F)		
Weight	Approx. 12.63 Kg (27.84 lbs)		
Maximum Discharge Current	400A (5sec)		
Internal Resistance	Approx. 8.5mΩ		
Short Circuit Current	1012A		
Maximum Charge Current	12.00A		
Terminal types	I2 thread lead alloy terminal to accept M6 bolt		
Terminal hardware Torque	59 Kgf-cm / 51 Lbf-in / 5.73 N-m		
Container Material	ABS (UL 94-HB) & Flame Retardant (94-V0) available upon request		
Dimensions	Length (L)	197.0±2.0 mm	7.76±0.08 inch
	Width (W)	165.0±2.0 mm	6.50±0.08 inch
	Container Height (h)	170.4±2.0 mm	6.71±0.08 inch
	Overall Height (H)	170.4±2.0 mm	6.71±0.08 inch

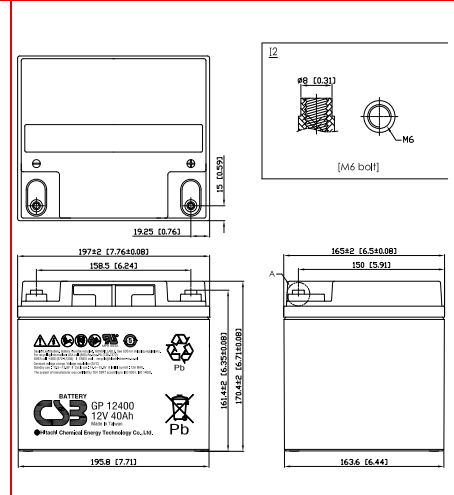

**Constant Current Discharge Characteristics Unit: A (25°C, 77°F)**

F.V/Time	5 MIN	10MIN	15MIN	30MIN	60MIN	90MIN	2HR	3HR	5HR	8HR	10HR	20HR
1.60V	176	113	85.0	51.8	30.6	22.2	17.7	12.6	8.01	5.25	4.28	2.31
1.67V	157	105	81.0	50.8	30.3	22.1	17.6	12.5	7.98	5.19	4.19	2.24
1.70V	149	101	78.7	50.1	30.2	21.9	17.5	12.4	7.96	5.17	4.16	2.20
1.75V	135	95.0	75.5	49.0	30.0	21.8	17.4	12.3	7.93	5.10	4.09	2.15
1.80V	121	88.3	71.7	47.6	29.8	21.7	17.3	12.2	7.88	5.03	4.03	2.10
1.85V	107	81.7	67.8	46.2	29.4	21.5	17.2	12.1	7.85	4.96	3.96	2.04

**Constant Power Discharge Characteristics Unit: W (25°C, 77°F)**

F.V/Time	5MIN	10MIN	15MIN	30MIN	60MIN	90MIN	2HR	3HR	5HR	8HR	10HR	20HR
1.60V	2110	1350	1020	622	367	266	212	151	96.1	63.0	51.3	27.7
1.67V	1886	1259	972	606	364	264	211	150	95.7	62.3	50.4	27.0
1.70V	1790	1214	945	600	363	263	210	149	95.5	62.0	50.0	26.5
1.75V	1620	1140	902	585	360	262	209	148	95.2	61.2	49.2	25.8
1.80V	1450	1060	860	571	357	260	208	147	94.8	60.4	48.3	25.1
1.85V	1280	980	814	555	353	258	207	146	94.2	59.6	47.5	24.5

Please refer to the official site for the latest rating confirmation. URL: [www.csb-battery.com](http://www.csb-battery.com) Issued: 170830

**Sales Offices**  
**日立化成能源科技股份有限公司**  
 Hitachi Chemical Energy Technology Co., Ltd.

**BUSINESS HEADQUARTERS**  
 Tel: +886-2-2880-5600  
 Fax: +866-2-2888-3300

**USA OFFICE**  
 Tel: +1-817-244-7777 / 1-(800)3-CSB-USA (272872)  
 Fax: +1-817-244-4445

**SHENZHEN OFFICE (CHINA)**  
 Tel: +86-755-8831-6488, 8831-6775  
 Fax: +86-755-8831-6075

**EUROPE (EMEA) OFFICE**  
 Tel: +31(0)180-418-140  
 Fax: +31(0)180-418-327

**SHANGHAI OFFICE (CHINA)**  
 Tel: +86-21-5046-1622, 5046-0833  
 Fax: +86-21-5046-1046

**TAIPEI OFFICE**  
 Tel: +886-2-2880-5600  
 Fax: +866-2-2888-3300

**BEIJING OFFICE (CHINA)**  
 Tel: +86-10-5820-5336, 5820-5338  
 Fax: +86-10-5820-3053

