

GinoLED RGB Diffuse TOP Flex

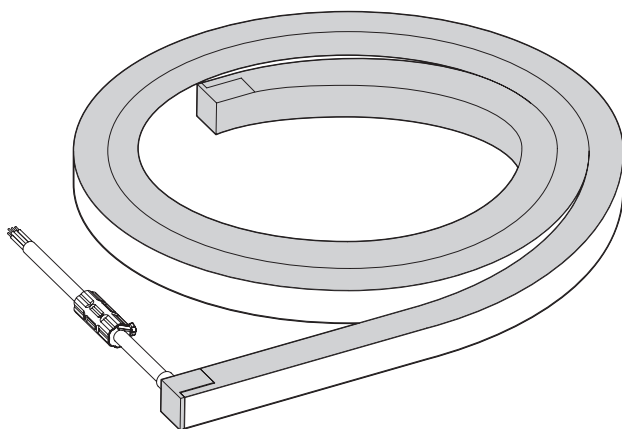

Product	Color	Wavelength [nm]	Voltage [V DC]*	Current/m [mA]*	Power/m [W]*	Lumen/m [lm]*	Operable length [mm]	Beam Angle [°]
GFDT400RGB-G1-RGB-01	RGB	/	24	625	15.0	380	1000	115
	R	620-626	24	185	4.5	110		
	G	518-524	24	200	4.8	210		
	B	466-472	24	240	5.7	60		
GFDT400RGB-G1-RGB-05	RGB	/	24	2710	65.0	1760	5000	115
	R	620-626	24	810	19.5	510		
	G	518-524	24	870	20.8	975		
	B	466-472	24	1030	24.7	275		

Due to the special conditions of the manufacturing processes of LED the typical data of technical parameters can only reflect statistical figures and do not necessarily correspond to the actual parameters of each single product which could differ from the typical data.

*Testing based on $t_a=25^{\circ}\text{C}$, one-meter data, tolerance of lumen flux is $\pm 10\%$.

GinoLED RGB Diffuse TOP Flex

Product	L	W	H
GFDT400RGB-G1-RGB-01	1000	16	17
GFDT400RGB-G1-RGB-05	5000	16	17

Input cable waterproof device can't remove, otherwise IP67 protection will defect.

Yellow: +
 Red: Red -
 Green: Green -
 Blue: Blue -

* Standard 5meter length item keep double side input cable.

Bending & Twisting Caution

Keep the min. bend diameter 300mm ✓

(VB) Vertical Bending ✓

Light Surface

Light Surface

Light Surface

WARNING: The above wrong approaches will damage the light.

Cut Method

Cutting line

Cutting line

The Min. cutting length (see as the feature)

Cut the light only at printed cutting line with light surface face upwards.

The cutting surface must be flush and smooth. ✓

Lighting surface must be upwards

Cutting can only be made at the printed cutting line

The cutting surface must be flush and smooth. WARNING: The above mishandling will damage the light.

End-cap installation guide
FX-GF24-G1-ENDCAP

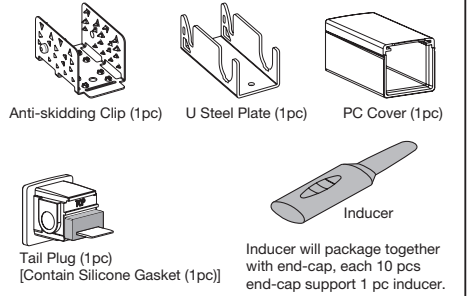
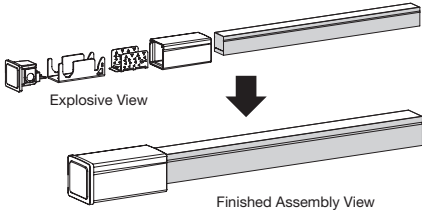

1 Pay attention to the direction marked on the bottom of PC cover

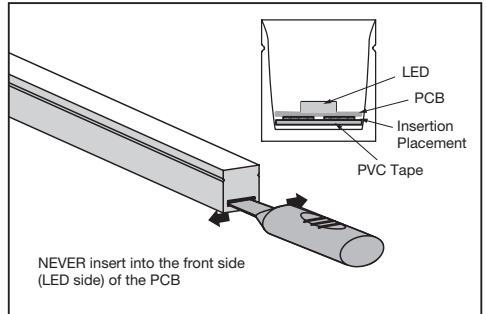
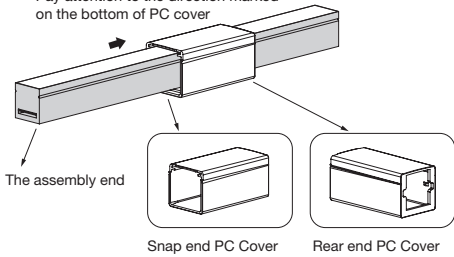

2 Insert the inducer into the backside of PCB around 10-12mm, move the inducer right and left 3-5 times gently to create a small cavity.

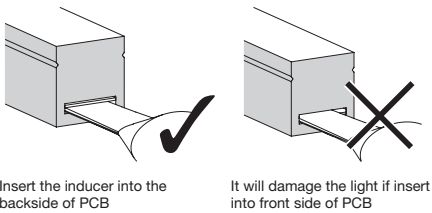

3 It will be a 2-5mm gap.

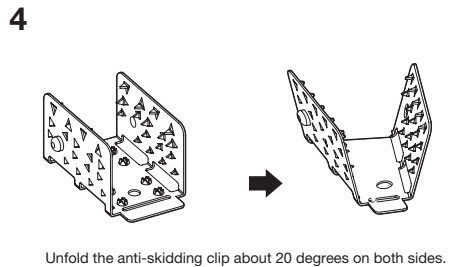
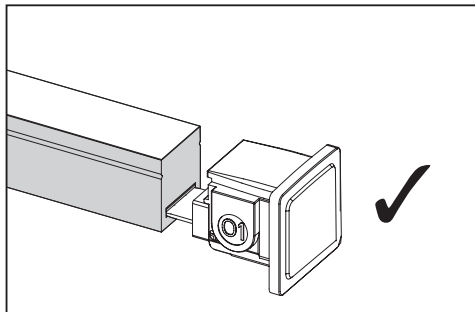
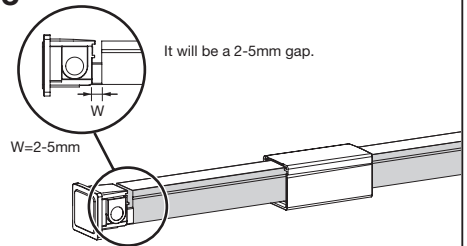

GinoLED RGB Diffuse TOP Flex

5

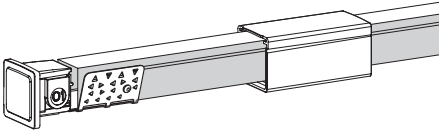

Place the anti-skidding clip onto the assembly end of the light. Pay attention to its direction.

6

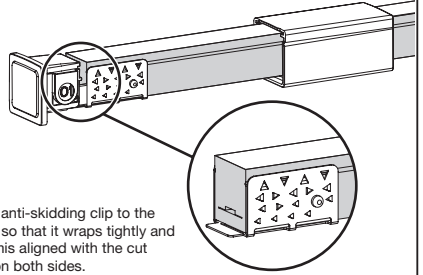

Fit the anti-skidding clip to the end of so that it wraps tightly and its brims aligned with the cut edge on both sides.

7

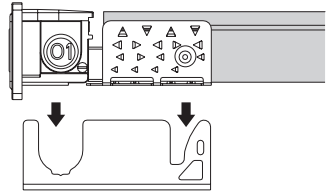
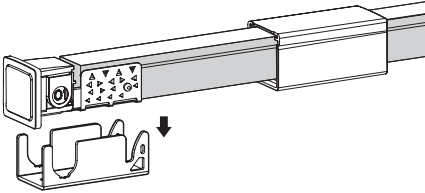

8

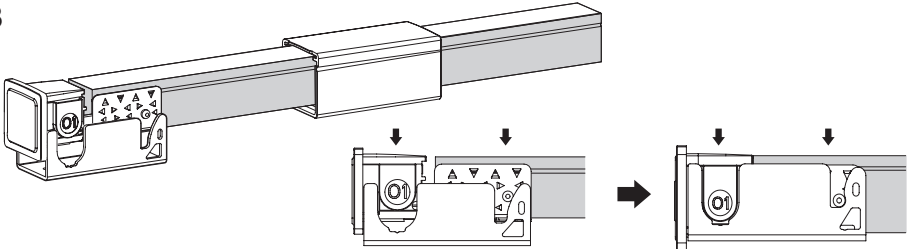

Press the tail plug and light downwards at the same time till bottom.

9

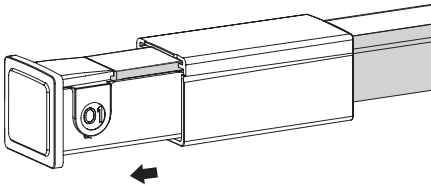

10

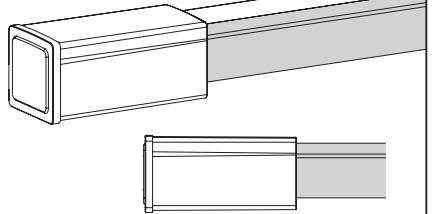

Slide back the PC cover till it snaps in the tail plug.

Clip & Track installation guide
FX-GFPM-G1-TT-22H20-35

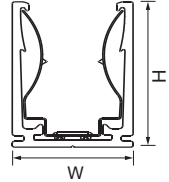
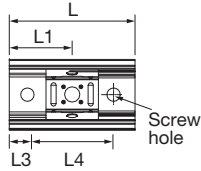
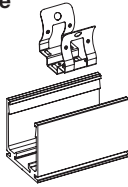
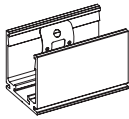

- Note:
1. Unless otherwise stated, the tolerance of the profile is $\pm 0.5\text{mm}$.
 2. Mounting distance between the two parts is $\leq 100\text{mm}$.

L	L1	L3	L4	W	H	Screw hole (mm)	Hole number	Clip number
35mm	17.5mm	5mm	25mm	20.7mm	22.3mm	$\text{\O}3.5$	2	1

FX-GFPM-G1-TT-22H20-1000

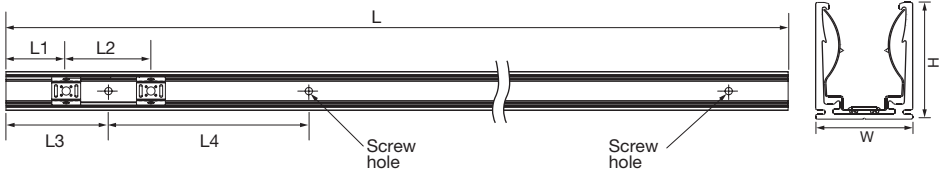
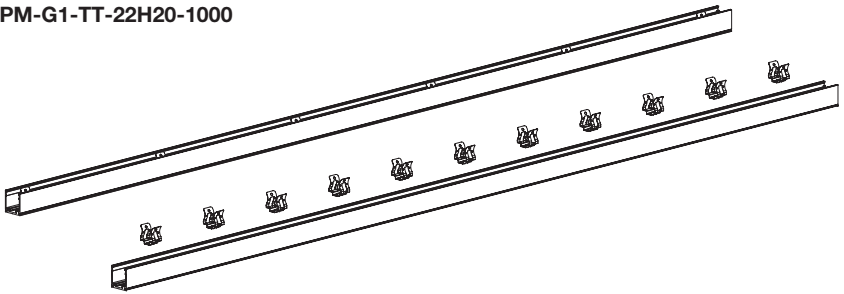

L	L1	L2	L3	L4	W	H	Screw hole (mm)	Hole number	Clip number
1000mm	25mm	95mm	100mm	200mm	20.7mm	22.3mm	$\text{\O}3.5$	5	11

- Note: Unless otherwise stated, the tolerance of the profile is $\pm 0.5\text{mm}$

Joint of Profiles

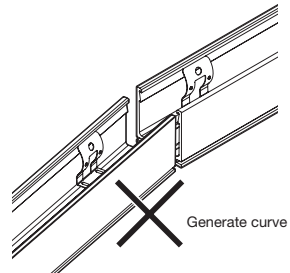
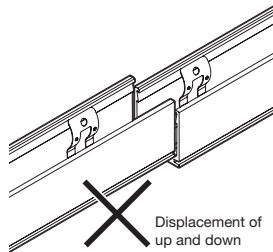
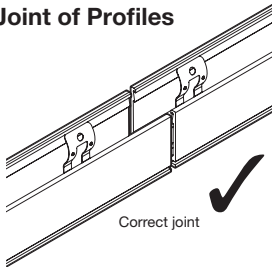

The gap between two mounting channels should be more than 2mm

Light Installation

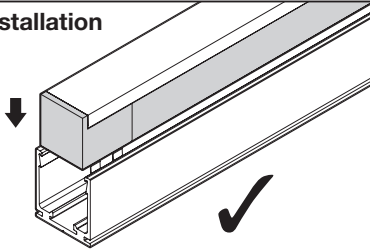

When fixed the light into the profile, make sure the light was fixed in vertically. Specially for the Spring Clip Aluminum Profile.

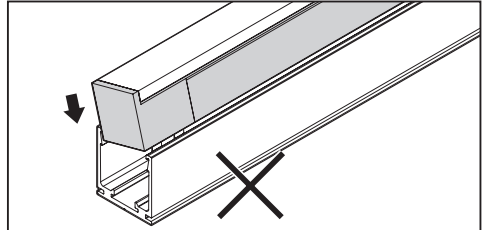

When fixed the light into the profile, if the light was not fixed in vertically like the left picture, it may deform the clip in the Spring Clip Aluminum Profile

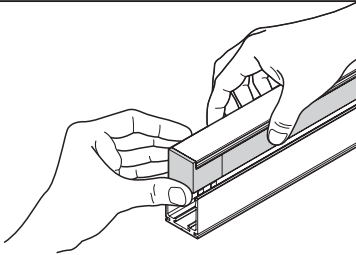

Installation: Press the light into the profile by palm.

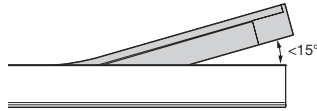

Make sure the angle between light and profile is not bigger than 15°



When the length of light >2m, make sure somebody helps to lift the light.

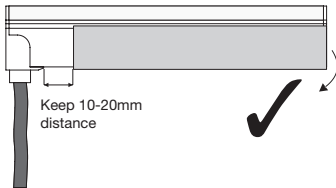

Keep 10-20mm distance

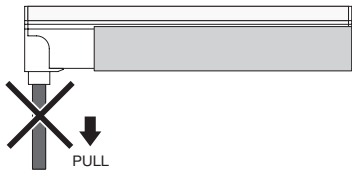

PULL

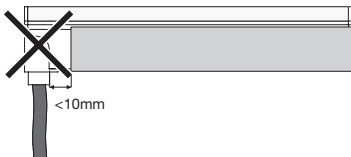

<10mm



PULL

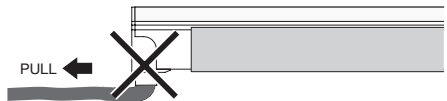

PULL

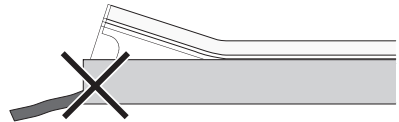

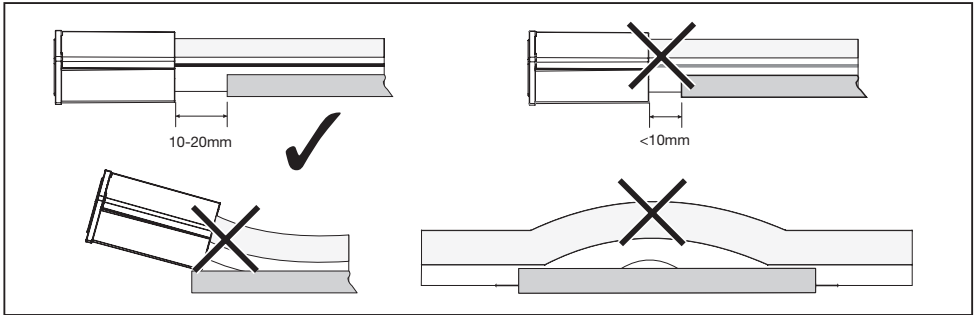

Uninstallation of light in Spring Clip Aluminum Profile

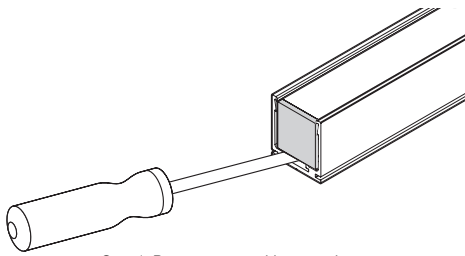

Step 1: Prepare a screwdriver, put the screwdriver at the bottom of light.

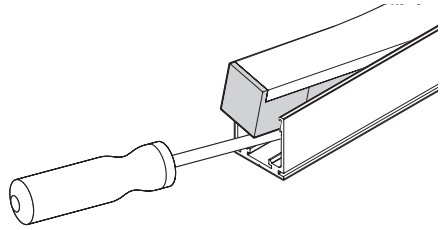

Step 2: Move the screwdriver and unclench the light upwardly, be careful the angle between the light and the profile should not be bigger than 15°

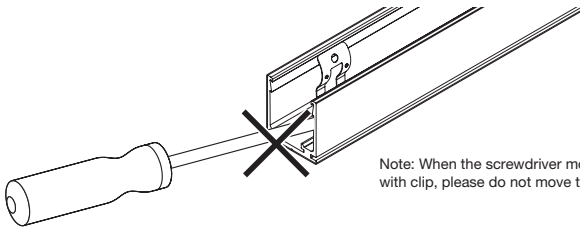

Note: When the screwdriver moves to the position with clip, please do not move the clip, just leave it.

Light Uninstallation

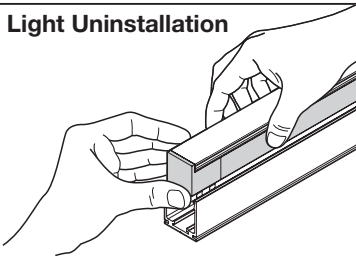

Uninstallation: take both sides of lights, pull it out along the profile slowly. Make sure the angle

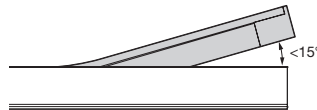

When taking out the light from the profile, the angle should be less than 15°



Make sure somebody helps to lift the light or roll up the light during uninstallation

Safety Information

- The LED module itself and all its components may not be mechanical stressed.
- Assembly must not damage or destroy conducting paths on the circuit board.
- To avoid mechanical damage to the connecting cables, the module should be attached securely to the fixture. Heavy vibration should be avoided.
- Installation of LED modules with (power supplies) needs to be made with regard to all applicable electrical and safety standards. Only qualified personnel should be allowed to perform installation.
- The module net weight: 365g for 1m (1790g for 5m).
- Please ensure that the power supply is of adequate power to operate the total load.
- The module needs to connect with constant Voltage DC driver which must has stable constant Voltage (+/-3% tolerance suggested) output.
- Electrical contact is achieved with the contact cables.
- The design of the housing should be according to the IP standards in the application.
- Pay attention to standard ESD precautions when installing the module.
- If surge protection structure not within power supplier, a lightning protector should be needed additionally for outdoor application.
- For China or Europe market, The module only applied to Class III Luminaire.
- tc max value is 70-degree, higher tc application is not recommended.

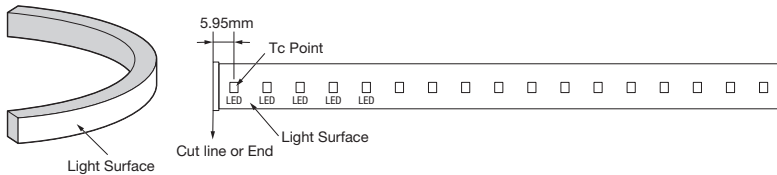

Tc Point is right above light-emitting center of the first LED at power feed-in when light is on.