

Full port ball valve, F x F, with connection for electron probe

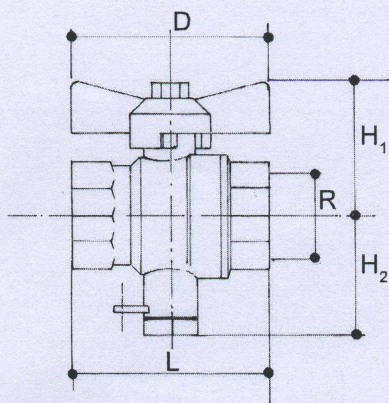
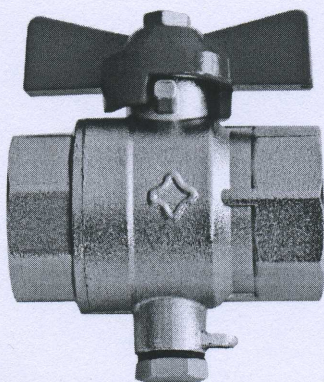

DECREE LAW DD. 25/02/2000 NO.93

the product showed in this technical sheet is made according to PED 97/23/CE and it is CE marking-free as per art. 3 par.3.

1 - Features

Brass CW 617 N -UNI-EN 12165 body and ball.

Brass CW 614 N - UNI-EN 12164. stem.

Ball ground by diamond-tipped tool, nickel and chromium plated.

Virgin P.T.F.E. seats with 7° min. tightness angle

Nitrile-Rubber O-Ring stem packing

Aluminium lever plastic coating

Matt nichel finishing

Threading to UNI-ISO 228/1

2 - Leading dimensions

R"	1/2	3/4	1
L	50	58	68
H ₁	38	40	47
H ₂	32	36	38
D	53	58	65

4 - Working pressures at 80°C max

R"	1/4	3/8	1/2	3/4	1	1 1/4	2	2 1/2	3
PN 32									
PN 25									
PN 20									
PN 16									
PN 10									

5 - Pressure drops

R"	1/2	3/4	1
Kv	15,5	31,7	58,5

3 - Field of use (PED 97/23/CE art.9)

At the pressures and temperature stated in table 4, the valves can be used for the following fluids:

Non-dangerous liquids (Tab.9) ;

The above statement is valid if the fluids concerned are non-aggressive to the copper alloys (bronze-brass).

$$\Delta p [\text{mm H}_2\text{O}] = 10.000 \cdot \left(\frac{G [\text{mc/h}]}{K_v} \right)^2$$

6 - Instructions for use

• The valve is supplied at opening position. The opening and the closing are made by a 90° rotation of the handle. In the opening position of the valve the handle is along the body of the valve, in the closing position the handle is across the body. The ball valve is a valve of interception and not of regulation, therefore it must be opened or closed completely; if it is left in an intermediate position, the seals can be damaged.