

MPS12-30

Micro Power Solutions



Installation and Operation Guide

EATON

Powering Business Worldwide

Front and Rear View

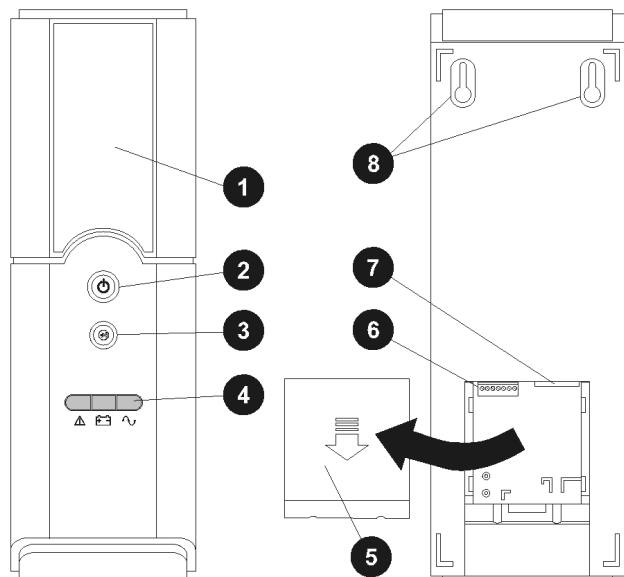

- | | |
|--|---|
| ① Battery cover | ⑥ DC output and alarm connector:
Pin 1: +12V dc output
Pin 2: 0V dc output
Pin 3: Alarm signal return
Pin 4: On battery
Pin 5: Replace battery
Pin 6: Battery missing
Pin 7: Low battery |
| ② AC power switch (push to switch on and off). | ⑦ AC power connector |
| ③ Alarm mute switch (push to switch off the alarm sounds). | ⑧ Wall mount screw key-holes |
| ④ Indicator lights:
~ AC on – green
+ Battery mode – yellow
! Fault - red | |
| ⑤ Connection cover | |

⚠ Warnings

- If MPS12-30 is hotter than usual, or the battery is hot or swollen, disconnect from AC socket/outlet, **switch off AC power switch (2)**, and contact your MPS12-30 supplier.
- Risk of explosion if incorrect battery type is used.
- Risk of internal damage if battery connections are reversed.
- Recycle old batteries according to local regulations. Or contact your MPS12-30 supplier for advice.

What is supplied with the MPS12-30

- Installation and Operation Guide
- AC power cord

What you will need to install the MPS12-30

- 12V dc output/alarm cables (supplied with the terminal equipment or see Specifications).
- Small, flat blade screwdriver for output and alarm connectors.
- Optional: screwdriver and screws for wall mounting.

How to connect the MPS12-30

1. Unpack and check the MPS12-30.

If any item is damaged or missing contact the product supplier. Do not use the MPS12-30 if it is damaged.

2. Remove the rear cover (5).
3. Connect the dc output wires to pin 1 (+) and pin 2 (-) (6).
The alarm connections are optional. Refer to instructions with the terminal equipment.
4. Connect the AC power cord to the MPS12-30 (7).
5. Replace the rear cover.

How to mount the MPS12-30

1. Select a suitable location for the MPS12-30:
 - Close to an AC power socket/outlet. The AC power cord is the main AC disconnect device so ensure the socket/outlet is easily accessible.
 - Close to the terminal equipment. Check the length of the 12V dc output/alarm cable.
 - Protected from excessive moisture and temperature. See Specifications (on next page) for the recommended temperature range.
2. Either:
 - Mount the MPS12-30 on its back on a flat, firm surface, or
 - Mount it on a wall with two screws (see below). If needed, use wall anchors or plugs to suit the type of wall and the weight of the MPS12-30.

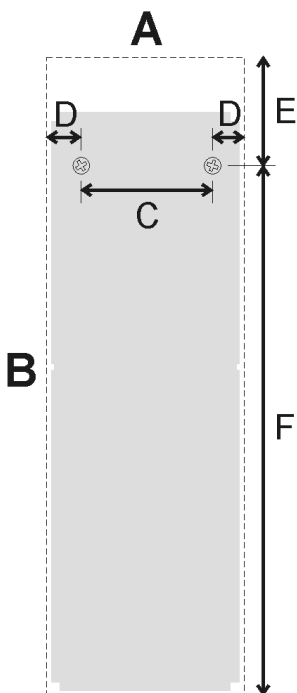

Minimum wall space required:

A = 130mm, B = 420mm

Screw spacing:

C = 80mm

Place the screws at least:

- 25mm from any side obstruction (D).
- 70mm *below* any obstruction (E).
- 350mm *above* any obstruction (F).



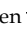

How to turn on the MPS12-30

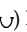
1. Plug the MPS12-30 into the wall socket and switch on the socket. MPS12-30 will beep briefly.
2. Push in the AC power switch (2). The MPS12-30 will beep for two seconds.
3. The AC On light (green ) will flash for five minutes (the MPS12-30 is performing a battery self-test).
4. Check the Alarm mute switch (3) is out.

If the Alarm mute switch is pressed in, then the alarm will not sound to alert you to a problem (the lights will still operate).

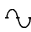
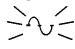
5. Check the connected equipment is operating correctly.
6. After five minutes, check the AC On light (green ) has stopped flashing and no other lights are on.
If any other lights are on, or if the MPS12-30 beeps see below.

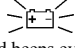
What the lights and alarm sounds mean

Light and Alarm Sound*	Meaning and what to do
No lights on	AC power is not connected. Action required: Check MPS12-30 is plugged into wall socket and socket is switched on. Press AC power switch (2).
Green light on 	AC power is connected. Normal operation. Action required: None.
Green light flashing 	Battery self test. Lasts for 5 minutes at turn-on and every 21 days. Normal operation. Action required: None.
Yellow light on  and beeps every 5 seconds*	The MPS12-30 is operating on battery power** because the AC power is off. Action required: Check MPS12-30 is plugged into wall socket and socket is switched on. Alarm will stop when AC power is restored.
Yellow light flashing  and beeps every second*	The battery power is low. The MPS will shortly shut down and the connected equipment will turn off. Action required: Check MPS12-30 is plugged into wall socket/outlet and socket is switched on. Alarm will stop when AC power is restored.
Red light flashing  and beeps every 2 seconds*	The battery has failed its self-test. Action required: Replace the battery (see next page).
Red light on  and beep is continuous*	Internal fault. Action required: Disconnect from the AC socket/outlet. Switch off AC power switch (2). Contact your MPS12-30 supplier for the repair or replacement procedure.

* No sound if the Alarm Mute switch (3) is pressed in.

** Typically battery will last for five hours, depending on battery age and the connected equipment.

How to replace the battery

Contact your MPS12-30 supplier to purchase a replacement battery.

Warning: Risk of explosion if incorrect battery type is used.

Battery can be replaced with MPS12-30 connected to AC wall socket/outlet.

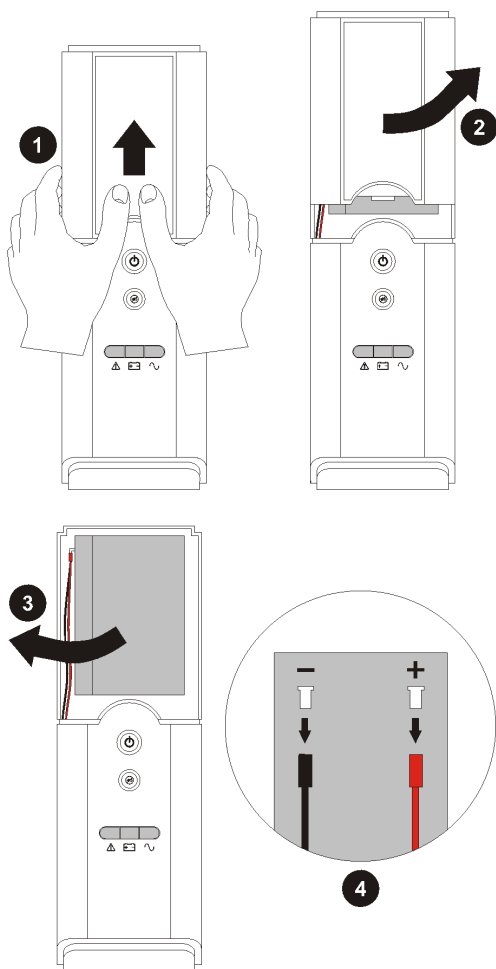

1. Press the battery cover and slide up.
2. Remove the cover.
3. Take out the battery.
4. Disconnect the battery wires.

5. Connect the wires to new battery. Red: positive (+), Black: negative (-).
Warning: Reverse connection may damage the MPS12-30.
6. Place the new battery in the MPS12-30.
7. Replace the battery cover.

Recycle old batteries according to local regulations. Or contact your MPS12-30 supplier for advice.

Specifications

AC Supply	80-260V ac, 45-65Hz
Output Voltage	12V dc nominal, 10.5 - 13.8V dc
Output Power	30W maximum
Battery Type	VRLA, Hot Swappable 12V, 7Ah (12V, 9Ah can be fitted)
Backup time (@ 1A discharge)	5 hours typical
Recharge Time	4 hours to 90%, without load after complete discharge
Discharge Prevention	10.5V \pm 0.5V
Rated Charging Voltage	13.7V \pm 0.25V
Charge Current	2.5A maximum
Output Terminals	Screw connect, maximum wire size 0.5 - 2.0mm ² / 20 - 14 AWG
Alarms	Open collector
DC output cable size	1.5mm ² / 14 AWG recommended
DC output cable length	6m / 20 feet maximum
Operating Temperature	0°C to 40°C / 32°F to 104°F
Operating Humidity	0% to 90%
Operating Elevation	0 to 3000m / 0 to 9800 feet
Dimensions	120mm W, 368mm H, 81mm D 4.7" W, 14.5" H, 3.2" D
Weight	3.5kg / 7.7 lb

Eaton Corporation disclaims any liability for direct, indirect, incidental, special or consequential damages arising out of the application or use of any information contained in this document. The foregoing disclaimer applies to damages or personal injury, property damage, loss of operation, loss of profits, loss of product or loss of time, whether incurred by the purchaser, the purchaser's employees or third party.

Information in this document does not constitute a warranty, representation or guarantee concerning the suitability or performance of Eaton products. No such warranty, representation or guarantee is expressed or implied.

Information contained in this document is subject to change without further notice. Subject to the right to use its equipment, Eaton Corporation does not convey any right, title or interest in its intellectual property, including, without limitation, its patents, copyrights and know-how.

No part of this document may be reproduced or transmitted in any form, by any means or for any purpose other than the Purchaser's personal use, without the express written permission of Eaton Corporation.

Eaton® is a trade name, trademark, and/or service mark of Eaton Corporation or its subsidiaries and affiliates. Unless otherwise noted, brands, product names, trademarks or registered trademarks are the property of their respective holders.

How to replace the battery

Contact your MPS12-30 supplier to purchase a replacement battery.
Warning: Risk of explosion if incorrect battery type is used.

Battery can be replaced with MPS12-30 connected to AC wall socket/outlet.

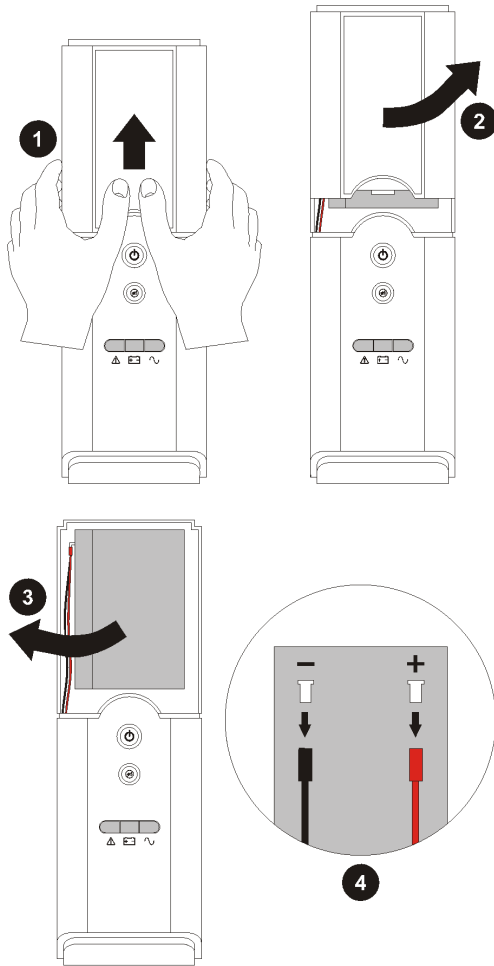

1. Press the battery cover and slide up.
2. Remove the cover.
3. Take out the battery.
4. Disconnect the battery wires.
5. Connect the wires to new battery. Red: positive (+), Black: negative (-).
Warning: Reverse connection may damage the MPS12-30.
6. Place the new battery in the MPS12-30.
7. Replace the battery cover.

Recycle old batteries according to local regulations. Or contact your MPS12-30 supplier for advice.

Specifications

AC Supply	80-260V ac, 45-65Hz
Output Voltage	12V dc nominal, 10.5 - 13.8V dc
Output Power	30W maximum
Battery Type	VRLA, Hot Swappable 12V, 7Ah (12V, 9Ah can be fitted)
Backup time (@ 1A discharge)	5 hours typical
Recharge Time	4 hours to 90%, without load after complete discharge
Discharge Prevention	10.5V \pm 0.5V
Rated Charging Voltage	13.7V \pm 0.25V
Charge Current	2.5A maximum
Output Terminals	Screw connect, maximum wire size 0.5 - 2.0mm ² / 20 - 14 AWG
Alarms	Open collector
DC output cable size	1.5mm ² / 14 AWG recommended
DC output cable length	6m / 20 feet maximum
Operating Temperature	0°C to 40°C / 32°F to 104°F
Operating Humidity	0% to 90%
Operating Elevation	0 to 3000m / 0 to 9800 feet
Dimensions	120mm W, 368mm H, 81mm D 4.7" W, 14.5" H, 3.2" D
Weight	3.5kg / 7.7 lb

Eaton Corporation disclaims any liability for direct, indirect, incidental, special or consequential damages arising out of the application or use of any information contained in this document. The foregoing disclaimer applies to damages or personal injury, property damage, loss of operation, loss of profits, loss of product or loss of time, whether incurred by the purchaser, the purchaser's employees or third party.

Information in this document does not constitute a warranty, representation or guarantee concerning the suitability or performance of Eaton products. No such warranty, representation or guarantee is expressed or implied.

Information contained in this document is subject to change without further notice. Subject to the right to use its equipment, Eaton Corporation does not convey any right, title or interest in its intellectual property, including, without limitation, its patents, copyrights and know-how.

No part of this document may be reproduced or transmitted in any form, by any means or for any purpose other than the Purchaser's personal use, without the express written permission of Eaton Corporation.

Eaton® is a trade name, trademark, and/or service mark of Eaton Corporation or its subsidiaries and affiliates. Unless otherwise noted, brands, product names, trademarks or registered trademarks are the property of their respective holders.

IPN: 997-00012-75A September 2009

© Copyright 2009 Eaton Corporation. All Rights Reserved.

MPS12-30 Micro Power Solutions



Installation and Operation Guide

EATON

Powering Business Worldwide

Front and Rear View

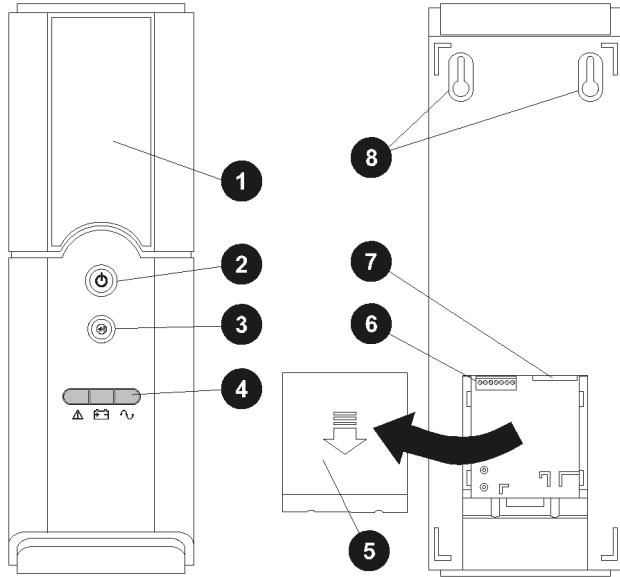

- ① Battery cover
- ② AC power switch (push to switch on and off).
- ③ Alarm mute switch (push to switch off the alarm sounds).
- ④ Indicator lights:
 - ⤴ AC on – green
 - ⤴ Battery mode – yellow
 - ⚠ Fault - red
- ⑤ Connection cover
- ⑥ DC output and alarm connector:
 - Pin 1: +12V dc output
 - Pin 2: 0V dc output
 - Pin 3: Alarm signal return
 - Pin 4: On battery
 - Pin 5: Replace battery
 - Pin 6: Battery missing
 - Pin 7: Low battery
- ⑦ AC power connector
- ⑧ Wall mount screw key-holes

⚠ Warnings

- If MPS12-30 is hotter than usual, or the battery is hot or swollen, disconnect from AC socket/outlet, switch off AC power switch (②), and contact your MPS12-30 supplier.
- Risk of explosion if incorrect battery type is used.
- Risk of internal damage if battery connections are reversed.
- Recycle old batteries according to local regulations. Or contact your MPS12-30 supplier for advice.

What is supplied with the MPS12-30

- Installation and Operation Guide
- AC power cord

What you will need to install the MPS12-30

- 12V dc output/alarm cables (supplied with the terminal equipment or see Specifications).
- Small, flat blade screwdriver for output and alarm connectors.
- Optional: screwdriver and screws for wall mounting.

How to connect the MPS12-30

1. Unpack and check the MPS12-30.
If any item is damaged or missing contact the product supplier. Do not use the MPS12-30 if it is damaged.
2. Remove the rear cover (⑤).
3. Connect the dc output wires to pin 1 (+) and pin 2 (-) (⑥).
The alarm connections are optional. Refer to instructions with the terminal equipment.
4. Connect the AC power cord to the MPS12-30 (⑦).
5. Replace the rear cover.

How to mount the MPS12-30

1. Select a suitable location for the MPS12-30:
 - Close to an AC power socket/outlet. The AC power cord is the main AC disconnect device so ensure the socket/outlet is easily accessible.
 - Close to the terminal equipment. Check the length of the 12V dc output/alarm cable.
 - Protected from excessive moisture and temperature. See Specifications (on next page) for the recommended temperature range.
2. Either:
 - Mount the MPS12-30 on its back on a flat, firm surface, or
 - Mount it on a wall with two screws (see below). If needed, use wall anchors or plugs to suit the type of wall and the weight of the MPS12-30.

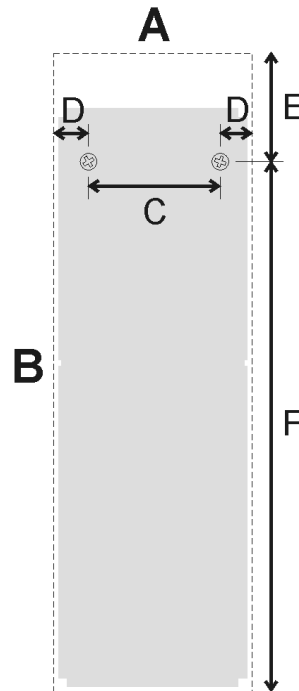

Minimum wall space required:
A = 130mm, B = 420mm

Screw spacing:
C = 80mm

Place the screws at least:

- 25mm from any side obstruction (D).
- 70mm *below* any obstruction (E).
- 350mm *above* any obstruction (F).

How to turn on the MPS12-30

1. Plug the MPS12-30 into the wall socket and switch on the socket. MPS12-30 will beep briefly.
2. Push in the AC power switch (②). The MPS12-30 will beep for two seconds.
3. The AC On light (green ⤴) will flash for five minutes (the MPS12-30 is performing a battery self-test).
4. Check the Alarm mute switch (③) is out.
If the Alarm mute switch is pressed in, then the alarm will not sound to alert you to a problem (the lights will still operate).
5. Check the connected equipment is operating correctly.
6. After five minutes, check the AC On light (green ⤴) has stopped flashing and no other lights are on.
If any other lights are on, or if the MPS12-30 beeps see below.

What the lights and alarm sounds mean

Light and Alarm Sound*	Meaning and what to do
No lights on	AC power is not connected. Action required: Check MPS12-30 is plugged into wall socket and socket is switched on. Press AC power switch (②).
Green light on ⤴	AC power is connected. Normal operation. Action required: None.
Green light flashing ⤴	Battery self test. Lasts for 5 minutes at turn-on and every 21 days. Normal operation. Action required: None.
Yellow light on ⤴ and beeps every 5 seconds*	The MPS12-30 is operating on battery power** because the AC power is off. Action required: Check MPS12-30 is plugged into wall socket and socket is switched on. Alarm will stop when AC power is restored.
Yellow light flashing ⤴ and beeps every second*	The battery power is low. The MPS will shortly shut down and the connected equipment will turn off. Action required: Check MPS12-30 is plugged into wall socket/outlet and socket is switched on. Alarm will stop when AC power is restored.
Red light flashing ⚠ and beeps every 2 seconds*	The battery has failed its self-test. Action required: Replace the battery (see next page).
Red light on ⚠ and beep is continuous*	Internal fault. Action required: Disconnect from the AC socket/outlet. Switch off AC power switch (②). Contact your MPS12-30 supplier for the repair or replacement procedure.

* No sound if the Alarm Mute switch (③) is pressed in.

** Typically battery will last for five hours, depending on battery age and the connected equipment.