

ALUMINIUM TO ALUMINIUM CONNECTOR SL 4.25

TECHNICAL DATA

Type	SL 4.25
Main conductor	16 - 120 mm ²
Branch conductor	16 - 120 mm ²
Screw	2 x M8
Suitable plastic cover	SP 15
Test voltage	4 kV / 50 Hz/1min.
Weight	125g
Tightening torque	20 Nm

USE Non tension aluminium to aluminium connections.

CONSTRUCTION

Component	Material
Body	Corrosion resistant aluminium alloy, tensile strength 300 N/mm ²
Screw	Hot-dip galvanised steel
Springs	Stainless spring steel

The lower section of the body protects the bolts against corrosion and enables the connector to be easily reopened even after years of service. The parallel conductor grooves are brushed, greased and toothed to ensure reliable connections. Stainless steel springs hold the connector parts open making the installation easier.

INSTALLATION

It is not necessary to dismantle the connector during the installation work. Brush and grease the peeled conductors, unscrew the bolts and place the conductors into the grooves. Tighten the bolts with articulated spanner and fork wrench to torque of 20 Nm.

TOOLS REQUIRED

Articulated spanner ST 20 or torque wrench ST 30 with socket ST 13.
Fork wrench ST 34

MARKINGS

SL 4.2
AL 16 - 120 mm²

STANDARD SFS 2663 (1975), Certificate FI 171033 - 01

PACKING 50 pcs in a cardboard box. Each connector is individually packed in a plastic bag.

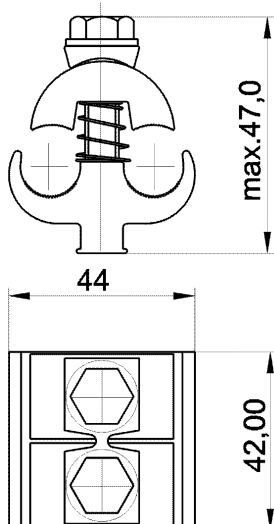

UTILITY NETWORKS

Ensto Sekko Oy
Kipinätie 1
PL 51
06101 Porvoo

Ensto Sekko Oy
Kipinätie 1
P.O. Box 51
06101 Porvoo
Finland

Tel. +358 (0) 204 76 21
Fax +358 (0) 204 76 2771
www.ensto.com

Reg. No. 166.780
Reg. office: Porvoo