



APPLICATION

The fluorescent light fitting type PSF is intended for use in places with an explosive gas and dust atmosphere. The light fitting is designed for use in the industrial areas and facilities, indoor and outdoor spaces.

Hazardous zones: 1, 2, 21, 22.

Ex fluorescent light fitting type PSF is used as fluorescent lighting fitting with two T8 ($\phi 26\text{mm}$), 18/36W - 2G13, fluorescent lamps in parallel configuration.

CONSTRUCTION

Housing: SMC polyester plastic reinforced with glass fiber, color RAL 7038

Diffuser: PC polycarbonate plastic

Gasket: silicone

Central locking: can be opened/closed using a socket key SW8, hinged lamp cover

The light fitting is normally supplied without light sources, with socket key, two Ex e cable glands M25, two Ex e plugs M25 and with four ring screw M8 (pendant version).

TECHNICAL DATA

Certificate:	EXA 13 ATEX 0014, EAC RU C-HR.AB24.B.03249
Marking:	CE 0722
Apparatus category:	II 2GD
Marking of explosion protection:	Ex d e mb IIC T4 Gb Ex tb IIIC T80°C Db
Amb. Temperature/ATEX EAC	$-20^{\circ}\text{C} \leq T_a \leq +50^{\circ}\text{C}$ $-50^{\circ}\text{C} \leq T_a \leq +50^{\circ}\text{C}$
Degree of protection:	IP 66 category 1
Resistance to shock:	IK 08
Protection class :	I (protective earthing)
Rated voltage:	220....240 V ($\pm 10\%$)
Frequency:	50/60 Hz
Power factor:	$\lambda=0,95$
Ballast lumen factor:	98%
End of life switch:	The electronic ballast, type SMP 07/12 fulfills the requirements according to IEC 61347-2-3 (simulation of the "end of life effect" of fluorescent lamps
Estimated service life:	70 000 h at $T_{\text{amb}}=40^{\circ}\text{C}$
Connecting terminals:	L1, L2, L3, N, PE - max. 2,5 mm ²
Cable entry:	Two entries Ex e M25x1,5 for cable diameters $\phi 6\text{-}15\text{ mm}$, and two Ex e plugs, in accordance with EN 62444
Through wiring:	3 x 2,5 mm ² , max. 16 A, or looping of the cables (entry and exit on one side)
Disconnection of the light:	Switch with safety lock; when opening the central lock, all poles of the voltage supply to the ballast are disconnected; contacts of the switching element are NC contacts, they can only be switched on again when the lamp cover and the central locking system are closed. In case of a lamp fault, the electronic ballast disconnects the defective lamp from the power supply.
Packing:	The packing contains: 1 pcs PSF 258 : 1700x270x210 mm PSF 236 : 1420x270x210 mm PSF 218 : 825x270x210 mm

PSF



EXA 13 ATEX 0014



0722



RU C-HR.AB24.B.03249



G 13



MODEL CODE

MODEL CODE	WATTAGE	LAMP TYPE	NOMINAL VOLTAGE	LUMINOUS FLUX [lm]	LAMP HOLDER	NOMINAL OPERATIONAL CURRENT	WEIGHT
PSF 218	2x18 W	T8	220 - 240 V	2 x 1350	G13	0,18 A	7,5 kg
PSF 236	2x36 W			2 x 3350		0,33 A	10 kg
PSF 258	2x58 W			2 x 4600		0,50 A	13 kg

POLAR CURVE

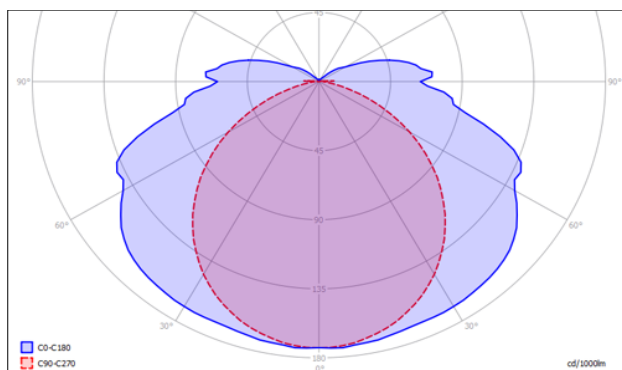

MOUNTING

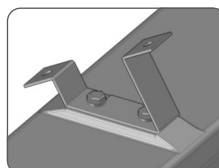

Pendant, on pipe, wall, ceiling

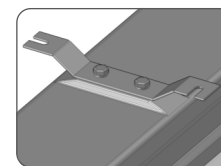
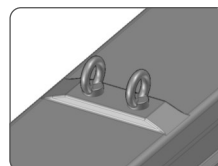
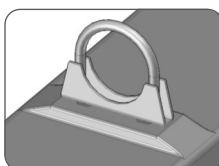

DIMENSION DRAWING (all dimensions in mm)

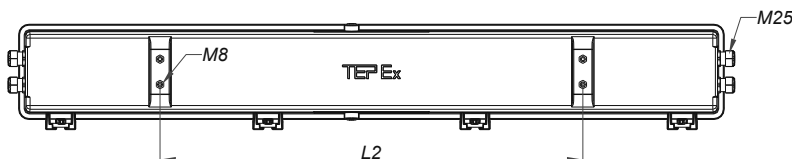
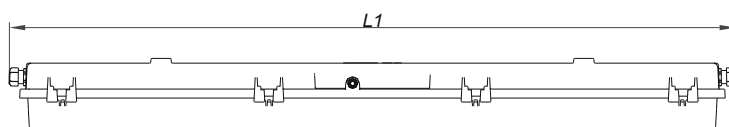
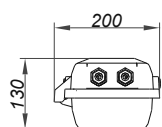

	L1 [mm]	L2 [mm]
PSF 218	750	400
PSF 236	1370	800
PSF 258	1635	800

SPARE PARTS AND ACCESSORIES

SKETCH	DESCRIPTION	CODE	SKETCH	DESCRIPTION	CODE
	Diffuser PSF	PSF218 10-120 PSF236 20-120		Ex e cable gland SPU 25	SPU 25
	Gasket PSF	PSF218 10-130 PSF236 20-130		Ex e plug M25	SPC 25
	Internal reflector with lamp holder PSF	PSF218 10-140 PSF236 20-140		PSF Ceiling mounting set	PSF 30-110
	El. ballast SMP	SMP 07/12 SMP 08 (for PSF258)		PSF Pipe mounting set	PSF 30-120
	Terminals 5x2,5mm²	PSF236 20-150		PSF Wall mounting set	PSF 30-130
	Socket key SW8	PSF236 20-160		Ring bolt M8	PSF 30-140
				PSF Pendant mounting set	PSF 30-150