

P324

Backed by smart motion detection technology, this PoE IP camera can discern people and vehicles. Get alerts when suspicious person or car is loitering around your house or store, not when trees are swaying. Boasting a high resolution of 2560x1920 with nearly 5 million pixels, P324 security IP camera can capture crystal clear video with epic details. With the built-in microphone, it also picks up ambient sound for an extra layer of security. With 18 infrared LEDs and advanced IR technology, it can see any movement clearly in the dark, and crime has nowhere to hide.

1. Specs



1	Mount
2	Metal Aluminum Case
3	High-Definition Lens (f =2.8mm)
4	18 IR LEDs
5	Daylight Sensor

6	Built-In Mic
---	--------------



1	Power
2	Reset Button
3	Network
4	Waterproof Lid

2. Setup and Install

Set up the Camera

What's in the Box

Note: The package content may vary and update with different version and platforms, please take the below information only for a reference. And the actual package content are subject to the latest information on the product selling page.

P324



P324



1m Network Cable*1

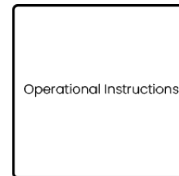

Quick Start Guide*1



Surveillance Sticker*1

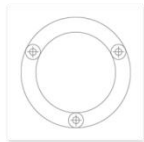

Mounting Template *1



Pack of Screws*1



Waterproof Lid *1

Connection Diagram

Before initial setup, follow the steps below to connect your camera.

1. Connect the camera to a PoE injector with an Ethernet cable.
2. Use the power adapter to power on the PoE injector and connect it to your router.

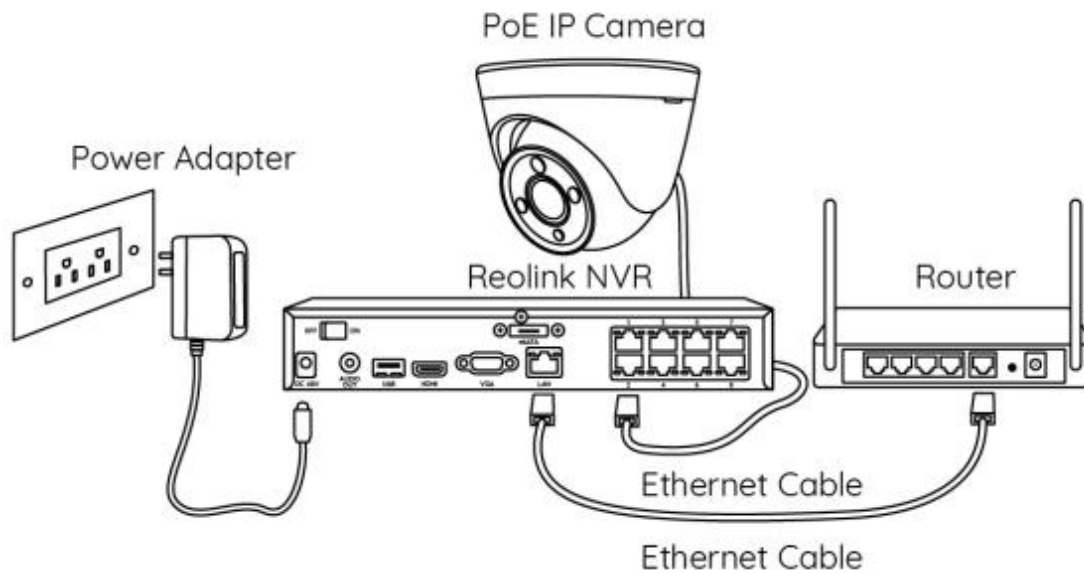

Note: You can power the camera with a PoE switch, PoE injector, Reolink PoE NVR or a DC 12V power adapter (not included in the package).

Set up the Camera on the App

Here is a guide on how to initially set up the camera via Reolink App.

Step 1. Tap the icon  in the top right corner.

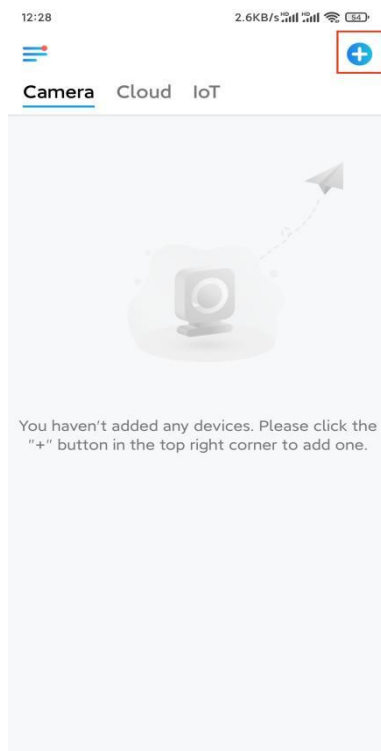

Note: If you've enabled the **Add Device Automatically** option on the App's Settings page, you can tap this device on the **Devices** page and turn to **Step 3** directly.

Step 2. Scan the QR code on the back of the camera. You may tap **Light** to enable a flashlight when setting up the camera in a dark environment.
If the phone doesn't respond, please tap **Input UID/IP** and then manually type in the UID (16-digit characters under the QR code of the camera). Then tap **Next**.

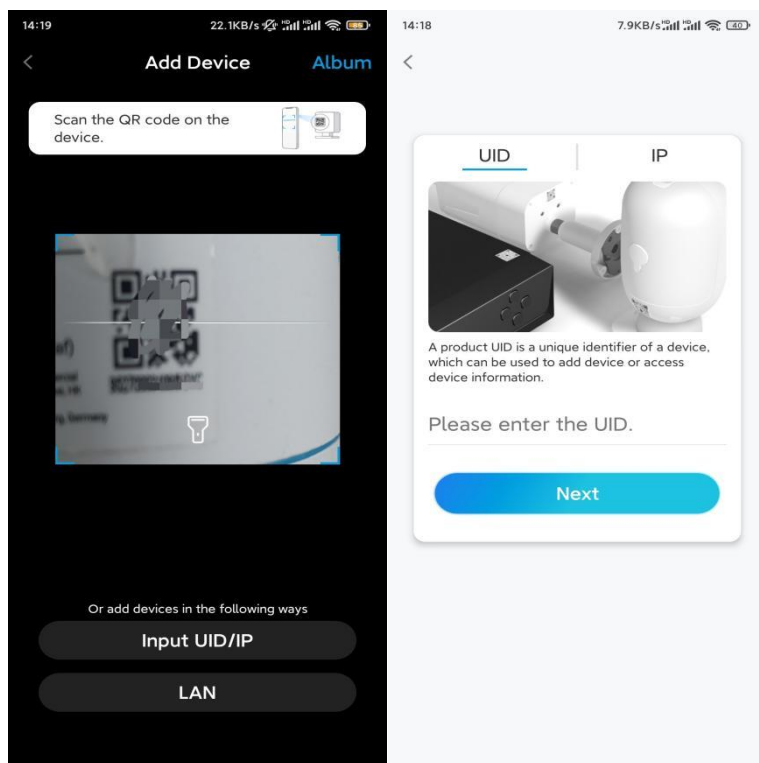

Step 3. Create a login password for your camera. Then tap **Next**.

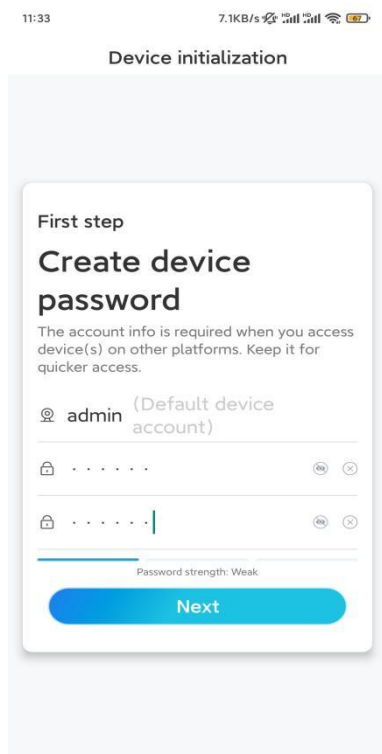

Step 4. Name your camera. Then tap **Next**.

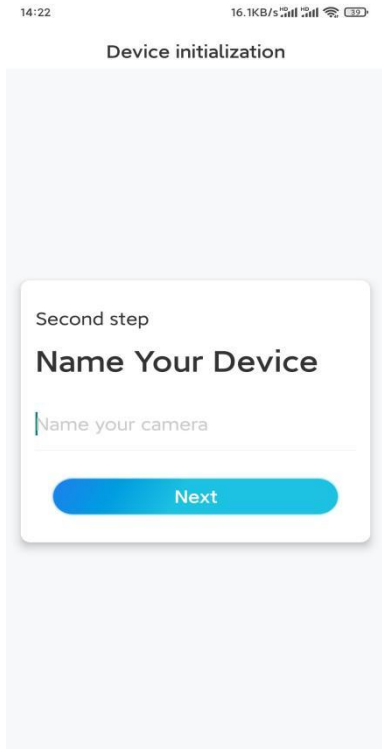

Step 5. Initialization finished! You can start live viewing now.

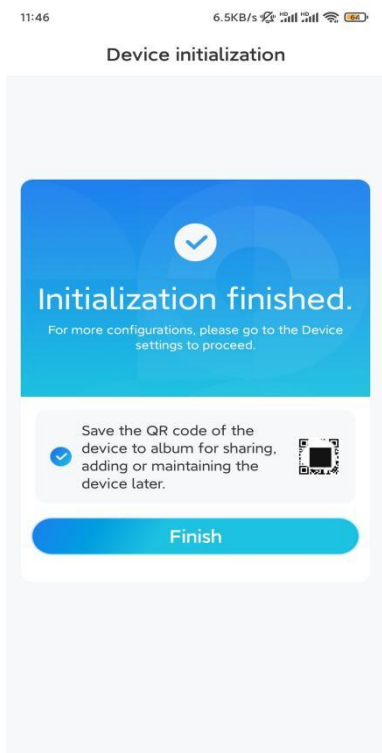

Install the Camera

Please follow the steps below to install the camera.

Step 1. Separate the mounting plate from the camera.

You may hold and press on the camera top and turn the plate counterclockwise as shown below.

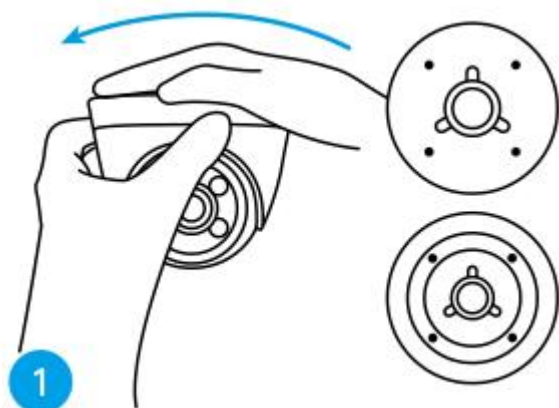

Step 2. Install the mounting plate.

Drill holes on the ceiling according to the mounting hole template and screw the mounting plate firmly.

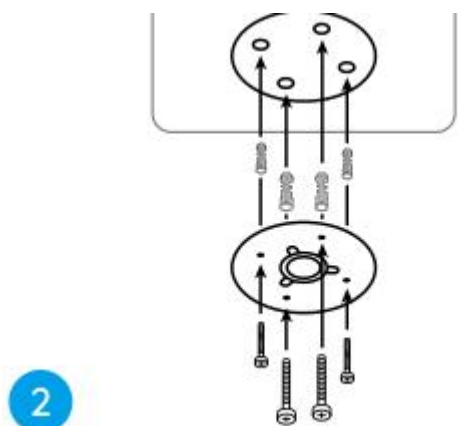

Note: Use the drywall anchors included in the package if needed.

Step 3. Attach the camera.

Align the camera to the mounting plate and turn the camera clockwise to lock it tightly. Pay attention that these two points should be aligned, which means the camera has been locked correctly.

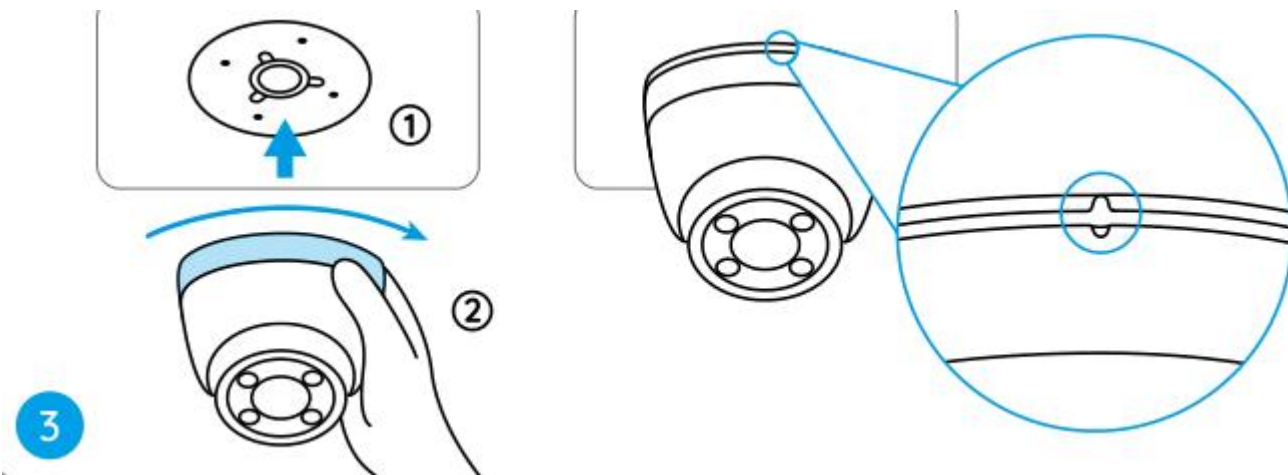

Notes:

Run the cable through the cable notch on the mount base.

If you need to take down the camera, please hold and rotate the camera counterclockwise carefully.

Step 4. Adjust the camera's view angle.

Once the camera is installed, you may rotate the camera body manually to adjust the camera's surveillance angle.

