

NVS8-5MD4

Equipped with smart motion detection technology, the cameras in the NVS8-5MD4 kit can detect moving objects and distinguish people and vehicles from other objects. Boasting a high resolution of 2560x1920, the 5MP security cameras in the kit capture clear and sharp images. You can get buttery-smooth videos, without any freezing or jerky footage. The system features PoE (Power over Ethernet) technology, allowing you to connect each camera to the NVR with a single cable for both power supply and LAN video signal transmission. A real plug-and-play security system!

1. Specs

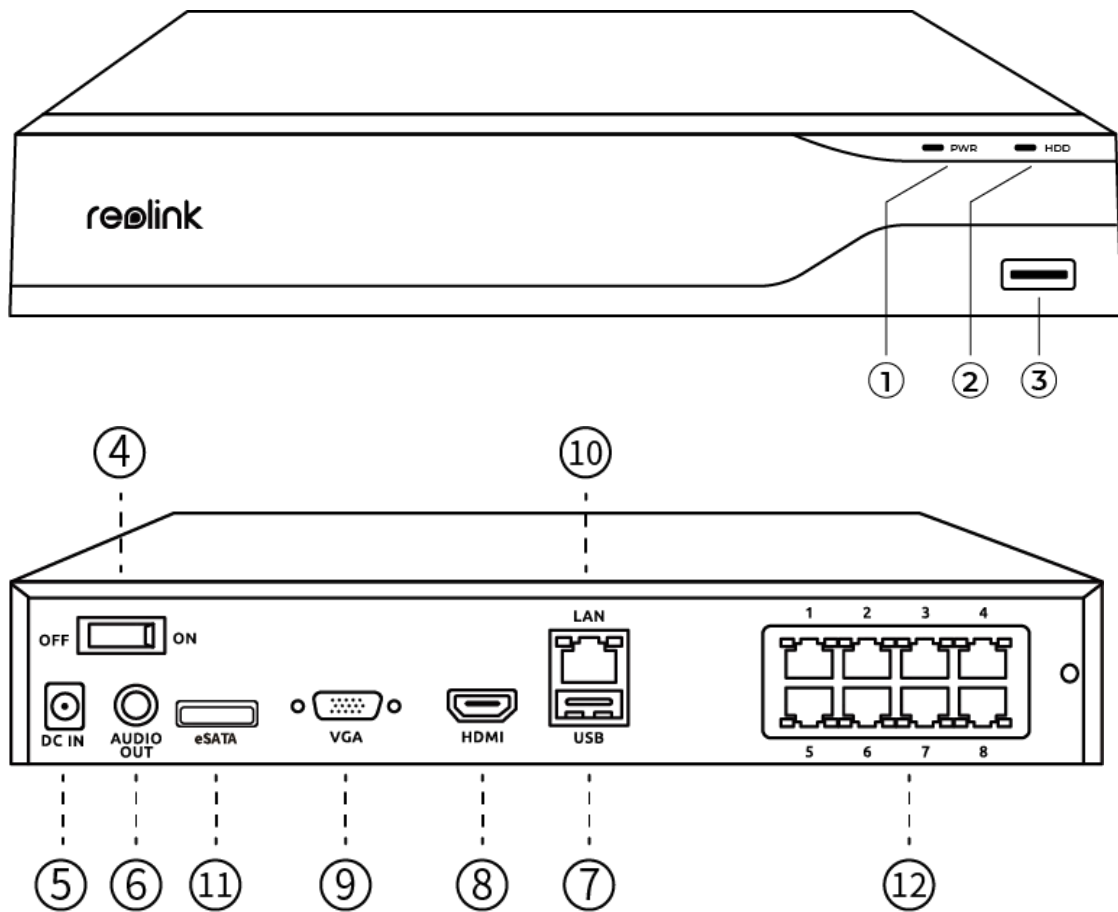

1	Power LED
---	-----------

2	HDD LED
3	USB Port
4	On/Off Switch
5	Power Input
6	Audio Out
7	USB Port
8	HDMI Port
9	VGA Port
10	LAN Port
11	eSATA Port
12	PoE Ports

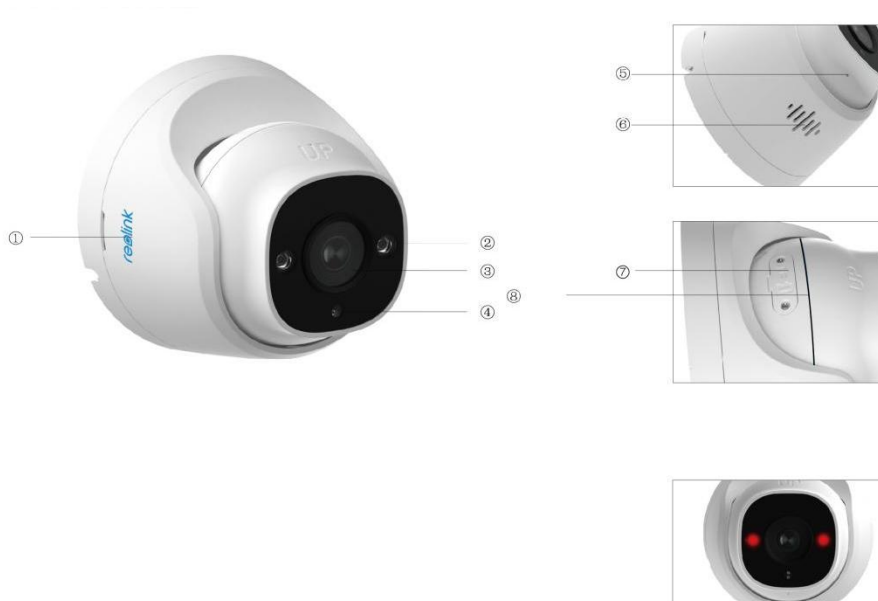

1	Logo
2	IR LEDs
3	Lens
4	Daylight Sensor
5	Mic
6	Speaker
7	microSD Card Slot
8	Waterproof Lap

2. Setup and Install

Set up the System

What's in the Box

Note: The package content may vary and update with different version and platforms, please take the below information only for a reference. And the actual package content are subject to the latest information on the product selling page.

NVS8-5MD4



NVS8



P324



NVR Power Adapter



HDMI Cable



USB Mouse



1m Network Cable*1



Quick Start Guide



Surveillance Sticker



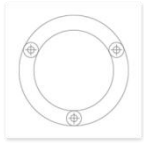

Mounting Template

Pack of Screws



Waterproof Lid

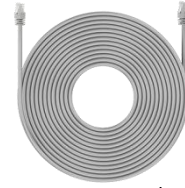

18m Network
Cable*4



Wrench

Connect and Power the NVR

Before initially set up the system on the App, please connect the cameras to the NVR and power on the NVR.

1. Connect the NVR's LAN port to router by Ethernet cable, and connect the mouse to the USB port of the NVR.

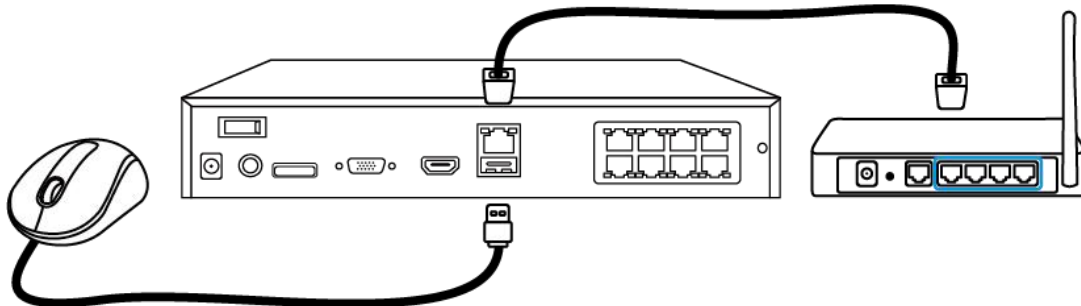

2. Connect the PoE camera to PoE port of the NVR. Or if you want to use a WiFi camera, please connect the camera to the WiFi of the same router as NVR.

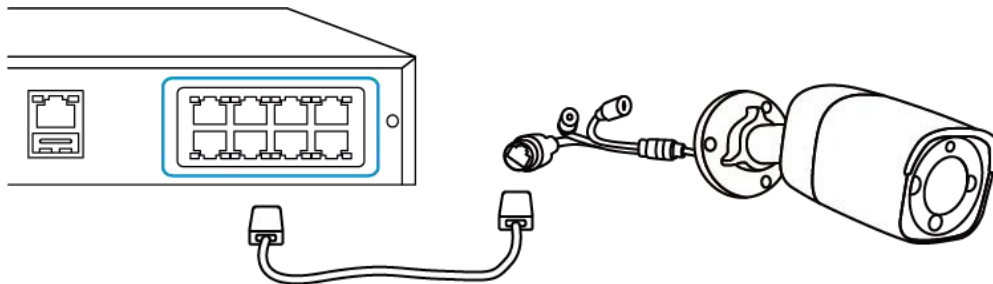

3. Connect the power adapter to the NVR, and switch on the NVR.

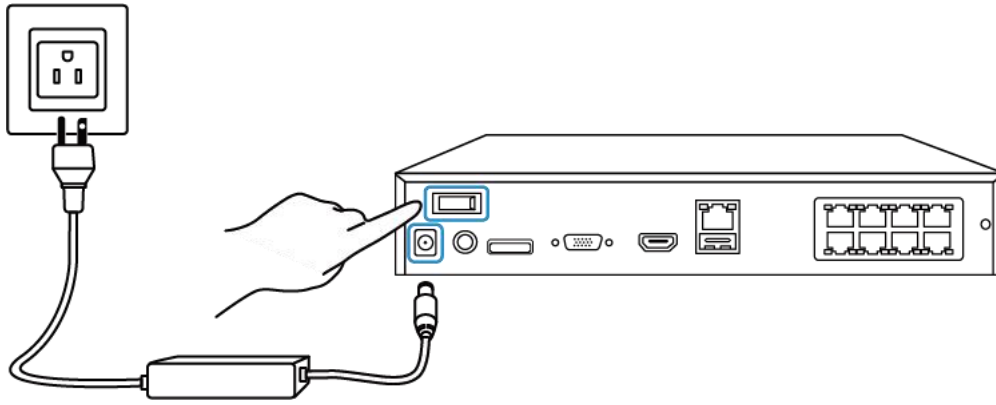

Set up the system on the App

Please initially set up the system on the App by referring to the following steps.

Note: Please make sure the device and your phone are on the same network.

Step 1. Tap the icon  on the top right corner.

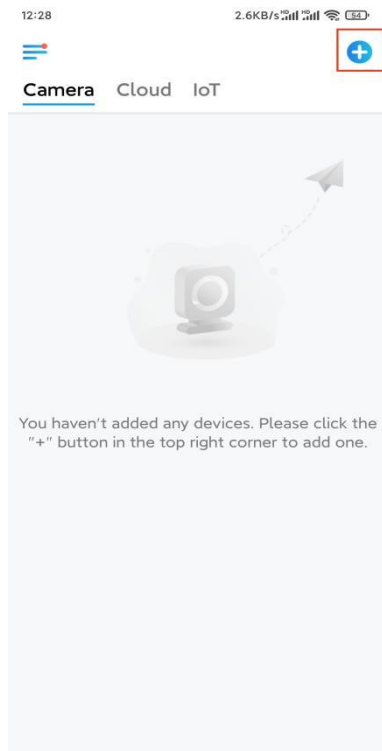

Step 2. Scan the QR code on your NVR, or tap **Input UID/IP** to enter the UID of the NVR (a 16-digit number under the QR code). Then tap **Next**.

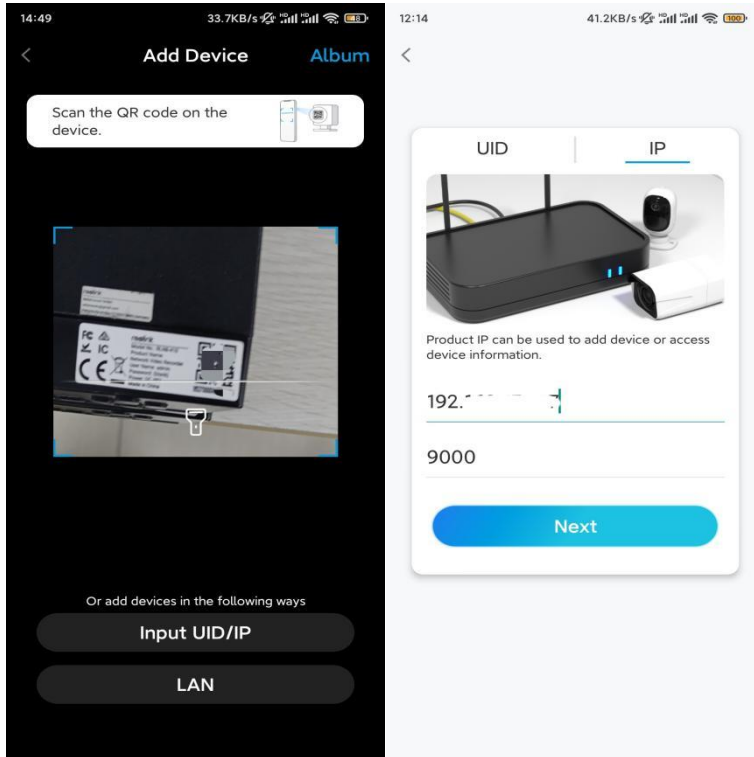

Step 3. For security considerations, you need to create a password for the first time.

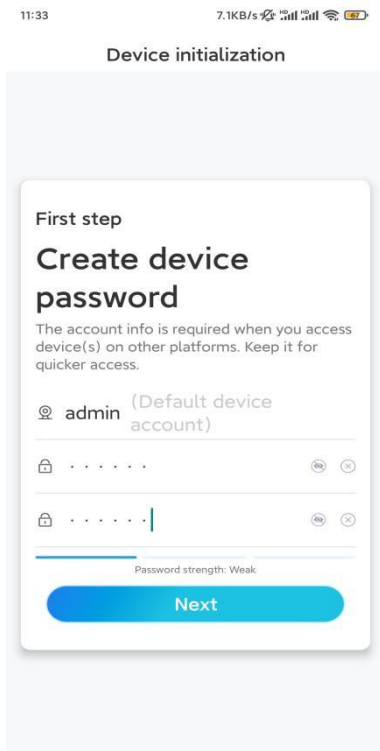

Step 4. Name your device. Then tap **Next**.

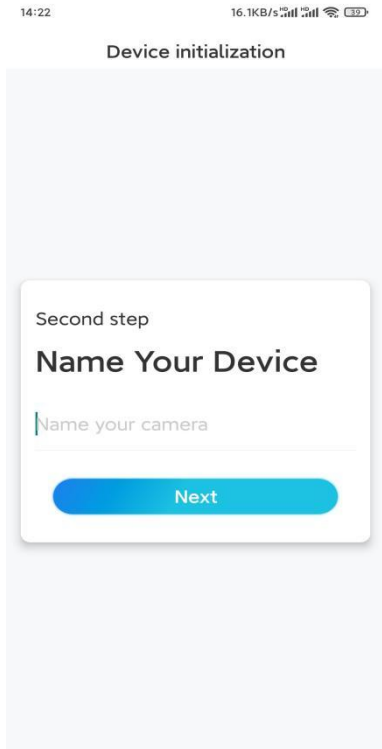

Step 5. Initialization finished! You can start to live view now.

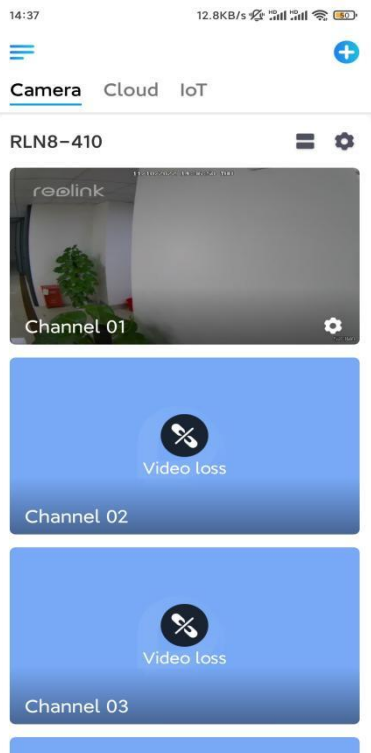

Install the Camera

Please follow the steps below to install the camera.

Step 1. Separate the mounting plate from the camera.

You may hold and press on the camera top and turn the plate counterclockwise as shown below.

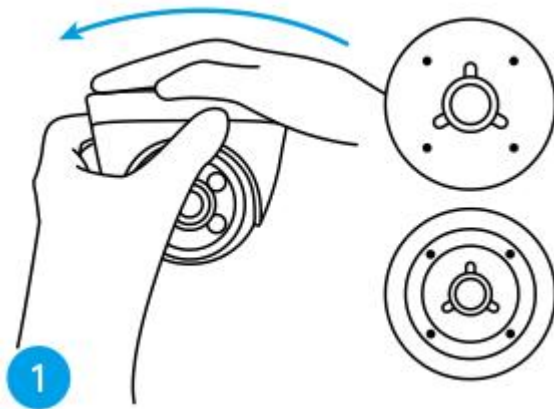

Step 2. Install the mounting plate.

Drill holes on the ceiling according to the mounting hole template and screw the mounting plate firmly.

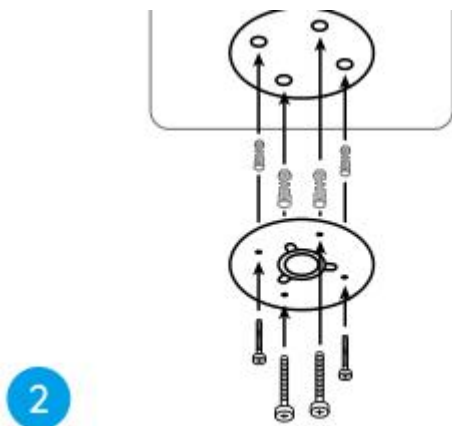

Note: Use the drywall anchors included in the package if needed.

Step 3. Attach the camera.

Align the camera to the mounting plate and turn the camera clockwise to lock it tightly. Pay attention that these two points should be aligned, which means the camera has been locked correctly.

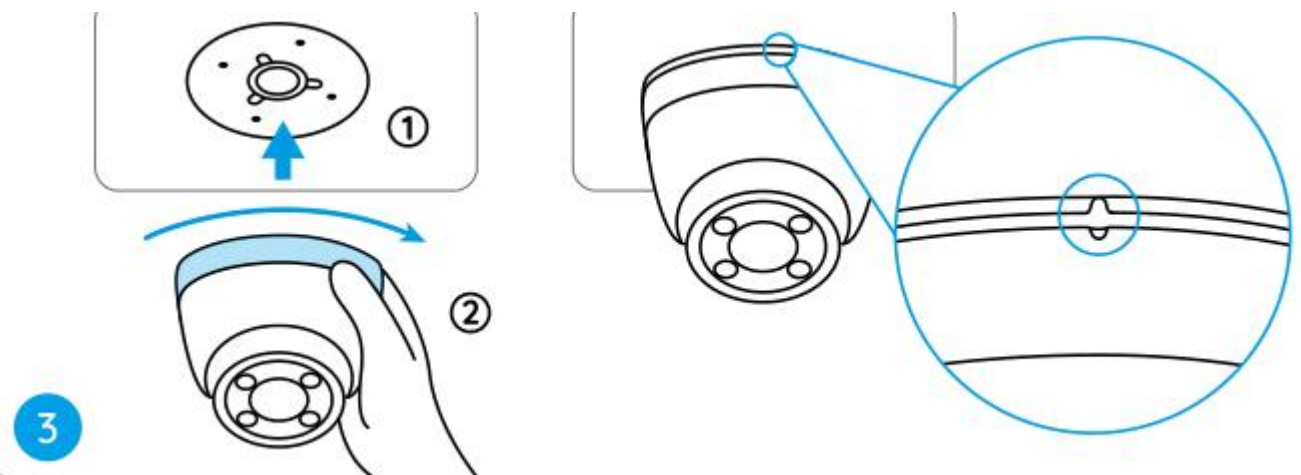

Notes:

Run the cable through the cable notch on the mount base.

If you need to take down the camera, please hold and rotate the camera counterclockwise carefully.

Step 4. Adjust the camera's view angle.

Once the camera is installed, you may rotate the camera body manually to adjust the camera's surveillance angle.

