

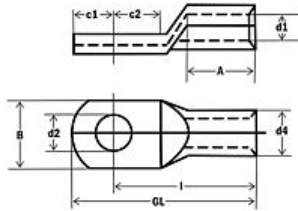

Art.No. 290024

Tubular cable lugs, standard series



| | |
|--------------------|---------------------|
| Art.No. | 290024 |
| EAN | 4011923092962 |
| Cross section | 185 mm ² |
| M | 16 |
| Material | Copper |
| Surface protection | Tinned |
| d1 | 19 mm |
| Hole-Ø | 17 mm |
| d2 | 24 mm |
| c1 | 18 mm |
| c2 | 18 mm |
| B | 35 mm |
| A | 30 |
| v1 | 2 |
| v2 | 1 |
| l | 65 mm |
| Connecting angle | Straight |
| Flange shape | Ring shape |
| Insulated | No |
| Dealer Box | 40 |
| VPE | 20 |

- For stranded round shaped conductors e.g. VDE 0295 class 2
- For preround sector shaped conductors
- Annealed material for easier crimping
- Material: 99.9% electrolytic copper E-CU DIN 40500
- Surface: tin-plated
- Vibration and shock proofing DIN EN 61373:1999-11, Cat. 1, Cl. B

