

MMS-P



MMS-MS



MMS-S



MMS-S C5M



MMS-MF



MMS-R



MMS-I

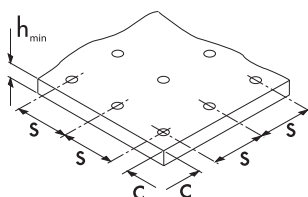
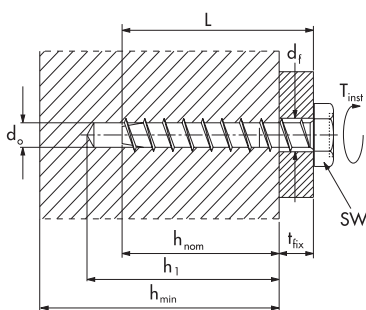
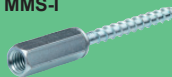

|                                |  | L  | t <sub>fix</sub> | SW  | d <sub>f</sub> | h <sub>1</sub> | ∅ d <sub>0</sub> | h <sub>nom</sub> | T <sub>inst</sub> |
|--------------------------------|--|----|------------------|-----|----------------|----------------|------------------|------------------|-------------------|
|                                |  | mm | mm               | mm  | mm             | mm             | mm               | mm               | Nm                |
| MMS-P 5x30                     |  | 30 | 1                | T25 | 6              | 35             | 4                | 30               | 8                 |
| MMS-P 5x50                     |  | 50 | 15               | T25 | 6              | 40             | 4                | 35               | 8                 |
| MMS-P 6x30                     |  | 30 | 1                | T30 | 7              | 35             | 5                | 30               | 12                |
| MMS-P 7.5x45 <sup>1)</sup>     |  | 45 | 1                | 13  | 9              | 55             | 6                | 45               | 20                |
| MMS-MS 7.5x45 <sup>1)</sup>    |  | 45 | 1                | 13  | 9              | 55             | 6                | 45               | 20                |
| MMS-S 6x40                     |  | 40 | 5                | 10  | 7              | 45             | 5                | 35               | 12                |
| MMS-S 6x50 <sup>1)</sup>       |  | 50 | 5                | 10  | 7              | 55             | 5                | 45               | 12                |
| MMS-S 6x60 <sup>1)</sup>       |  | 60 | 15               | 10  | 7              | 55             | 5                | 45               | 12                |
| MMS-S 7.5x35                   |  | 35 | 1                | 13  | 9              | 40             | 6                | 35               | 20                |
| MMS-S 7.5x40                   |  | 40 | 5                | 13  | 9              | 45             | 6                | 35               | 20                |
| MMS-S 7.5x50 <sup>1)</sup>     |  | 50 | 5                | 13  | 9              | 55             | 6                | 45               | 20                |
| MMS-S 10x60 <sup>1)</sup>      |  | 60 | 5                | 16  | 12             | 65             | 8                | 55               | 50                |
| MMS-S 7.5x50/65 <sup>3)</sup>  |  | 50 | 5                | 13  | 9              | 70             | 6                | 45               | 20                |
| MMS-S 10x70/85 <sup>2)3)</sup> |  | 70 | 5                | 16  | 12             | 75             | 8                | 65               | 50                |
| MMS-MF 6x40                    |  | 40 | 5                | 10  | 7              | 45             | 5                | 35               | 12                |
| MMS-MF 6x50 <sup>1)</sup>      |  | 50 | 5                | 10  | 7              | 55             | 5                | 45               | 12                |
| MMS-MF 6x60 <sup>1)</sup>      |  | 60 | 15               | 10  | 7              | 55             | 5                | 45               | 12                |
| MMS-MF 7.5x50 <sup>1)</sup>    |  | 50 | 5                | 13  | 9              | 55             | 6                | 45               | 20                |
| MMS-MF 7.5x70 <sup>2)</sup>    |  | 70 | 5                | 13  | 9              | 75             | 6                | 65               | 20                |
| MMS-R 6x40                     |  | 40 | 5                | -   | 7              | 50             | 5                | 40               | 12                |
| MMS-I 7.5x60 <sup>2)</sup>     |  | 60 | 5                | 13  | 9              | 65             | 6                | 55               | 20                |

<sup>1)</sup> DIBt Zulassung Nr. Z-21.1-1503

<sup>2)</sup> ETA 05/0010

<sup>3)</sup> Acid-proof stainless steel A4

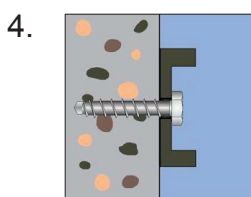
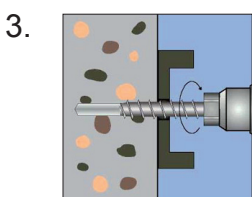
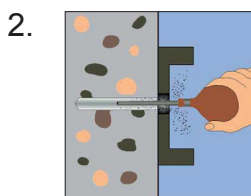
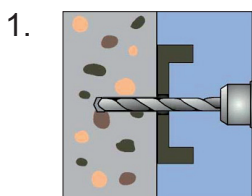

## Max. empfohlene Lasten von MULTI-MONTI Schraubankern in Beton und Mauerwerk

| Dübelgröße   |                | MMS-5 |      |      | MMS-6 |     |      | MMS-7.5 |     |      | MMS-10 |  |
|--|----------------|-------|------|------|-------|-----|------|---------|-----|------|--------|--|
| <b>Max. empfohlene Zuglast eines Einzeldübels ohne Randeinfluß</b>   |                |       |      |      |       |     |      |         |     |      |        |  |
| Gerissener Beton C 20/25   | kN             | nein  | 1.8  | nein | 1.7   | 2.7 | nein | 2.6     | 3.8 | 3.6  | 4.9    |  |
| Ungerissener Beton C 20/25   | kN             | 1.9   | 2.6  | 1.9  | 2.4   | 3.8 | 2.2  | 3.7     | 5.3 | 5.0  | 6.8    |  |
| <b>Max. empfohlene Querkraft eines Einzeldübels ohne Randeinfluß</b> |                |       |      |      |       |     |      |         |     |      |        |  |
| Gerissener Beton C 20/25   | kN             | nein  | 2.0  | nein | 1.5   | 3.1 | nein | 2.4     | 3.4 | 4.5  | 7.9    |  |
| Ungerissener Beton C 20/25   | kN             | nein  | 2.0  | nein | 2.1   | 3.1 | 1.9  | 3.4     | 3.4 | 6.3  | 7.9    |  |
| <b>Max. empfohlene Biegemoment eines Einzeldübels</b>                |                |       |      |      |       |     |      |         |     |      |        |  |
|  | Nm             | nein  | nein | nein | 5.1   | 5.1 | 9.4  | 9.4     | 9.4 | 18.7 | 18.7   |  |
| <b>Bauteilabmessungen und Montagekennwerte</b>                       |                |       |      |      |       |     |      |         |     |      |        |  |
| Verankerungstiefe  | $h_{nom} \geq$ | mm    | 30   | 35   | 30    | 35  | 45   | 35      | 45  | 55   | 65/75  |  |
| Min. Achsabstand   | $s_{min} =$    | mm    | 35   | 35   | 40    | 40  | 40   | 40      | 40  | 50   | 50     |  |
| Min. Randabstand   | $c_{min} =$    | mm    | 35   | 35   | 40    | 40  | 40   | 40      | 40  | 50   | 50     |  |
| Dicke des Betons   | $h_{min} =$    | mm    | –    | –    | –     | 100 | 100  | 100     |     | 120  |        |  |

## Max. recommended loads for MULTI-MONTI Screw-In-Anchors in concrete and masonry

| Anchor size  |                | MMS-5 |     |     | MMS-6 |     |     | MMS-7.5 |     |      | MMS-10 |  |
|--|----------------|-------|-----|-----|-------|-----|-----|---------|-----|------|--------|--|
| <b>Max. recommended tension load of a single anchor without edge influence</b> |                |       |     |     |       |     |     |         |     |      |        |  |
| Cracked concrete C 20/25   | kN             | no    | 1.8 | no  | 1.7   | 2.7 | no  | 2.6     | 3.8 | 3.6  | 4.9    |  |
| Non-cracked concrete C 20/25   | kN             | 1.9   | 2.6 | 1.9 | 2.4   | 3.8 | 2.2 | 3.7     | 5.3 | 5.0  | 6.8    |  |
| <b>Max. recommended shear load of a single anchor without edge influence</b>   |                |       |     |     |       |     |     |         |     |      |        |  |
| Cracked concrete C 20/25   | kN             | no    | 2.0 | no  | 1.5   | 3.1 | no  | 2.4     | 3.4 | 4.5  | 7.9    |  |
| Non-cracked concrete C 20/25   | kN             | no    | 2.0 | no  | 2.1   | 3.1 | 1.9 | 3.4     | 3.4 | 6.3  | 7.9    |  |
| <b>Max. recommended bending load of a single anchor</b>                        |                |       |     |     |       |     |     |         |     |      |        |  |
|  | Nm             | no    | no  | no  | 5.1   | 5.1 | 9.4 | 9.4     | 9.4 | 18.7 | 18.7   |  |
| <b>Dimensions of the concrete member and installation data</b>                 |                |       |     |     |       |     |     |         |     |      |        |  |
| Embedment  | $h_{nom} \geq$ | mm    | 30  | 35  | 30    | 35  | 45  | 35      | 45  | 55   | 65/75  |  |
| Min. spacing   | $s_{min} =$    | mm    | 35  | 35  | 40    | 40  | 40  | 40      | 40  | 50   | 50     |  |
| Min. edge distance   | $c_{min} =$    | mm    | 35  | 35  | 40    | 40  | 40  | 40      | 40  | 50   | 50     |  |
| Thickness of the concrete  | $h_{min} =$    | mm    | –   | –   | –     | 100 | 100 | 100     |     | 120  |        |  |

## Carga máxima recomendada para MULTI-MONTI Tornillo de anclaje en hormigón y albañilería

| Tamaño del anclaje  |                | MMS-5 |     |     | MMS-6 |     |     | MMS-7.5 |     |      | MMS-10 |  |
|---|----------------|-------|-----|-----|-------|-----|-----|---------|-----|------|--------|--|
| <b>Carga máxima recomendada de un solo anclaje sin influencia de borde</b>                    |                |       |     |     |       |     |     |         |     |      |        |  |
| Hormigón agrietado C 20/25  | kN             | no    | 1.8 | no  | 1.7   | 2.7 | no  | 2.6     | 3.8 | 3.6  | 4.9    |  |
| Hormigón sin grietas C 20/25  | kN             | 1.9   | 2.6 | 1.9 | 2.4   | 3.8 | 2.2 | 3.7     | 5.3 | 5.0  | 6.8    |  |
| <b>Carga máxima recomendada de corte a cizalla de un solo anclaje sin influencia de borde</b> |                |       |     |     |       |     |     |         |     |      |        |  |
| Hormigón agrietado C 20/25  | kN             | no    | 2.0 | no  | 1.5   | 3.1 | no  | 2.4     | 3.4 | 4.5  | 7.9    |  |
| Hormigón sin grietas C 20/25  | kN             | no    | 2.0 | no  | 2.1   | 3.1 | 1.9 | 3.4     | 3.4 | 6.3  | 7.9    |  |
| <b>Carga máxima recomendada de flexión de un solo anclaje</b>                                 |                |       |     |     |       |     |     |         |     |      |        |  |
|   | Nm             | no    | no  | no  | 5.1   | 5.1 | 9.4 | 9.4     | 9.4 | 18.7 | 18.7   |  |
| <b>Dimensiones de los componentes de hormigón y datos de instalación</b>                      |                |       |     |     |       |     |     |         |     |      |        |  |
| Empotramiento   | $h_{nom} \geq$ | mm    | 30  | 35  | 30    | 35  | 45  | 35      | 45  | 55   | 65/75  |  |
| Separación mínima   | $s_{min} =$    | mm    | 35  | 35  | 40    | 40  | 40  | 40      | 40  | 50   | 50     |  |
| Distancia mínima al borde   | $c_{min} =$    | mm    | 35  | 35  | 40    | 40  | 40  | 40      | 40  | 50   | 50     |  |
| Grueso del hormigón   | $h_{min} =$    | mm    | –   | –   | –     | 100 | 100 | 100     |     | 120  |        |  |

## Charges maximales recommandées pour les MULTI-MONTI vis pour la fixation dans béton et maçonnerie

| Taille pour la fixation  |                | MMS-5 |     |     | MMS-6 |     |     | MMS-7.5 |     |      | MMS-10 |  |
|--|----------------|-------|-----|-----|-------|-----|-----|---------|-----|------|--------|--|
| <b>Charge maximale recommandée de la tension sur une seule vis/fixation sans influence du rebord</b>     |                |       |     |     |       |     |     |         |     |      |        |  |
| Béton avec craquelures C 20/25   | kN             | non   | 1.8 | non | 1.7   | 2.7 | non | 2.6     | 3.8 | 3.6  | 4.9    |  |
| Béton sans craquelures C 20/25   | kN             | 1.9   | 2.6 | 1.9 | 2.4   | 3.8 | 2.2 | 3.7     | 5.3 | 5.0  | 6.8    |  |
| <b>Charge maximale recommandée de cassure d'un point unique du vis/fixation sans influence du rebord</b> |                |       |     |     |       |     |     |         |     |      |        |  |
| Béton avec craquelures C 20/25   | kN             | non   | 2.0 | non | 1.5   | 3.1 | non | 2.4     | 3.4 | 4.5  | 7.9    |  |
| Béton sans craquelures C 20/25   | kN             | non   | 2.0 | non | 2.1   | 3.1 | 1.9 | 3.4     | 3.4 | 6.3  | 7.9    |  |
| <b>Charge maximale recommandée de flexion d'une seule vis/fixation</b>                                   |                |       |     |     |       |     |     |         |     |      |        |  |
|  | Nm             | non   | non | non | 5.1   | 5.1 | 9.4 | 9.4     | 9.4 | 18.7 | 18.7   |  |
| <b>Dimensions de l'élément en béton et des données de l'installation</b>                                 |                |       |     |     |       |     |     |         |     |      |        |  |
| Intégration  | $h_{nom} \geq$ | mm    | 30  | 35  | 30    | 35  | 45  | 35      | 45  | 55   | 65/75  |  |
| L'espacement minimal   | $s_{min} =$    | mm    | 35  | 35  | 40    | 40  | 40  | 40      | 40  | 50   | 50     |  |
| Distance minimale du bord  | $c_{min} =$    | mm    | 35  | 35  | 40    | 40  | 40  | 40      | 40  | 50   | 50     |  |
| Épaisseur du béton   | $h_{min} =$    | mm    | –   | –   | –     | 100 | 100 | 100     |     | 120  |        |  |