

PVX611

SE GB DE DK FI

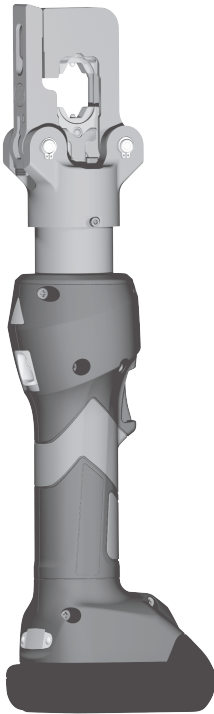

Elpress AB, P.O. Box 186, SE-872 24 KRAMFORS, Sweden
Tel: +46 (0)612-71 71 00 | Fax: +(0)46 612-71 71 51
E-mail: sales@elpress.se | www.elpress.se



ELPRESS[®]

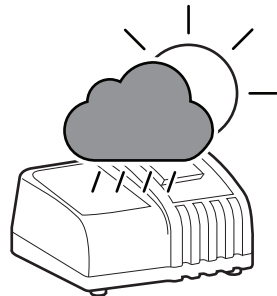
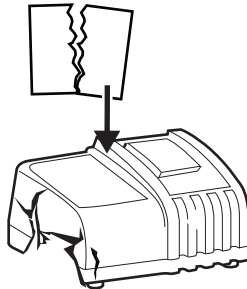
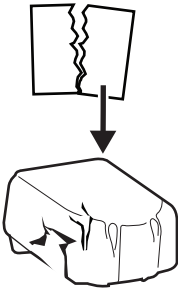
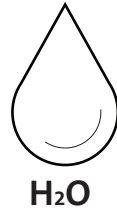
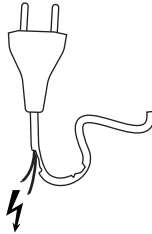
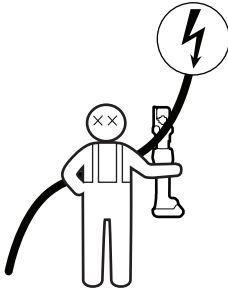
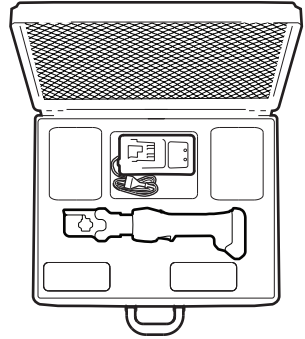
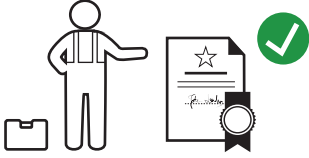
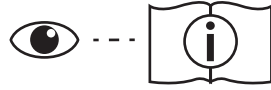



1

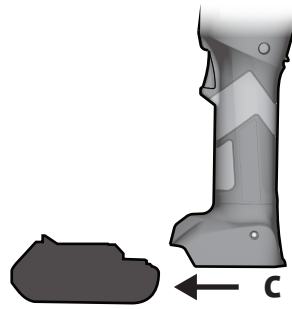
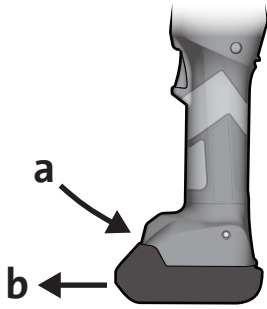

2

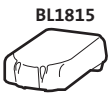
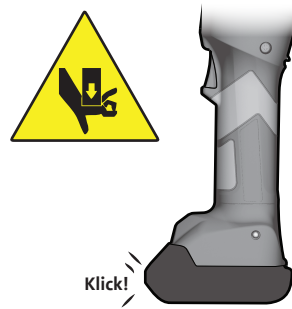
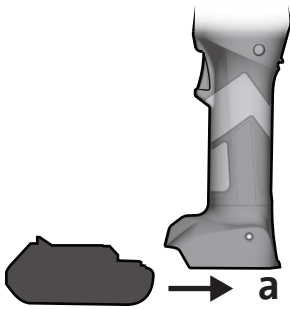

220-240 V
~ 50-60 Hz
10 - 40°C



BL1815



15 min

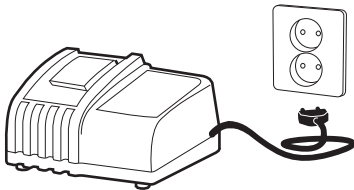

BL1830



36 min



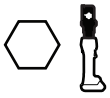

1

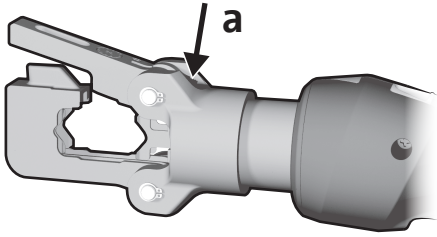

2

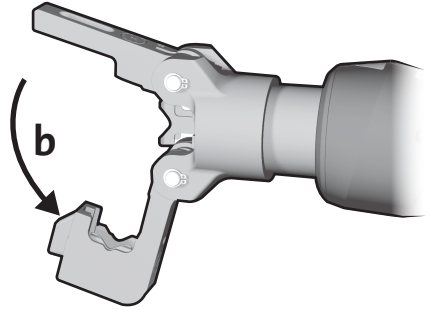

3

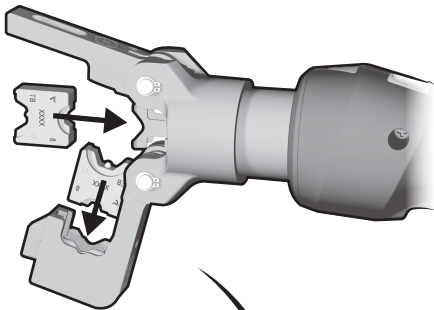

4

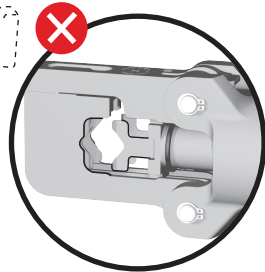
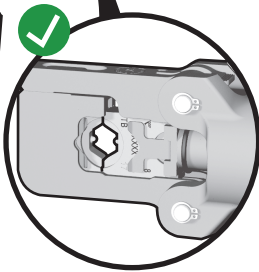
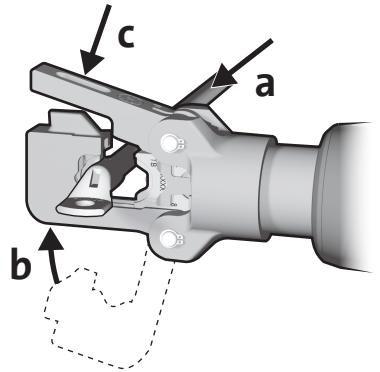

5 ↓

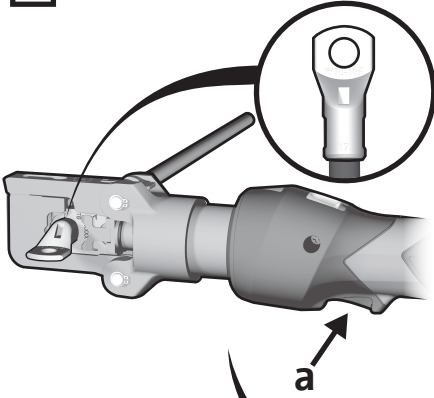

↓

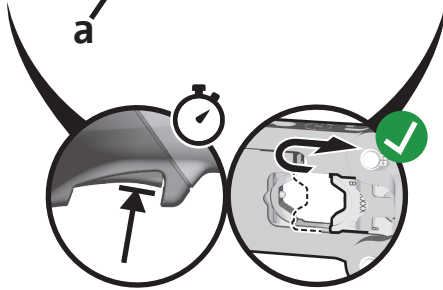
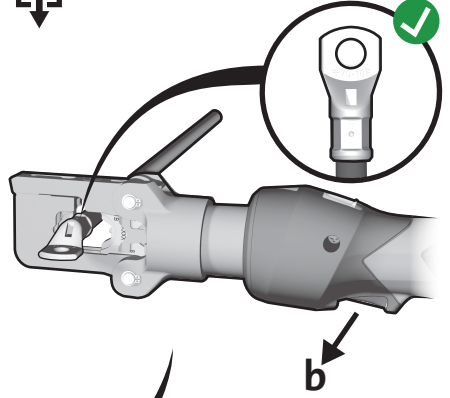

↓ MAN

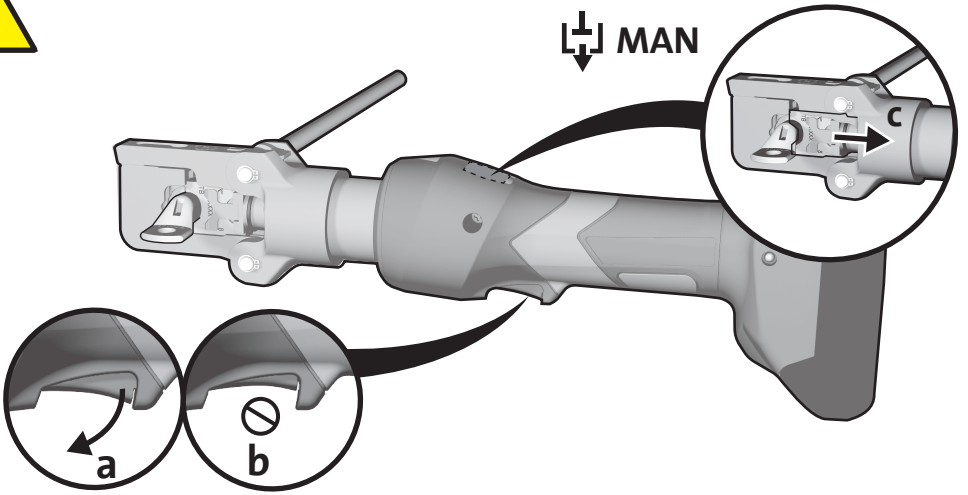

⊘ STOP

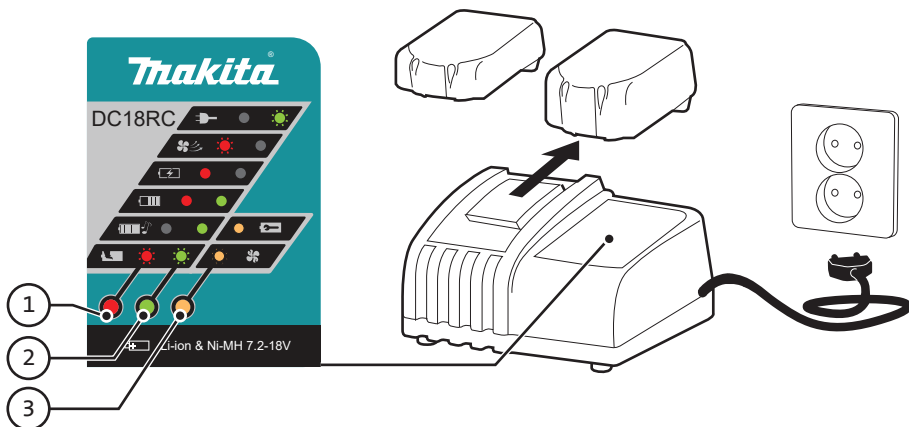
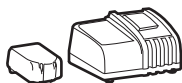

SE

| | | |
|-----|---------|---|
| ② | — — — — | Enheten är inkopplad och klar. |
| ① | - - - - | Batteriet är för varmt. Kylning före laddning. |
| ① | — | Batteriet laddar. Batteriet är mindre än 80% laddat. |
| ①/2 | — — | Batteriet laddar. Batteriet är mer än 80% laddat. |
| ② | — | Batteriet är fulladdat. |
| ①/2 | - - - - | Batteriet är trasigt. |
| ③ | — | Tillståndsbedömning för villkorsladdning, söker optimal laddning för batteriet. |
| ③ | - - - - | Avvikelse i batterikylning. |



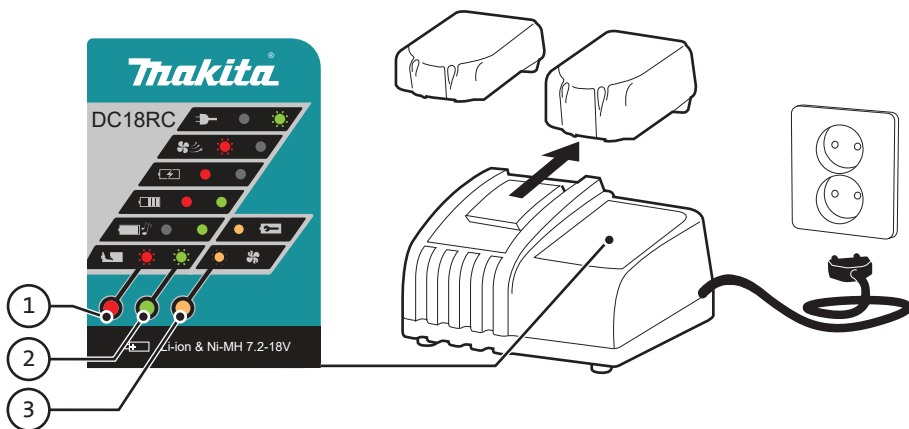

GB

| | | |
|-----|------------|--|
| ② | --- | Unit is plugged in and ready. |
| ① | --- | Battery is too warm. Cooling it before charging. |
| ① | — | Battery is charging. Battery is less than 80% charged. |
| ①/② | — — | Battery is charging. Battery is more than 80% charged. |
| ② | — | Battery is fully charged. |
| ①/② | --- --- | Battery is broken. |
| ③ | — | Battery is being conditioned. |
| ③ | --- | Battery cooling abnormality. |



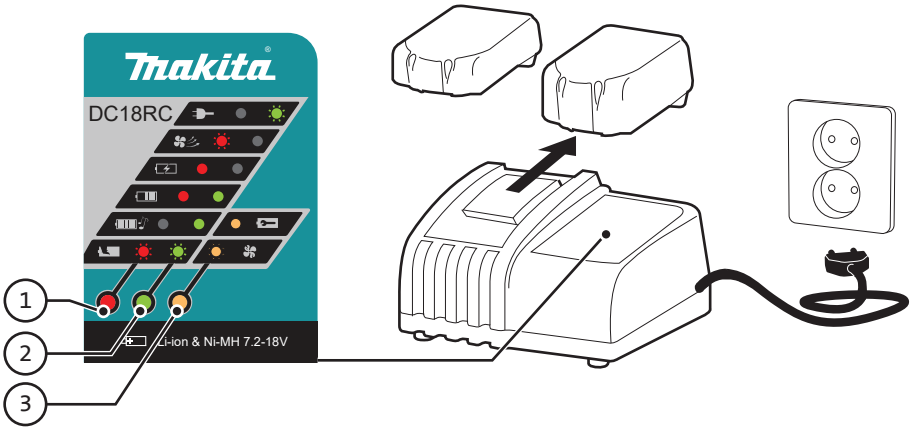
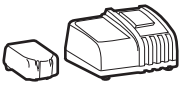

DE

| | | |
|-----|---------|--|
| ② | — — — — | Einheit ist angeschlossen und bereit. |
| ① | - - - - | Akku ist zu heiß. Vor Aufladen abkühlen lassen. |
| ① | — | Akku lädt. Akku ist weniger als 80 % aufgeladen. |
| ①/2 | — — | Akku lädt. Akku ist mehr als 80 % aufgeladen. |
| ② | — | Akku ist voll aufgeladen. |
| ①/2 | - - - - | Akku ist defekt. |
| ③ | — | Akku wird vorbereitet. |
| ③ | - - - - | Abweichung bei der Akkukühlung. |

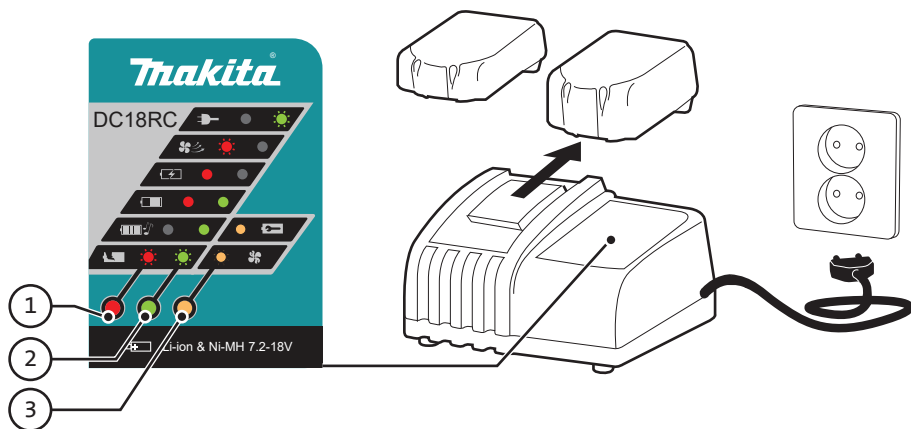
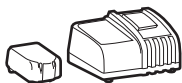

DK

| | | |
|-----|---------|---|
| 2 | --- | Enheden er tilsluttet og parat. |
| 1 | - - - - | Batteriet er for varmt. Det skal køle af før opladning. |
| 1 | — | Batteriet lades op. Batteriet er under 80 % opladet. |
| 1/2 | — — | Batteriet lades op. Batteriet er over 80 % opladet. |
| 2 | — — — | Batteri er fuldt opladet |
| 1/2 | - - - - | Batteriet er defekt. |
| 3 | — — — — | Batteriet undersøges. |
| 3 | - - - - | Batteriet køler ikke korrekt. |



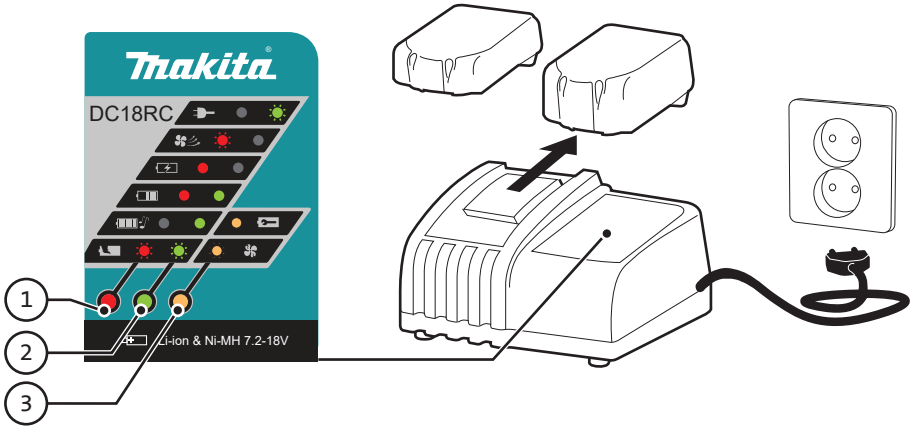
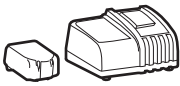

FI

| | | |
|-----|---------|---|
| ② | — — — — | Yksikkö on kytketty ja valmis. |
| ① | - - - - | Akku on liian kuuma. Anna sen jäähtyä ennen lataamista. |
| ① | — | Akku latautuu. Akun varaustaso on alle 80 %. |
| ①/2 | — — | Akku latautuu. Akun varaustaso on yli 80 %. |
| ② | — | Akku on ladattu täyteen. |
| ①/2 | - - - - | Akku on rikki. |
| ③ | — | Akkua valmistellaan. |
| ③ | - - - - | Poikkeama akun jäähtytyksessä. |





1

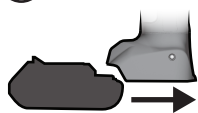

2

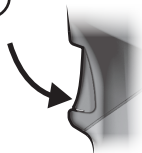

- 1 Säkring överström
- 2 Komparator överström
- 3 Kretskort överhettat
- 4 Batteri överhettat
- 5 Batteri urladdat, driftstopp
- 6 Defekt pressmotor i drift
- 7 Defekt pressmotor ej i drift
- 8 Batteri svagt
- 9 Batteri urladdat

- 10 RTC-batteri svagt
- 11 Verktyg avstängt
- 12 Service krävs
- 13 RTC hittades inte
- 14 BT-enhet hittades inte
- 15 Mobilenhet hittades inte
- 16 Trycksensor hittades inte
- 17 Bristningstryck överskridet
- 18 Batteritemperatur för låg

3

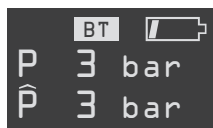
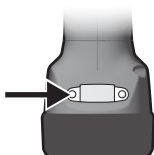

Bluetooth (om anslutet)
 Batteriets laddning
 Aktuellt tryck
 Tryck max

4_a

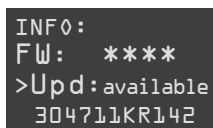
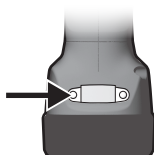

Firmware
 Firmwareuppdatering
 finns
 Serienummer

4_b

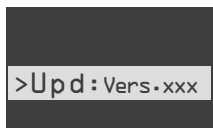
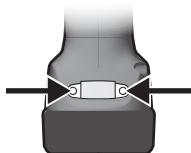

Om firmwareuppdatering
 finns

4_c

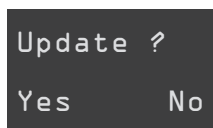
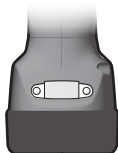

Tryck vänster för Ja
 Tryck höger för Nej

4_d

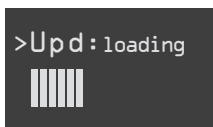
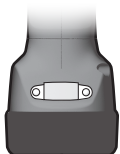

Uppdatering laddar...
 Ta inte ut batteriet!



4
e

Download
finished

Please reset

Återställ verktyget

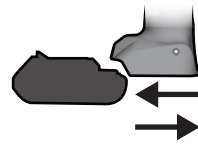

Ta ut batteriet
Sätt in batteriet

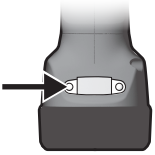
5
a

USER 3:
RD3 Doppelklick

Dubbelklick

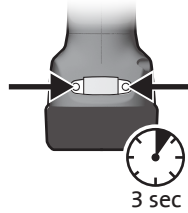
5
b

USER SELECT 3:
RD3 Einfachklick

Enkelklick
gå till meny

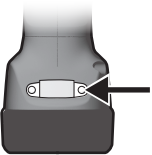
5
c

USER SELECT:
RD3 Doppelklick

Dubbelklick
Väl

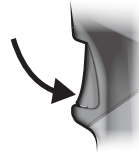
5
d

USER SELECT:
RD3 Doppelklick

Dubbelklick
Bekräftat

6

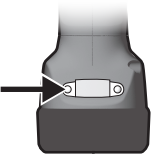

NEXT SERVICE:
9826 OP

Arbetscykler
(till nästa service)

7

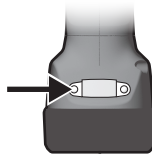

TOTAL:
t = 0.07
Q = 21.12
n = 174

Sedan tillverkning
Drifttimmar
Kapacitet
Pressningar

8

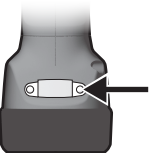

RETURN





1



2



- 1 Overcurrent fuse
- 2 Overcurrent comparator
- 3 Overheat board
- 4 Overheat battery
- 5 Battery empty, operation stop
- 6 Faulty crimp motor in operation
- 7 Faulty crimp motor not in operation
- 8 Low battery
- 9 Battery empty

- 10 RTC battery low
- 11 Tool deactivated
- 12 Service necessary
- 13 RTC not found
- 14 BT unit not found
- 15 Mobile unit not found
- 16 Pressure sensor not found
- 17 Burst pressure exceeded
- 18 Battery temperature too low

3

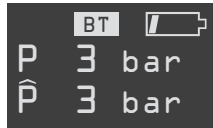
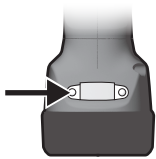

Bluetooth (if connected)
 Battery charging level
 Current pressure
 Pressure max.

4_a

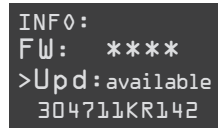
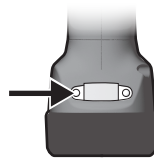

Firmware Available
 firmware-update
 Serialnumber

4_b

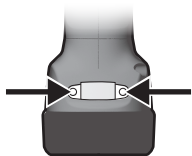

If firmware-update available

4_c

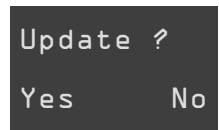

Press left for Yes
 Press right for No

4_d

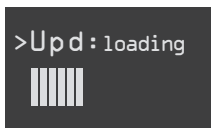
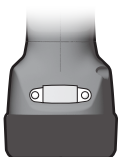

Update loading...
Don't remove battery!

4
e



Download finished
Please reset

Please reset tool

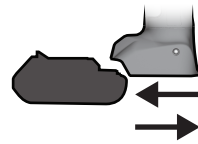

Remove battery
Insert battery

5
a

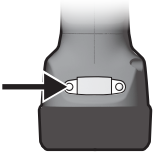

USER 3:
RD3 Doppelklick

Doubleclick

5
b

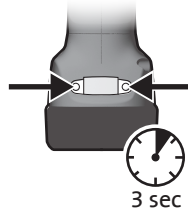

USER SELECT 3:
RD3 Einfachklick

Single click
enter menu

5
c

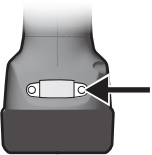

USER SELECT:
RD3 Doppelklick

Doubleclick
select

5
d

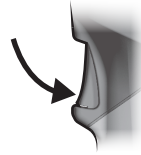

USER SELECT:
RD3 Doppelklick

Doubleclick
confirmed

6

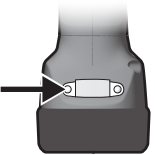

NEXT SERVICE:
9826 OP

Cycles
(until next service)

7

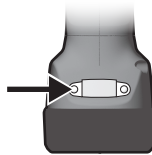

TOTAL:
t = 0.07
Q = 21.12
n = 174

Since manufacturing
Operating hours
Capacity
Crimps

8

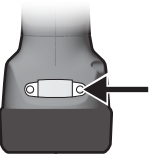

RETURN

1



2

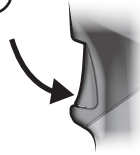

ERROR CODE:

- 1 Überstromsicherung
- 2 Überstromkomparator
- 3 Überhitzung Platine
- 4 Überhitzung Akku
- 5 Akku leer, Betrieb unterbrochen
- 6 Fehlerhafter Crimpantrieb in Betrieb
- 7 Fehlerhafter Crimpantrieb nicht in Betrieb
- 8 Niedriger Akkustand
- 9 Akku leer

- 10 RTC-Akku niedrig
- 11 Werkzeug ausgeschaltet
- 12 Service erforderlich
- 13 RTC nicht gefunden
- 14 BT-Einheit nicht gefunden
- 15 Mobileinheit nicht gefunden
- 16 Druckfühler nicht gefunden
- 17 Berstdruck überstiegen
- 18 Akkutemperatur zu niedrig

3

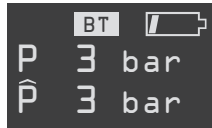
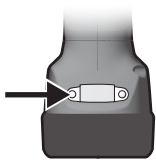

Bluetooth (falls verbunden)
Ladeniveau Akku
Ist-Druck
Druck max.

4_a

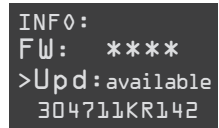
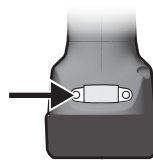

Firmware
Verfügbares
Firmware-Update
Seriennummer

4_b

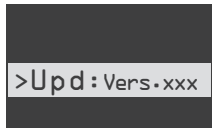
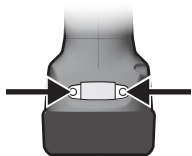

Falls Firmware-Update
verfügbar

4_c

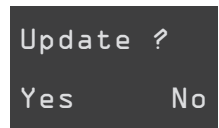
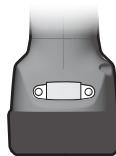

Links drücken für Ja
Rechts drücken für Nein

4_d

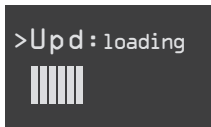
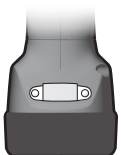

Update lädt...
Das Akku nicht herausnehmen!

4
e

Download
finished

Please reset

Werkzeug**bitte** zurücksetzen

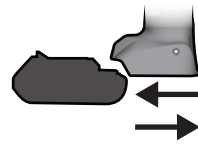

Akku herausnehmen
Akku einsetzen

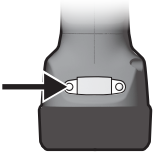
5
a

USER 3:
RD3 Doppelklick

Doppelklicken

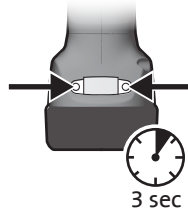
5
b

USER SELECT 3:
RD3 Einfachklick

Einklicken
Menü öffnen

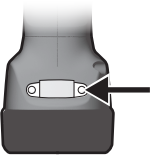
5
c

USER SELECT:
RD3 Doppelklick

Doppelklicken
auswählen

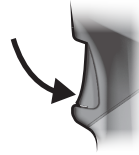
5
d

USER SELECT:
RD3 Doppelklick

Doppelklicken
bestätigt

6

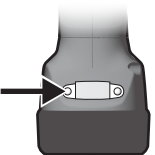

NEXT SERVICE:
9826 OP

Zyklen
(bis nächster Service)

7

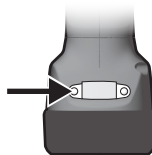

TOTAL:
t = 0.07
Q = 21.12
n = 174

Seit Herstellung
Betriebsstunden
Kapazität
Crimps

8

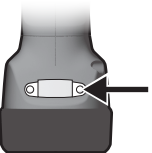

RETURN





1



2

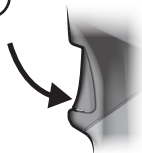

ERROR CODE:

- | | |
|--|--------------------------------|
| 1 Overstrømssikring | 10 CMOS-batteri lavt |
| 2 Overstrømsrelæ | 11 Værktøjet er deaktiveret |
| 3 CMOS overophedet | 12 Skal indsendes til eftersyn |
| 4 Batteri overophedet | 13 CMOS ikke fundet |
| 5 Batteri afladet, værktøjet deaktiveres | 14 Batteri ikke fundet |
| 6 Defekt krympemotor i brug | 15 #Mobilenhed ikke fundet |
| 7 Defekt krympemotor ikke i brug | 16 Tryksensor ikke fundet |
| 8 Lavt batteri | 17 Udløsningstryk overskredet |
| 9 Afladet batteri | 18 Batteriet er for koldt |

3

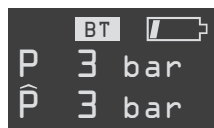
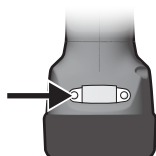

Bluetooth (hvis tilsluttet)
Oplad batteriet
Aktuelt tryk
Maksimalt tryk

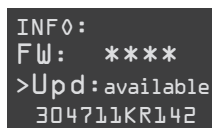
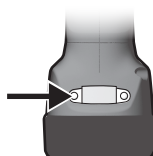
4_a

Firmware
Tilgængelig firmware-opdatering
Serienummer

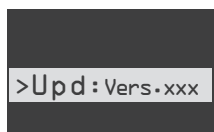
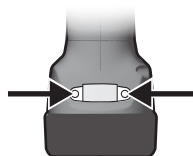
4_b

Hvis firmware-opdatering er tilgængelig

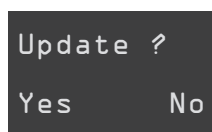
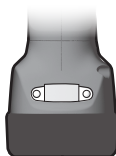
4_c

Tryk venstre for Ja
Tryk højre for Nej

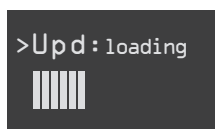
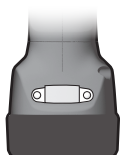
4_d

Opdatering indlæses ...
Batteriet må ikke fjernes!



4
e

Download
finished

Please reset

Nulstil værktøjet

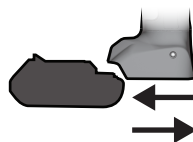

Tag batteriet ud
Sæt batteriet i

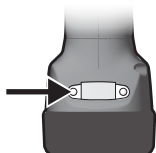
5
a

USER 3:
RD3 Doppelklick

Dobbeltklik

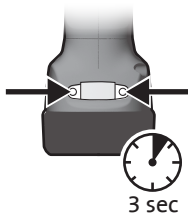
5
b

USER SELECT 3:
RD3 Einfachklick

Enkeltklik
åbn menu

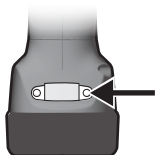
5
c

USER SELECT:
RD3 Doppelklick

Dobbeltklik
vælg

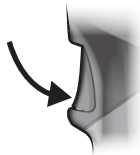
5
d

USER SELECT:
RD3 Doppelklick

Dobbeltklik
bekræftet

6

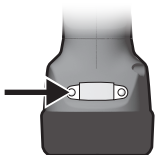

NEXT SERVICE:
9826 OP

Cykluser
(indtil næste eftersyn)

7

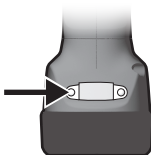

TOTAL:
t = 0.07
Q = 21.12
n = 174

Siden fremstilling
Driftstimer
Kapacitet
Krympninger

8

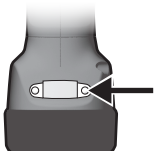

RETURN





1



2



ERROR CODE:

- 1 Ylivirtasuojia
- 2 Ylivirtakomparaattori
- 3 Ylikuumeneminen, levy
- 4 Ylikuumeneminen, akku
- 5 Akku tyhjä, toiminta pysäytetty
- 6 Viallinen puristusmoottori toiminnassa
- 7 Viallinen puristusmoottori ei toiminnassa
- 8 Akun varaustaso alhainen
- 9 Akku tyhjä

- 10 RTC-akun varaustaso tyhjä
- 11 Työkalu poistettu käytöstä
- 12 Huolto tarpeen
- 13 RTC:tä ei löytynyt
- 14 BT-yksikköä ei löytynyt
- 15 Mobiiliyksikköä ei löytynyt
- 16 Paineanturia ei löytänyt
- 17 Murtumispainetta ylitetty
- 18 Akun lämpötila liian alhainen

3

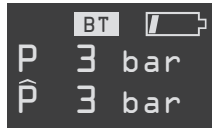
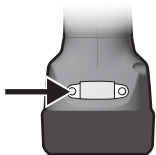

Bluetooth (jos yhdistetty)
Akun varaustaso
Nykyinen paine.
Paine enint.

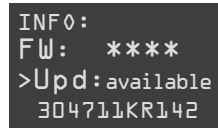
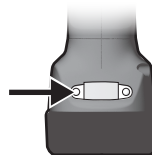
4_a

Laiteohjelmisto
Saatavilla oleva
laiteohjelmistopäivitys
Sarjanumero

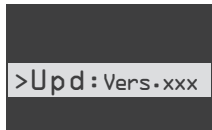
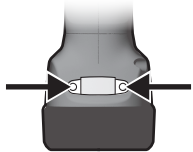
4_b

Jos laiteohjelmistopäivitys
saatavilla

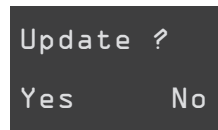
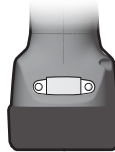
4_c

Hyväksy painamalla
vasemmalle
Hylkää painamalla oikealle

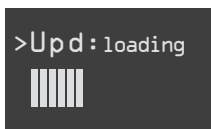
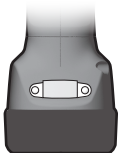
4_d

Päivitystä ladataan....
Älä irrota akkua!



4
e

Download
finished

Please reset

Käynnistä työkalu
uudelleen

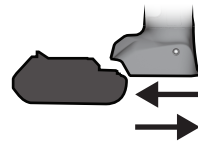

Poista akku
Aseta akku paikoilleen

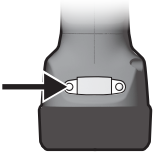
5
a

USER 3:
RD3 Doppelklick

Kaksoisnapsautus

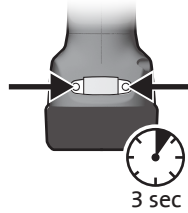
5
b

USER SELECT 3:
RD3 Einfachklick

Yksi napsautus
avaa valikko

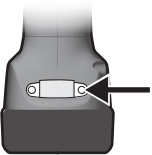
5
c

USER SELECT:
RD3 Doppelklick

Kaksoisnapsautus
valitse

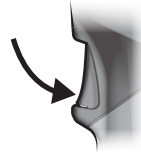
5
d

USER SELECT:
RD3 Doppelklick

Kaksoisnapsautus
hyväksyty

6

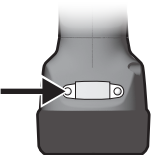

NEXT SERVICE:
9826 OP

Sykliä
(seuraavaan huoltoon)

7

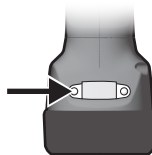

TOTAL:
t = 0.07
Q = 21.12
n = 174

Valmistamisesta lähtien
Käyttötunnit
Kapasiteetti
Puristuskerrat

8

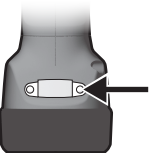

RETURN

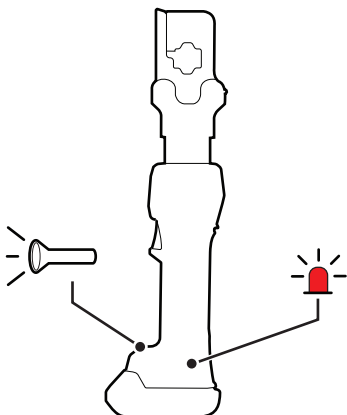

SE

- 1 När: Efter arbetscykel
Varför: Låg batterinivå.
- 2 När: Efter isättande av batteri
Varför: Självkontroll
- 3 När: Efter arbetscykel
Varför: Skicka för service.
- 4 När: Överstiger temp. gräns
Varför: Enheten är för varm.
- 5 När: Efter arbetscykel
Varför: Skicka för service.
- 6 När: Efter arbetscykel
Varför: Det presstryck som krävs har inte uppnåtts/operatören har avbrutit presscykeln manuellt medan motorn har stoppats.
- 7 När: Efter arbetscykel
Varför: Allvarligt fel, presstryck har INTE uppnåtts.

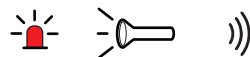

| | | | | |
|---|----------------------|-------------------|---------|-----|
| 1 | 20 sec | ———— | | |
| 2 | 2 x | - - - - | | |
| 3 | 20 sec/2Hz | - - - - - | | |
| 4 | 20 sec/5Hz | | | |
| 5 | 20 sec 20 sec/2Hz | ———— - - - - - | | |
| 6 | 1 x | - | - |))) |
| 7 | 3 x | - - - - | - - - - |))) |

GB

- When: After a work cycle
Why: Low battery level.
-
- When: After insertion of battery
Why: Self-inspection
-
- When: After a work cycle
Why: Send for service.
-
- When: Exceeds temp. limit
Why: Unit is too hot.
-
- When: After a work cycle
Why: Send for service.
-
- When: After a work cycle
Why: The crimping force required has not been achieved/operator has cancelled the crimping cycle manually while the motor has stopped.
-
- When: After a work cycle
Why: Serious fault, crimping force has NOT been achieved.



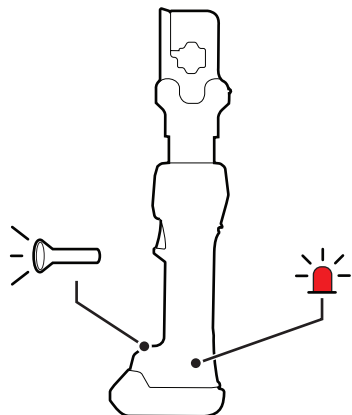

DE

- ① Wann: Nach Arbeitszyklus
Warum: Niedriger Akkustand.
- ② Wann: Nach dem Einlegen des Akkus
Warum: Selbstkontrolle
- ③ Wann: Nach Arbeitszyklus
Warum: Zum Service schicken.
- ④ Wann: Übersteigt Temp.- Grenzwert
Warum: Einheit ist zu heiß.
- ⑤ Wann: Nach Arbeitszyklus
Warum: Zum Service schicken.
- ⑥ Wann: Nach Arbeitszyklus
Warum: Der erforderliche Pressdruck wurde nicht erreicht/Der Bediener hat den Presszyklus manuell unterbrochen, während der Motor gestoppt wurde.
- ⑦ Wann: Nach Arbeitszyklus
Warum: Ernster Fehler, Pressdruck wurde NICHT erreicht.

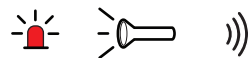

| | | | | |
|---|----------------------|-------------------|---------|-----|
| ① | 20 sec | ———— | | |
| ② | 2 x | - - - - | | |
| ③ | 20 sec/2Hz | - - - - - | | |
| ④ | 20 sec/5Hz | | | |
| ⑤ | 20 sec 20 sec/2Hz | ———— - - - - - | | |
| ⑥ | 1 x | - | - |))) |
| ⑦ | 3 x | - - - - | - - - - |))) |

DK

- Hvornår: Efter arbejdscyklus.
Hvorfor: Lavt batteriniveau.
- Hvornår: Efter isætning af batteri.
Hvorfor: Selvkontrol.
- Hvornår: Efter arbejdscyklus.
Hvorfor: Indsend til reparation.
- Hvornår: Overstiger temp.grænse.
Hvorfor: Enheden er for varm.
- Hvornår: Efter arbejdscyklus.
Hvorfor: Indsend til reparation.
- Hvornår: Efter arbejdscyklus.
Hvorfor: Det nødvendige presstryk er ikke nået, eller operatøren afbrød pressecyklussen manuelt, mens motoren var standset.
- Hvornår: Efter arbejdscyklus.
Hvorfor: Alvorlig fejl, presstrykket er ikke nået.



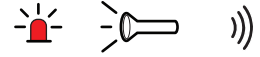
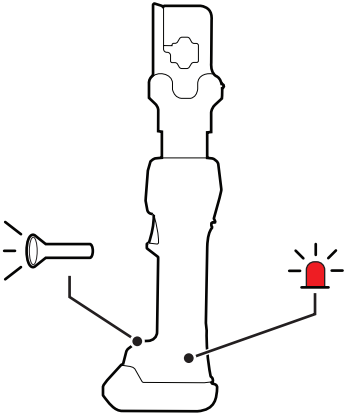

| | | | | |
|---|----------------------|--------------|-------|-----|
| ① | 20 sec | — | | |
| ② | 2 x | - - | | |
| ③ | 20 sec/2Hz | - - - - | | |
| ④ | 20 sec/5Hz | · · · · · | | |
| ⑤ | 20 sec 20 sec/2Hz | — - - - - | | |
| ⑥ | 1 x | - | - |))) |
| ⑦ | 3 x | - - - | - - - |))) |

FI

- ① Milloin: Työjakson jälkeen
Miksi: Akun varaustaso alhainen.
-
- ② Milloin: Akun asettamisen jälkeen
Miksi: Itsetarkastus
-
- ③ Milloin: Työjakson jälkeen
Miksi: Lähetä huoltoon.
-
- ④ Milloin: Ylittää lämpötilarajan
Miksi: Laite on liian lämmin.
-
- ⑤ Milloin: Työjakson jälkeen
Miksi: Lähetä huoltoon.
-
- ⑥ Milloin: Työjakson jälkeen
Miksi: Tarvittavaa puristuspainetta ei saavutettu / käyttäjä on keskeyttänyt puristusjakson manuaalisesti ja moottori on pysäytetty.
-
- ⑦ Milloin: Työjakson jälkeen
Miksi: Vakava virhe, puristuspainetta EI ole saavutettu.