

GATE SUPPORT PRT PG

Universal gate supports PRT are used as gate or intermediate supports for cable ladders, cable trays and wire mesh trays. Can be mounted to the ceiling with one or two threaded rods GT, depending on loading division and width of cable ladders or -trays.

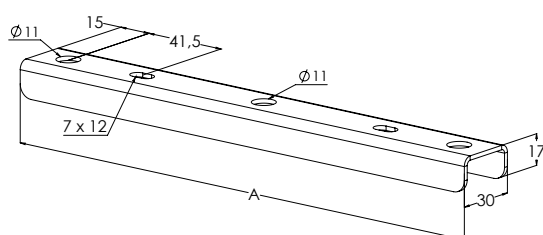

CODE	PRODUCT x = stock product	WGT. kg / pc	A mm	PACKAGE
1449970	x PRT-200 PG	0.21	250	20 PCE
1449971	x PRT-300 PG	0.3	350	20 PCE
1449972	x PRT-400 PG	0.38	450	20 PCE
1449973	x PRT-500 PG	0.47	550	20 PCE
1449974	x PRT-600 PG	0.56	650	20 PCE

PG Manufactured of hot-dip galvanized steel in accordance with standard EN 10346 : C1-C2

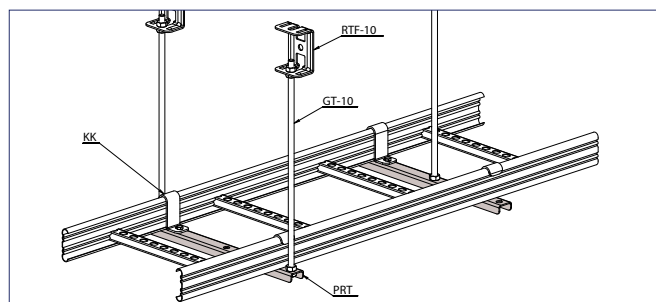

The cable ladder is attached to gate support PRT with bracket KK. Gate support PRT is attached to threaded rod GT-10 with nuts MU M10.

WALL BRACKET VK2 PG HDG HST

Wall brackets VK2 are used to mount KS-type cable ladders to wall, ceiling or floor.



The HST product differs in appearance from the PG and HDG products.

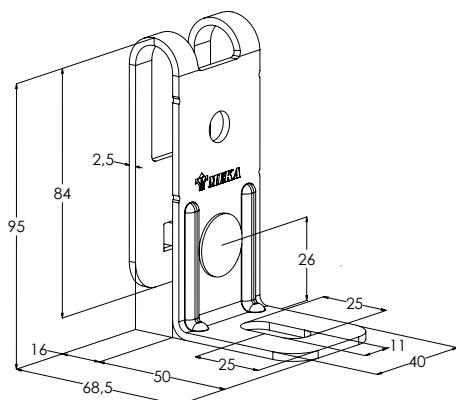

CODE	PRODUCT x = stock product	WGT. kg / pc	PACKAGE
1449479	x VK2 PG	0.23	10 PCE

PG Manufactured of hot-dip galvanized steel in accordance with standard EN 10346 : C1-C2

Product includes screw set: 1449112 RS VK2 HDG (1 PCE)

CODE	PRODUCT x = stock product	WGT. kg / pc	PACKAGE
1449671	x VK2 HDG	0.24	10 PCE

HDG Hot-dip galvanized after manufacturing in accordance with standard EN ISO 1461: C1-C4

Product includes screw set: 1449112 RS VK2 HDG (1 PCE)

CODE	PRODUCT x = stock product	WGT. kg / pc	PACKAGE
1430303	x HST VK2	0.22	10 PCE

HST Acid-proof steel : C1-CX

Product includes screw set: 1430432 HST RS VK2 (1 PCE)

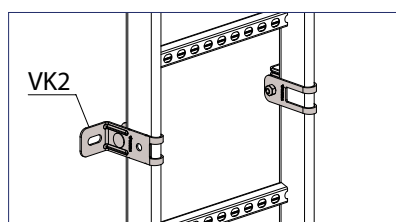

Cable ladders are attached to the walls with wall bracket VK2. When using VK2, the gap between the cable ladder and wall is 32mm.

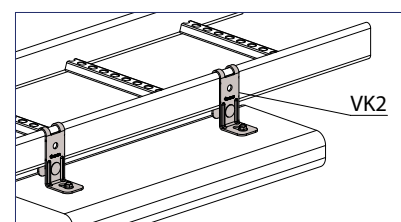

Luminaires are attached to the cable ladder with wall bracket VK2.