

## ADJUSTABLE INTERMEDIATE SUPPORT MEK RPF

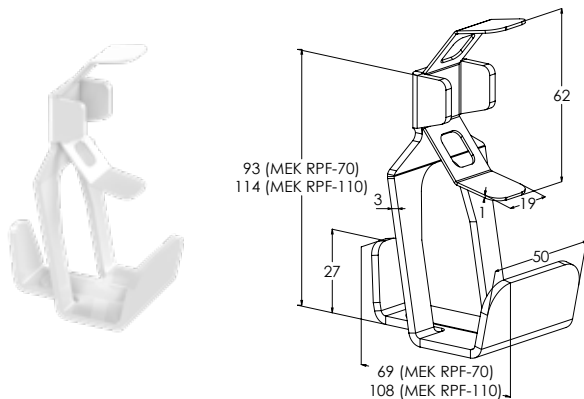

Adjustable intermediate supports MEK RPF are used to support MEK-type lighting support rails into ceiling from inside with 8 or 10 mm threaded rods GT.



CODE	PRODUCT x = stock product	WGT. kg / pc	LOADING max. kg	PACKAGE
1449345	x MEK RPF-70-8 PG	0.16	50	10 PCE
1449337	x MEK RPF-70-10 PG	0.16	50	10 PCE
1449350	MEK RPF-110-8 PG	0.2	60	10 PCE
1449343	x MEK RPF-110-10 PG	0.2	60	10 PCE
PG	Manufactured of hot-dip galvanized steel in accordance with standard EN 10346 : C1-C2			

CODE	PRODUCT x = stock product	WGT. kg / pc	LOADING max. kg	PACKAGE
1449338	x MEK RPF-70-10 M	0.16	50	10 PCE
1449344	MEK RPF-110-10 M	0.2	60	10 PCE
M	White RAL 9010 polyester paint coating : C1-C2			

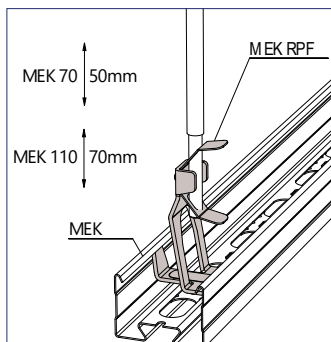

The RPF suspension is quick to install and adjustable. The threaded rod is attached to the ceiling with either ceiling bracket RTF-10 or another, appropriate method, such as an expansion bolt.

## INTERMEDIATE SUPPORT MEK RK



Intermediate supports MEK RK are used to support MEK-type lighting support rails into ceiling from inside with threaded rods GT.

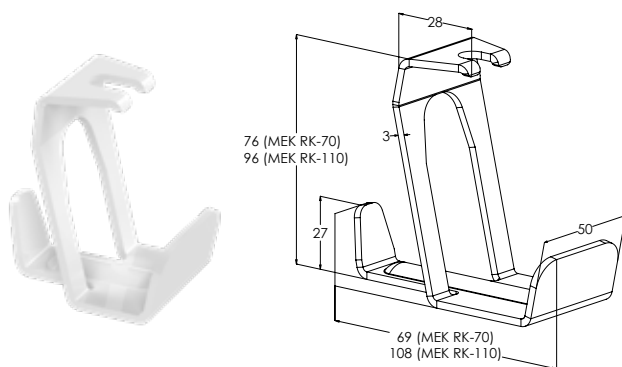

CODE	PRODUCT x = stock product	WGT. kg / pc	LOADING max. kg	PACKAGE
1449356	x MEK RK-70 PG	0.15	50	10 PCE
1449357	x MEK RK-110 PG	0.19	60	10 PCE
PG	Manufactured of hot-dip galvanized steel in accordance with standard EN 10346 : C1-C2			

CODE	PRODUCT x = stock product	WGT. kg / pc	LOADING max. kg	PACKAGE
1429153	x MEK RK-70 HDG	0.16	50	10 PCE
HDG	Hot-dip galvanized after manufacturing in accordance with standard EN ISO 1461 : C1-C4			

CODE	PRODUCT x = stock product	WGT. kg / pc	LOADING max. kg	PACKAGE
1430582	HST MEK RK-70	0.15	60	10 PCE
HST	Acid-proof steel : C1-CX			

CODE	PRODUCT x = stock product	WGT. kg / pc	LOADING max. kg	PACKAGE
1449389	x MEK RK-70 M	0.15	50	10 PCE
1449390	x MEK RK-110 M	0.2	60	10 PCE
M	White RAL 9010 polyester paint coating : C1-C2			

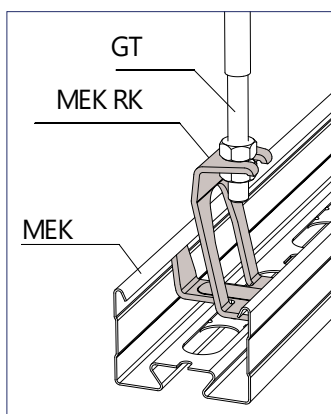

MEK RK is attached to threaded rod GT-10 with two M10 nuts. The threaded rod is attached to the ceiling with either ceiling bracket RTF-10 or another, appropriate method, such as an expansion bolt. Once the ceiling suspension is in place, the lighting support rail can be installed to the intermediate support.