

# Slide-in coupling

# SNPU

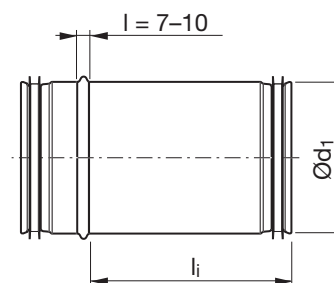

## Dimensions



## Description

### Areas of use:

- To eliminate the accurate length cutting of ducts which the ordinary NPU connector sometimes requires when joining SR ducts. In this case the slide-in coupling shall be secured with screws or pop rivets.
- To make it possible to use a duct that is cut to a too short length – instead of having to cut a new duct to the correct length. In this case the slide-in coupling shall be secured with screws or pop rivets.
- To assist when joining two ducts which run towards each other. E.g. when building a system from two opposing directions. In this case the slide-in coupling shall be secured with screws or pop rivets.
- To assist when inserting or adding an other product into an existing system. E.g. the addition of a new piece of duct to replace a damaged part. In this case the slide-in coupling shall be secured with screws or pop rivets.
- To facilitate access when inspecting and/or cleaning a system – by simply sliding the coupling. The coupling acts as an access cap. Lindab do not recommend this use of larger dimensions than Ø315.

No Click function – has closed turned-over ends (at both ends).

Ød <sub>1</sub> nom	L nom	l <sub>i</sub> [mm]	m [kg]
80	150	133	0,18
80	300	284	0,32
80	500	548	0,69
100	150	133	0,22
100	300	284	0,40
100	500	548	0,84
112	150	133	0,24
112	300	284	0,43
112	500	548	0,92
125	150	133	0,28
125	300	284	0,50
125	500	548	1,07
140	150	133	0,31
140	300	284	0,56
140	500	548	1,19
150	150	133	0,33
150	300	284	0,59
150	500	548	1,26
160	150	133	0,36
160	300	284	0,65
160	500	548	1,38
180	150	133	0,40
180	300	284	0,72
180	500	548	1,53
200	150	133	0,56
200	300	293	1,02
200	500	548	1,76
224	150	133	0,62
224	300	293	1,13
224	500	548	1,95
250	150	177	0,91
250	300	297	1,35
250	500	527	2,17
280	150	177	1,02
280	300	297	1,50

## Ordering example

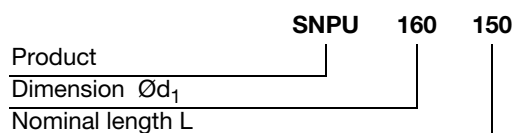

## Slide-in coupling

## SNPU

$\text{\O}d_1$ nom	L nom	$l_1$ [mm]	m [kg]
280	500	527	2,41
300	150	177	1,12
300	300	297	1,63
300	500	527	2,61
315	150	177	1,18
315	300	297	1,72
315	500	527	2,76
355	150	177	1,32
355	300	297	1,94
355	500	527	2,93
400	150	175	2,11
400	300	297	2,80
400	500	510	3,10
450	150	175	2,37
450	300	297	3,10
450	500	510	3,80
500	150	175	2,65
500	300	297	3,70
500	500	515	4,50
630	150	175	3,40
630	300	297	4,70
630	500	515	6,00
800 **	500	515	10,9
1000 **	500	515	14,0
1250 **	500	515	17,5

\*\* Design with lockseam