

VALVE DESIGN FROM DN-50 TO DN-300 (2" TO 12")

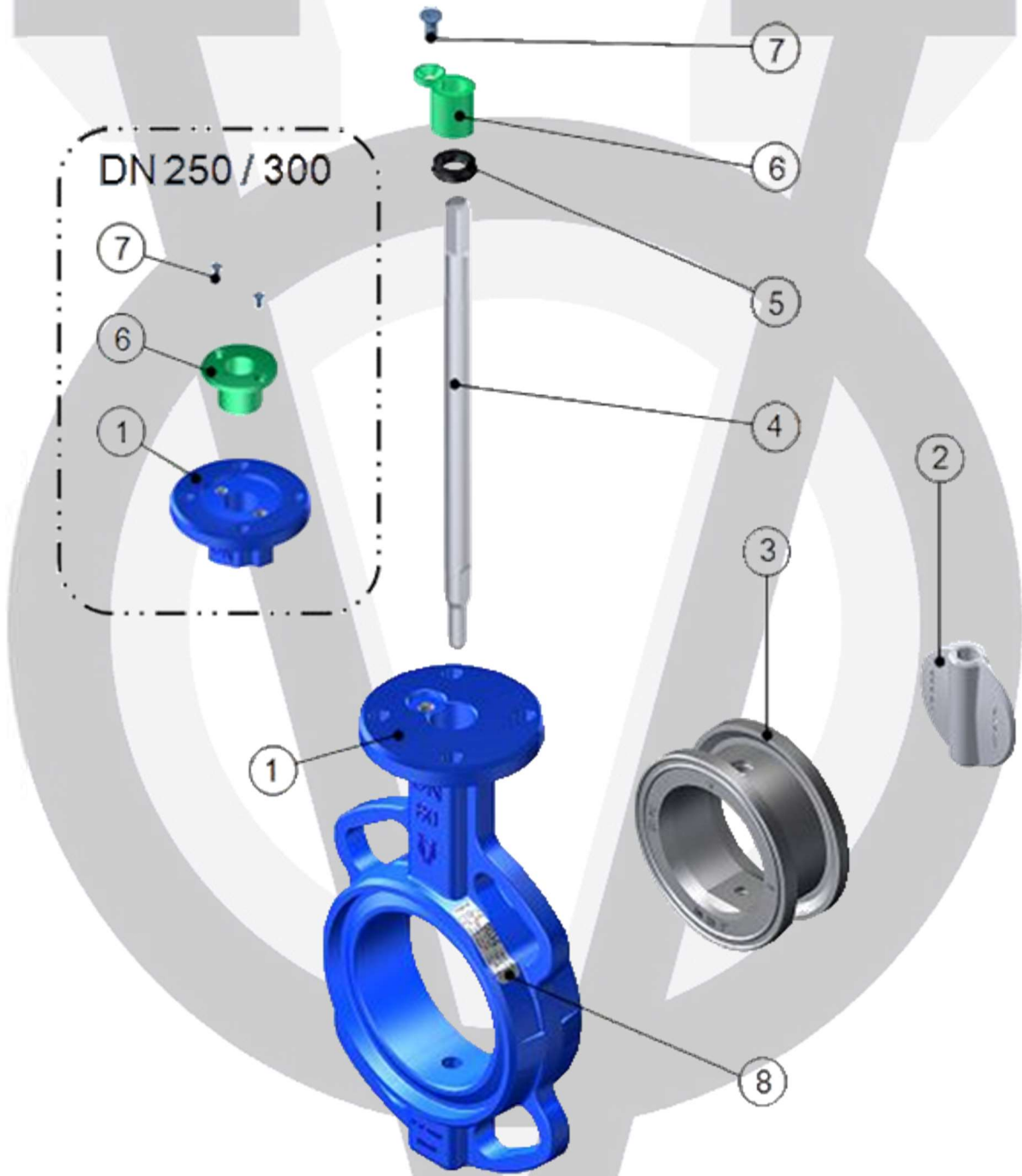

| ITEM | DESCRIPTION | MATERIALS | QUANTITY |
|------|---|-----------------|----------|
| 1 | BODY | ON REQUEST | 1 |
| 2 | DISC | ON REQUEST | 1 |
| 3 | SEAT | ON REQUEST | 1 |
| 4 | SHAFT | STAINLESS STEEL | 1 |
| 5 | CHEVRON SEAL | BUNA-N | 1 |
| 6 | RETENTION BUSHING | NYLON-6 | 1 |
| 7 | BOLT FOR RETENTION BUSHING (DIN - 7991) | STAINLESS STEEL | (*) |
| 8 | LABEL WITH FEATURES | PVC | 1 |

(*) Up to DN-200, quantity 1. For DN-250 and DN-300, quantity 2.