

„TOLEDOSENS“ LED FLOODLIGHT WITH MICROWAVE SENSOR

Model No: TOLEDOSENS_10W_LED_900 Article: 6008100001 TOLEDOSENS_70W_LED_900 Article: 6008100020
 TOLEDOSENS_20W_LED_1800 6008100002 TOLEDOSENS_100W_LED_900 Article: 6008100021
 TOLEDOSENS_30W_LED_2700 6008100003
 TOLEDOSENS_50W_LED_4500 6008100004



EN

Instalation & Operating Instruction

1. Designated Use

- TOLEDOSENS floodlights are an outdoor floodlights equipped with microwave motion detector for automatic LED lighting control.
- Mainly for wall installation
- Simply plug in wall plate for easy and sade connection
- Suitable for a wide range of locations: corridors, gardens, staircases, entrances, garages, outdoor parking areas etc.

! WARNING

2. Basic Safety Instruction

Danger of death through electric shock

- Must only be installed by qualified electricians.
- Avoid the metal parts of the device due to potentially high temperature.
- Conforms to the latest EC directives.
- Designed for use in normal environments.

3. Connection:

Connect the cable to the terminal block as follows (see connection diagram): Ensure the connections are secure.

L	LIVE	BLACK
N	NEUTRAL	BLACK
E	EARTH	GREEN/YELLOW

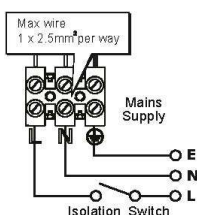

IMPORTANT

Switch off the electricity at the fuse box by removing the relevant fuse or switching off the circuit breaker before proceeding with the installation

4. Instalation Procedure:

1. Switch off the power.



2. Marking the screw hole

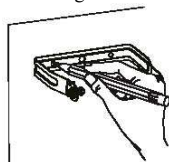

3. Drill and push the screw peg into the hole

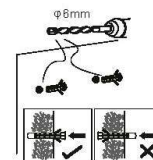

4. Fix the U bracket to the wall

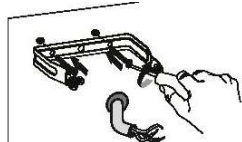

Mounting Screws: (M4 x 32mm) x 2

5. Attach the device to the U bracket and tighten the screws.

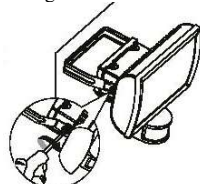

6. Connect device to the mains.

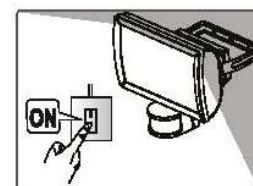

5. Instalation Advise:

⚠ WARNING

As the detector reacts to variations in temperature, avoid situations:

- Do not direct motion detectors at objects with highly-reflective surface
- Do not install motion detectors near heat sources such as heating outlets, air conditioning system, lamps etc.
- Do not direct the motion detector at big objects that move in the wind such as curtains, large plants etc.

6. Detection Range

Recomended instalation height is 1,5 – 3,5 meter above ground, the maximum detection range about 8 meter at the angle of about 180 deg.

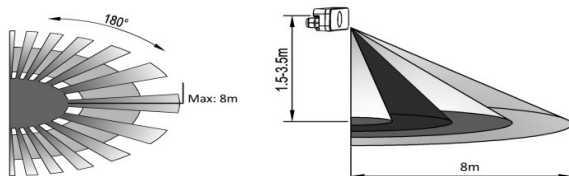

7. Walk test and adjustment

The purpose of Walk Test is used to test and adjust the detection coverage of Microwave sensor under auto mode.

- Slide up all the knobs, detection range (100%), hold time (5s) and daylight sensor (2000lux). When you switch on the power, the light will be on at once. And 5sec later the light will be off automatically. Then if the sensor receives induction signal again, it can work normally.
- When the sensor receives the second induction signals within the first induction, it will restart to time from the moment.
- Slide down Daylight Sensor knob (25LUX). If the ambient light is less than 25LUX, the inductor load could work when it receives induction signal.

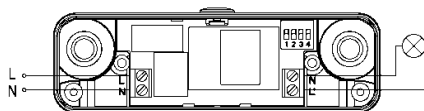
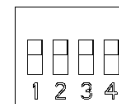

	Detection Range	Hold Time	Daylight Sensor
I	100%	I 5S	I 2000lux
II	50%	II 90S	II 25Lux
III		III 3min	
IV		IV 20min	

Note: when testing in daylight, please turn LUX knob 4 to 25Lux position, otherwise the sensor lamp could not work!

Technical specification

Energy Efficiency	Class A+
Energy Usage Lamp On	TOLEDOSENS_10W_LED_900 - 10 kW/1000h TOLEDOSENS_20W_LED_1800 - 20 kW/1000h TOLEDOSENS_30W_LED_2700 - 30 kW/1000h TOLEDOSENS_50W_LED_4500 - 50 kW/1000h
Power Supply	220-240V 50Hz
Power Factor	>0.95
Colour Temperature	4000K
Colour Rendering Index	>80
Lumen Output Initial	TOLEDOSENS_10W_LED_900 - 850 lm TOLEDOSENS_20W_LED_1800 - 1690 lm TOLEDOSENS_30W_LED_2700 - 2480 lm TOLEDOSENS_50W_LED_4500 - 4040 lm TOLEDOSENS_70W_LED_4501 - 6078 lm TOLEDOSENS_100W_LED_4502 - 8764 lm
Detection Range	Up to 8 meters
Detection Angle	180°
Lamp beam angle	110x100 degrees
Time On Adjustment	5seconds to 20 minutes
Dusk Level Adjustment	Day & night or night only operation
Environmental Protection	IP65 (suitable for indoor and outdoor use)
EC Directives	Conforms to current EC Directives

