

„LAGOS“ IP65 WATERPROOF LED LUMINAIRE



Model No. LAGOS100_18W_LED_1800, Article 6007000002
 Model No. LAGOS100_36W_LED_3600, Article 6007000003
 Model No. LAGOS100_70W_LED_7000, Article 6007000004

EN

Instalation & Operating Instruction

1. Designated Use

- LAGOS LED luminaire are an indoor or outdoor use, IP65 dustproof and waterproof, IK08 protected against mechanical impacts luminaire.
- Suitable for a wide range of locations: parking lots, garages, warehouses, production facilities, shed's etc.

⚠ WARNING

2. Basic Safety Instruction

Danger of death through electric shock

- Must only be installed by qualified electricians.
- Conforms to the latest EC directives.
- Designed for use in normal environments.

IMPORTANT

Switch off the electricity at the fuse box by removing the relevant fuse or switching off the circuit breaker before proceeding with the installation

3. Installation Procedure:

1. Switch off the power.

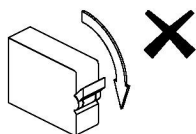

2. From package take two springs



3. Use 4 screws to fix springs to the wall or ceiling



4. Fix luminaire in to springs.

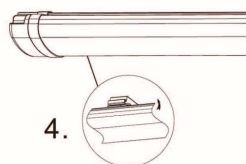

5. Connect power wire to waterproof terminal box

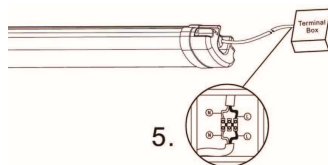

6. Switch on the power

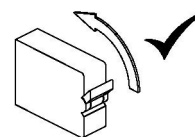

Technical specification

Energy Efficiency	Class A+
Power Supply	220-240V 50Hz
Power Factor	>0.90
Colour Temperature	4000K
Colour Rendering Index	>70
Lumen Output Initial	LAGOS100_18W_LED_1800 - 1678 lm LAGOS100_36W_LED_3600 - 3500 lm LAGOS100_70W_LED_7000 - 6711 lm
Lamp beam angle	110-120 degrees
Environmental Protection	IP65
Protection against mechanical impacts	IK08
EC Directives	Conforms to current EC Directives
Warranty	36 Months